

SURVEYED _____
 PLOTTED _____
 NOTE BOOK _____
 AREAS CHECKED _____
 NO. _____

SURVEYED _____
 PLOTTED _____
 NOTE BOOK _____
 AREAS CHECKED _____
 NO. _____

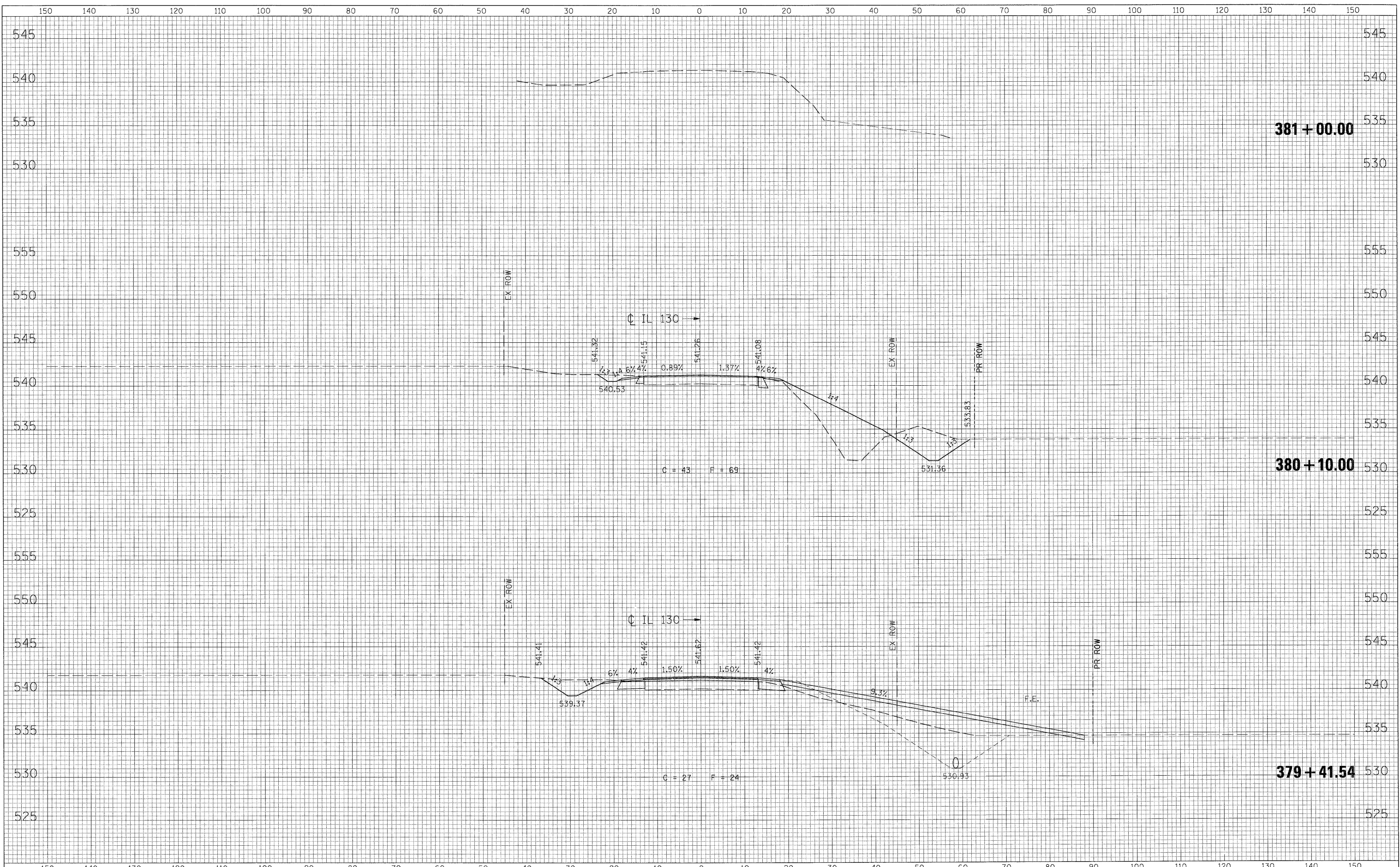

FILE NAME = G:\505026-7\CADD Sheets\0774236-sht-XSht.dgn	USER NAME = JE Consultants	DESIGNED -	REVISED -	STATE OF ILLINOIS DEPARTMENT OF TRANSPORTATION	CROSS SECTIONS - IL ROUTE 130			F.A.P. RTE. 116	SECTION (112BR1)B	COUNTY CUMBERLAND	TOTAL SHEETS 72	SHEET NO. 72
	PLOT SCALE = 1/8" = 100' IN.	DRAWN -	REVISED -		SCALE:	SHEET NO.	OF	SHEETS	STA. 379+41.54	TO STA. 381+00.00	CONTRACT NO. 74236	
	PLOT DATE = 8/13/2009	CHECKED -	REVISED -		[ILLINOIS] FED. AID PROJECT							
		DATE -	REVISED -									