

7/16"  $\phi$  holes at 4'-0" cts. for 3/8"  $\phi$  bolts. All bolts shall be burned, sawed, or chipped off flush with the plates after forms are removed, typ.

Place 1/2"  $\pm$  x 6" granular or solid flux filled headed studs conforming to Article 1006.32 of the Std. Specs., automatically end welded at 1'-0" alt. cts.

SECTION THRU STRIP SEAL JOINT

**Notes:**  
 The strip seal shall be made continuous and shall have a minimum thickness of 1/4". The configuration of the strip seal shall match the configuration of the Locking Edge Rails.  
 The height and thickness of the Locking Edge Rails shown are minimum dimensions. The actual configuration of the Locking Edge Rails and matching strip seal may vary from manufacturer to manufacturer. Flanged edge rails will not be allowed.  
 The inside of the Locking Edge Rail groove shall be free of weld residue.  
 Locking Edge Rails may be spliced at slope discontinuities and stage construction joints.  
 The manufacturer's recommended installation methods shall be followed.  
 Maximum space between rail segments at stage lines shall be 3/16", sealed with a suitable sealant.  
 All steel components shall be galvanized after fabrication according to Article 520.03 of the Standard Specifications.

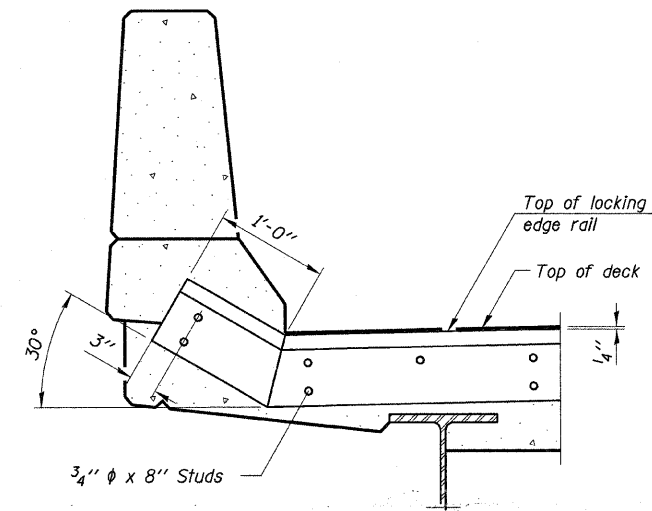

AT PARAPET

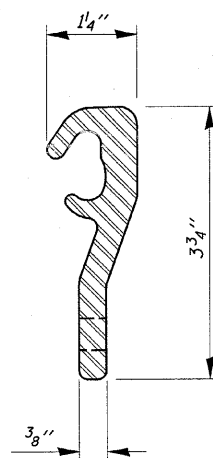

LOCKING EDGE RAIL

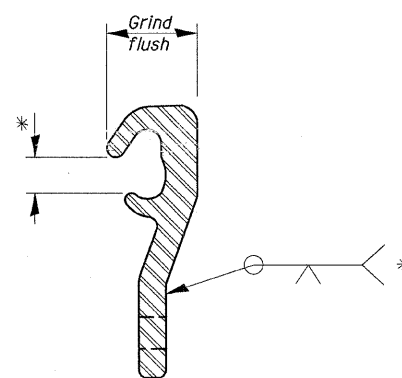

LOCKING EDGE RAIL SPLICE

\* Omit weld at seal opening.

BILL OF MATERIAL

SN	Item	Unit	Total
025-0079	Preformed Joint Strip Seal	Foot	42

FILE NAME =	USER NAME = swartzn	DESIGNED - MEA	REVISED -	<b>STATE OF ILLINOIS DEPARTMENT OF TRANSPORTATION</b>	<b>SHALLOW PREFORMED JOINT STRIP SEAL S.N. 025-0079</b>		F.A.S. RTE. 2796	SECTION (L,K)RS-2	COUNTY EFFINGHAM	TOTAL SHEETS 58	SHEET NO. 50	
es:\pw_work\pwwork\swartzn\dms54418\d774317-brgdetails-0250079.dgn	PLOT SCALE = 20.0000 / / IN.	DRAWN - MEA	REVISED -		SCALE: NA	SHEET NO. 6 OF 15 SHEETS	STA. TO STA.	CONTRACT NO. 74317				
	PLOT DATE = 3/18/2018	CHECKED -	REVISED -		ILLINOIS FED. AID PROJECT							
		DATE -	REVISED -									