

T.C.B
 TRAFFIC FLOW ARROW
 WORK ZONE
 TYPE II BARRICADES, DRUMS, OR VERTICAL BARRICADES W/ STEADY BURN MONODIRECTIONAL LIGHT (TYP.)

NOTE: REFERENCES TO YELLOW AND WHITE MEAN WET REFLECTIVE STAGING PAVEMENT MARKING TAPE, TYPE III. REMOVE ALL EXISTING PAVEMENT MARKINGS AND RAISED REFLECTIVE PAVEMENT MARKERS OR RAISED REFLECTIVE PAVEMENT REFLECTORS IN CONFLICT WITH PROPOSED STAGING PAVEMENT MARKINGS PER ENGINEER. SEE SCHEDULES FOR LIMITS OF RRPV AND RRPV REFLECTOR REMOVAL.

TYPE II BARRICADES
 END STA. 254+40.79
 4" WHITE
 END STA. 254+40.79
 4" YELLOW
 END STA. 254+40.79

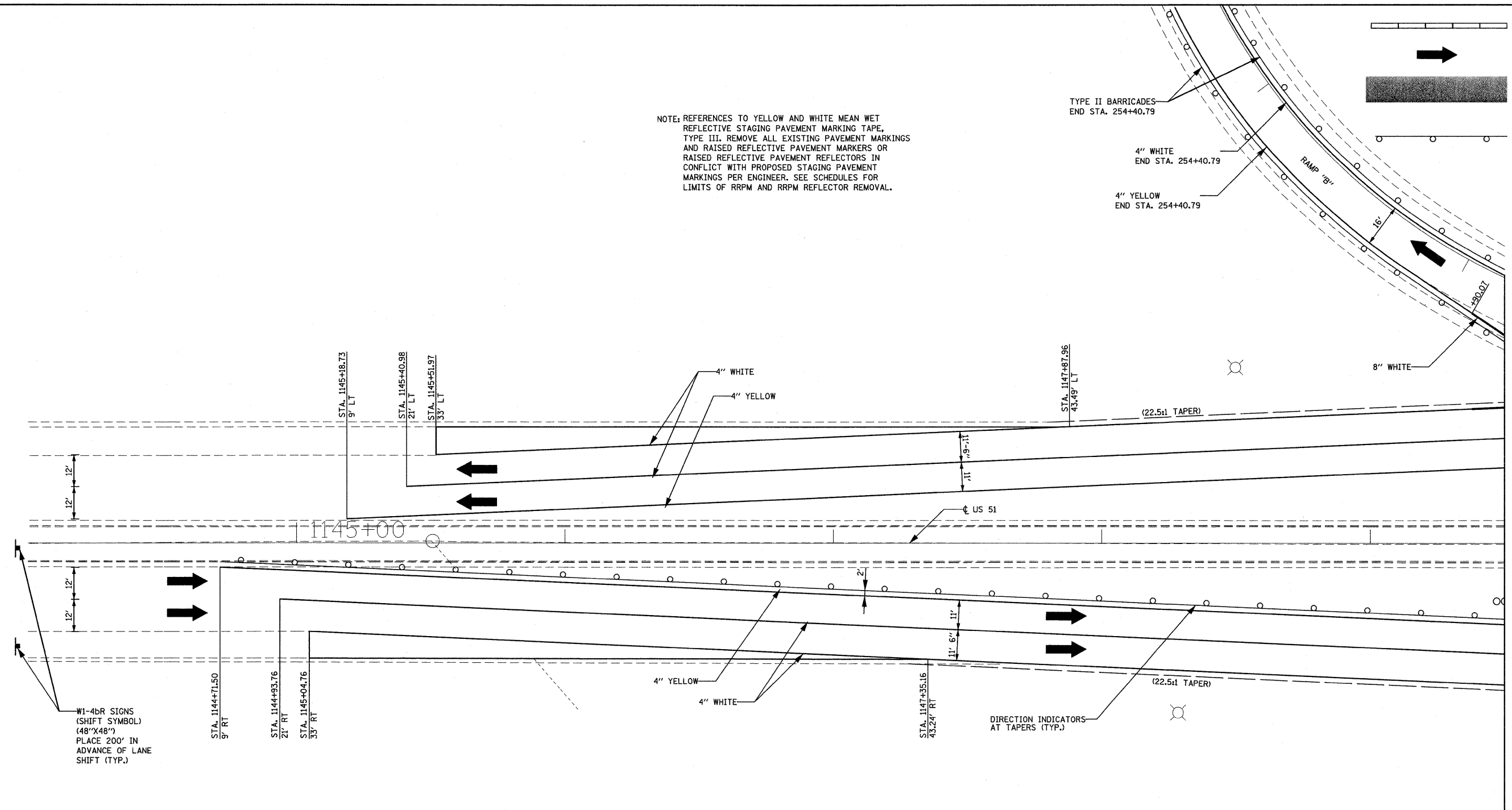

MATCHLINE STA. 1149+50.00

W1-4bR SIGNS (SHIFT SYMBOL) (48"X48") PLACE 200' IN ADVANCE OF LANE SHIFT (TYP.)

- NOTE: 1. FOR BOTH NORTHBOUND AND SOUTHBOUND LANES, ON BOTH THE SHOULDER AND THE MEDIAN, PLACE "ROAD CONSTRUCTION 1 MILE", 1 MILE IN ADVANCE OF WORK ZONE. PLACE WORK ZONE SPEED LIMIT SIGNAGE 500' IN ADVANCE OF WORK ZONE. PLACE "END WORK ZONE" SIGNAGE BEYOND PROJECT LIMITS.
- CONSTRUCT TEMPORARY RAMPS NEAR BRIDGE PRIOR TO STAGE II.
 - ANY ADDITIONAL SIGNAGE REQUIRED FOR STAGE II OF CONSTRUCTION THAT REQUIRE LANE OR SHOULDER CLOSURES OR DETOURS AND AS SHOWN ON PLANS SHALL BE INCLUDED IN THE LUMP SUM PAY ITEM OF TRAFFIC CONTROL AND PROTECTION - STAGE II.
 - STANDARD 701411 SHALL BE USED ON LOOP RAMPS FOR TRAFFIC CONTROL.
 - TRAFFIC CONTROL SIGNS SHALL BE PLACED ON BOTH LEFT AND RIGHT SIDE OF PAVEMENT
 - ALL BARRIER WALL MARKERS SHALL BE PLACED PER LINEAR DELINEATION PANELS SPECIFICATIONS UNLESS OTHERWISE SPECIFIED BY THE ENGINEER. SEE SPECIAL PROVISIONS FOR MORE INFORMATION.
 - ALL TRAFFIC CONTROL DEVICES SHALL BE IN ACCORDANCE WITH STANDARD 701901.
 - CONTRACTOR TO MATCH PROPOSED PAVEMENT MARKING INTO THE EXISTING PAVEMENT MARKING AT EACH CORRESPONDING BEGINNING AND ENDING LOCATION.

STAGE II REFERENCED TRAFFIC CONTROL STANDARDS
 701421-USE FOR TEMPORARY LANE CLOSURES - DAY ONLY
 701411-USE FOR SHOULDER AND LANE CLOSURE NEAR ENTRANCE/EXIT RAMP
 701901-USE FOR TRAFFIC CONTROL DEVICES
 704001-USE FOR TEMPORARY CONCRETE BARRIER
 720001 & 720006-USE FOR PROPOSED CONSTRUCTION SIGNS
 780001-USE FOR STAGING PAVEMENT MARKING

NOTE: THESE REFERENCED STANDARDS SHALL NOT BE PAID FOR SEPARATELY, BUT SHALL BE INCLUDED IN THE LUMP SUM COST OF TRAFFIC CONTROL AND PROTECTION - STAGE II.

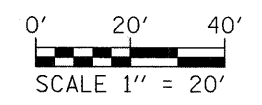
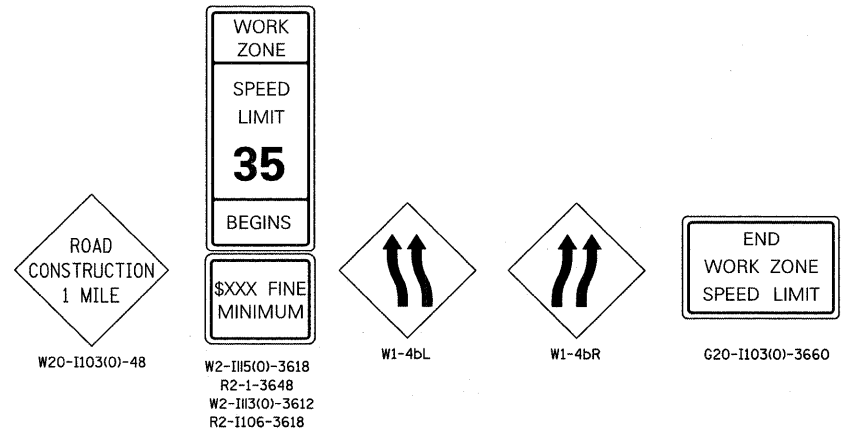

FILE NAME = P:\080276\US 51 over I-72\4-CADD\4.2-TR	USER NAME = jheger SHEETS\0774387-shr-staging-007.dgn	DESIGNED - MLS DRAWN - MLS CHECKED - SJK DATE -	REVISED - REVISED - REVISED - REVISED -	STATE OF ILLINOIS DEPARTMENT OF TRANSPORTATION		TRAFFIC CONTROL PLAN - STAGE II				F.A.P. RTE. 322	SECTION (58-64HB-1)B-1	COUNTY MACON	TOTAL SHEETS 149	SHEET NO. 27
PLOT SCALE = 20.0000' / in.		PLOT DATE = 3/15/2010		SCALE: 1:20		SHEET NO. 7 OF 22 SHEETS		STA. 1144+00 TO STA. 1149+50		US ROUTE 51 CONTRACT NO. 74387 FED. ROAD DIST. NO. 7 [ILLINOIS] FED. AID PROJECT				