

EXISTING SIGNS			
LOCATION	EXISTING SIGN	PROPOSED TREATMENT	RAMP
A	I-72 WEST, US 51 SOUTH US 51 SOUTH NEXT RIGHT US 51 NORTH ↗	COVER "US 51 SOUTH"	D
B	I-72 EAST ↗	ADD DETOUR ↑	B
C	US 51 SOUTH I-72 EAST NEXT RIGHT I-72, US 51 WEST ↗	COVER "I-72 EAST"	B
D	EXIT 141A HOSPITAL	COVER "EXIT 141A"	D
E	IL 48 ↗	ADD DETOUR SOUTH US 51 ↗	D

PROPOSED SIGNS		
LOCATION	PROPOSED SIGN	RAMP
1	RESERVED	
2 *	DETOUR EAST I-72 ←	B
3 *	DETOUR EAST I-72 ↙	B
4 *	DETOUR →	D
5 *	DETOUR SOUTH US 51 ←	D
6 *	DETOUR EAST I-72 ↑	B
7 *	DETOUR SOUTH US 51 ↑	D
8 *	DETOUR SOUTH US 51 ↗	D
9 *	DETOUR SOUTH US 51 →	D
10 *	END DETOUR	D

LOCATION	CHANGEABLE MESSAGE SIGN "SUGGESTED TEXT":	RAMP
11	RAMP CLOSED AT US 51 SOUTH USE IL 48	D
12	I-72 EB RAMP CLOSED. USE US 51 SOUTH TO IL 48	D

NOTE: ALL CHANGEABLE MESSAGE SIGNS, INCLUDING SIGNS SHOWN ON STANDARDS, TO BE PLACED AS SHOWN ON THE PLANS OR AT THE DIRECTION OF THE ENGINEER. MESSAGES POSTED ON CHANGEABLE MESSAGE SIGNS SHALL BE THE RESPONSIBILITY OF THE CONTRACTOR. COST INCLUDED IN COST OF CHANGEABLE MESSAGE SIGN.

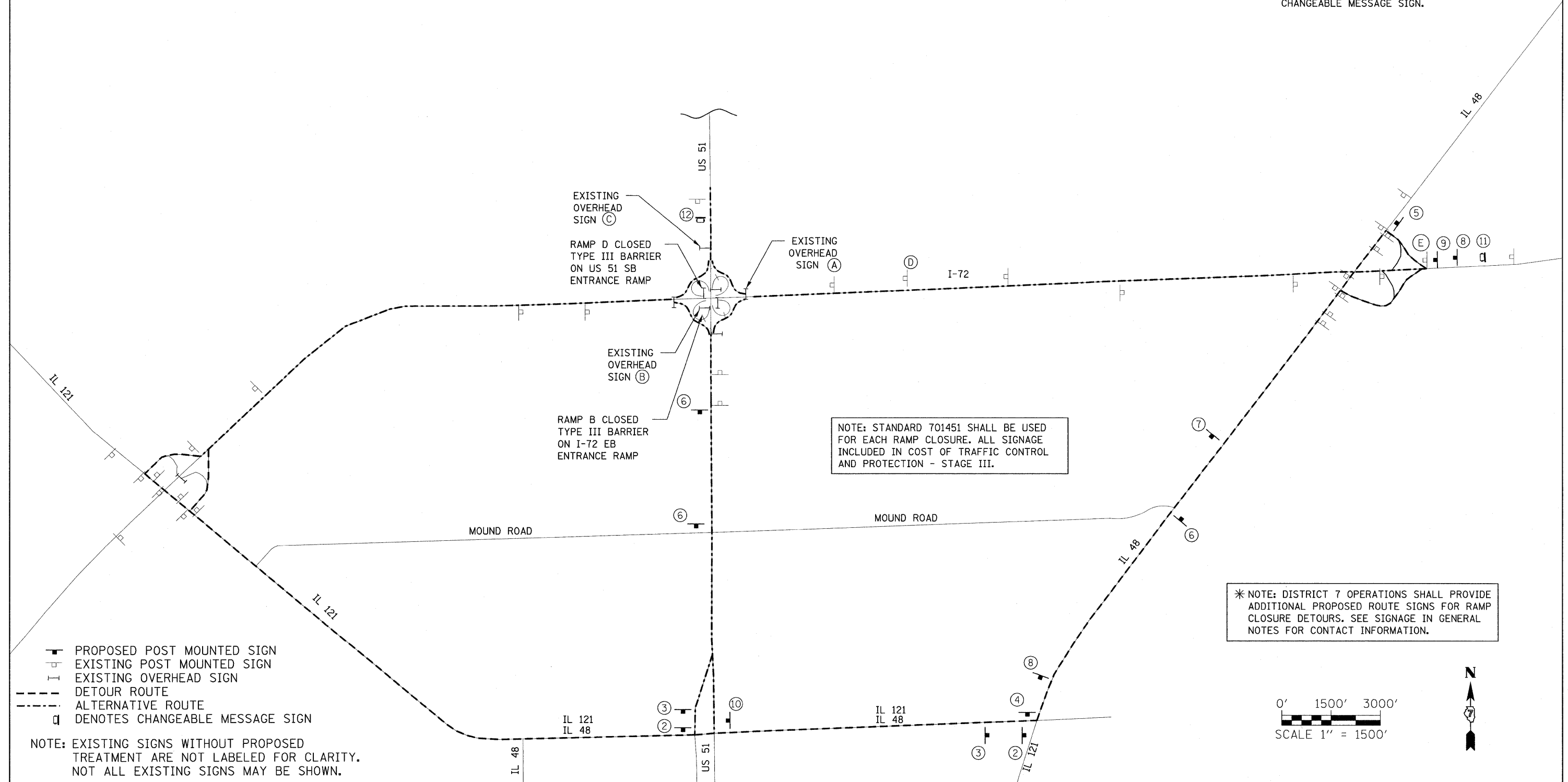

NOTE: STANDARD 701451 SHALL BE USED FOR EACH RAMP CLOSURE. ALL SIGNAGE INCLUDED IN COST OF TRAFFIC CONTROL AND PROTECTION - STAGE III.

* NOTE: DISTRICT 7 OPERATIONS SHALL PROVIDE ADDITIONAL PROPOSED ROUTE SIGNS FOR RAMP CLOSURE DETOURS. SEE SIGNAGE IN GENERAL NOTES FOR CONTACT INFORMATION.

- PROPOSED POST MOUNTED SIGN
- EXISTING POST MOUNTED SIGN
- EXISTING OVERHEAD SIGN
- - - - - DETOUR ROUTE
- · - · - ALTERNATIVE ROUTE
- DENOTES CHANGEABLE MESSAGE SIGN

NOTE: EXISTING SIGNS WITHOUT PROPOSED TREATMENT ARE NOT LABELED FOR CLARITY. NOT ALL EXISTING SIGNS MAY BE SHOWN.

