

EXISTING SIGNS			
LOCATION	EXISTING SIGN	PROPOSED TREATMENT	STAGE
A *	I-72, US 51 EAST ↑, WEST ←	ADD DETOUR TO "I-72 EAST" ↑	I & II
B	I-72, US 51 EAST ↙	COVER	I & II
C	I-72, US 51 EAST ←	COVER	I & II
D	I-72, US 51 WEST ↑, EAST →	COVER "I-72 EAST"	I & II
E *	I-72, US 51 EAST IL 121 ↗	ADD DETOUR TO "I-72 EAST"	I & II
F	I-72 EAST ↗	COVER	I & II
G	I-72 WEST NEXT RIGHT I-72 EAST	COVER "I-72 WEST"	I & II
H	I-72 EAST NEXT RIGHT	COVER	I & II
I	I-72	COVER	I & II
J	I-72 WEST ↗	COVER	I & II
K	US 51 NORTH I-72 EAST NEXT RIGHT I-72, US 51 WEST ↗	ADD DETOUR	I & II
L	I-72, US 51 WEST NEXT RIGHT	COVER	I & II
M	I-72 WEST ↑, EAST →	COVER "I-72 WEST"	I & II
N	I-72 WEST	COVER	I & II
P	I-72 WEST →	COVER	I & II
R *	I-72 EAST ↑, WEST ←	ADD DETOUR TO "I-72 WEST" ↑	I & II
S *	IL 48 ↗	ADD DETOUR TO I-72 WEST	I & II
T	EXIT 141A HOSPITAL	COVER "EXIT 141A"	I & II

PROPOSED SIGNS			
LOCATION	PROPOSED SIGN	STAGE	
1	DETOUR ←	I & II	
2 *	DETOUR EAST I-72 →, WEST I-72 ←	I & II	
3 *	DETOUR EAST I-72 ←, WEST I-72 →	I & II	
4	DETOUR ↑	I & II	
5	DETOUR →	I & II	
6	DETOUR ↗	I & II	
7 *	DETOUR WEST I-72 ←, EAST I-72 ↑	I & II	
8 *	DETOUR WEST I-72	I & II	
9 *	DETOUR EAST I-72	I & II	
10 *	DETOUR EAST I-72 ↑	I & II	
11 *	DETOUR WEST I-72 →, EAST I-72 ←	I & II	
12 *	I-72 DETOUR → OR ←	I & II	

LOCATION	CHANGEABLE MESSAGE SIGN "SUGGESTED TEXT":	STAGE
13	I-72 CLOSED AHEAD FOLLOW MARKED DETOUR	I & II
14	I-72 CLOSED MUST EXIT	I & II
15	I-72 CLOSED MUST EXIT	I & II
16	WB I-72 CLOSED AT US 51 USE IL 121 TO I-72	I & II
17	EB I-72 CLOSED AT US 51 USE US 51 TO IL 48 TO I-72	I & II

NOTE: ALL CHANGEABLE MESSAGE SIGNS, INCLUDING SIGNS SHOWN ON STANDARDS, TO BE PLACED AS SHOWN ON THE PLANS OR AT THE DIRECTION OF THE ENGINEER. MESSAGES POSTED ON CHANGEABLE MESSAGE SIGNS SHALL BE THE RESPONSIBILITY OF THE CONTRACTOR. COST INCLUDED IN COST OF CHANGEABLE MESSAGE SIGN.

\* NOTE: DISTRICT 7 OPERATIONS SHALL PROVIDE ROUTE SIGNS FOR I-72 CLOSURE DETOURS. SEE SIGNAGE IN GENERAL NOTES FOR CONTACT INFORMATION.

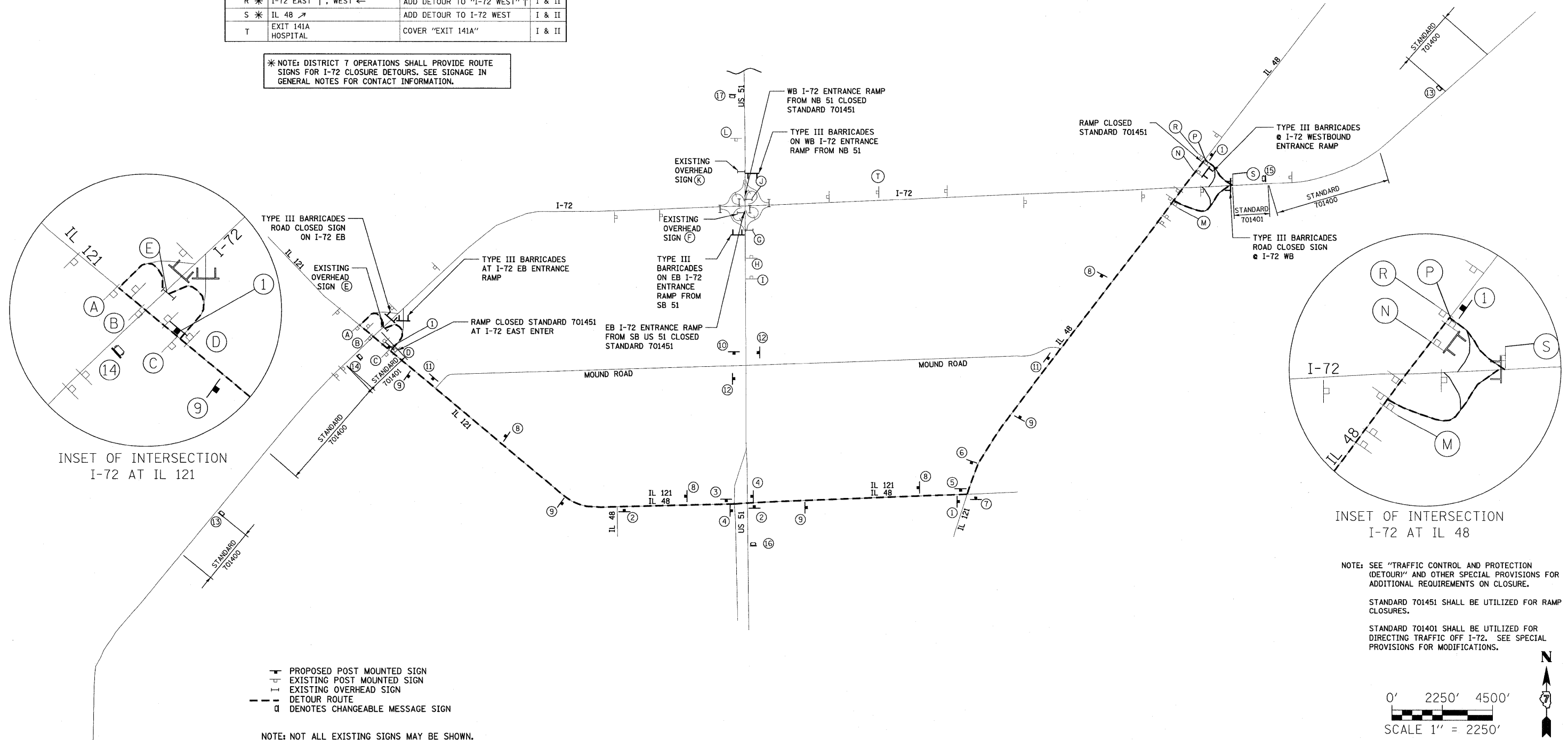

- P PROPOSED POST MOUNTED SIGN  
 - P EXISTING POST MOUNTED SIGN  
 - O EXISTING OVERHEAD SIGN  
 - - - - - DETOUR ROUTE  
 - □ DENOTES CHANGEABLE MESSAGE SIGN

NOTE: NOT ALL EXISTING SIGNS MAY BE SHOWN.

NOTE: SEE "TRAFFIC CONTROL AND PROTECTION (DETOUR)" AND OTHER SPECIAL PROVISIONS FOR ADDITIONAL REQUIREMENTS ON CLOSURE.  
 STANDARD 701451 SHALL BE UTILIZED FOR RAMP CLOSURES.  
 STANDARD 701401 SHALL BE UTILIZED FOR DIRECTING TRAFFIC OFF I-72. SEE SPECIAL PROVISIONS FOR MODIFICATIONS.

