

DATE	
BY	
SURVEYED	
PLOTTED	
TEMPLATE	
NOTE BOOK	
AREAS CHECKED	
NO.	

DATE	
BY	
SURVEYED	
PLOTTED	
TEMPLATE	
NOTE BOOK	
AREAS CHECKED	
NO.	

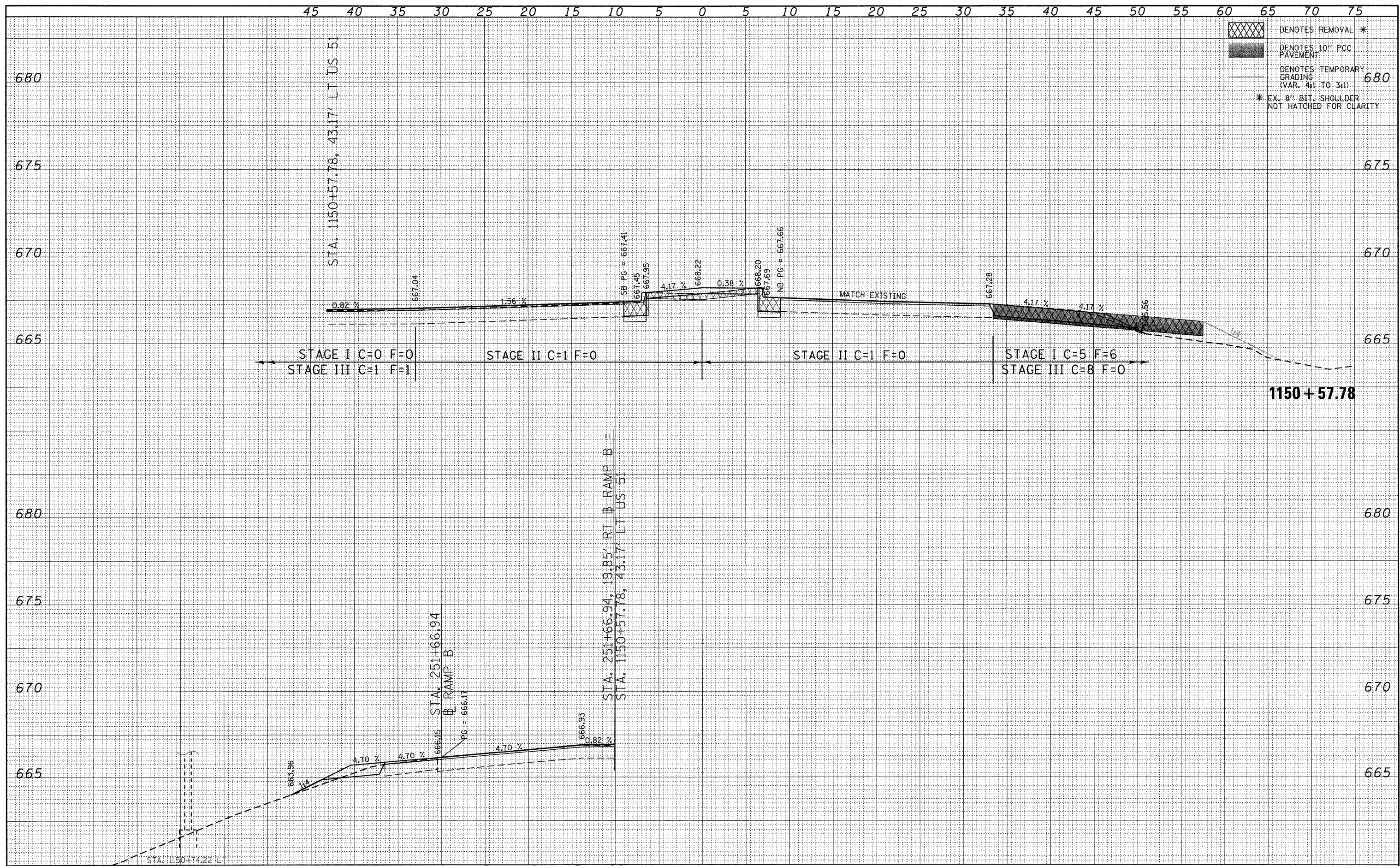

FILE NAME = P:\080276\US 51 over I-72\4-CADD\4.2-TR\SHEETS\0774387-shr-xshd.dgn

USER NAME = jheger
 DESIGNED - JWS
 DRAWN - JWS
 CHECKED - SJK
 DATE - 3/12/2010

REVISIONS
 REVISED -
 REVISED -
 REVISED -
 REVISED -

STATE OF ILLINOIS
 DEPARTMENT OF TRANSPORTATION

CROSS SECTIONS
 US 51 CROSS SECTIONS

SCALE: 1" = 5'
 SHEET NO. 6 OF 35 SHEETS
 STA. 1150+57.78 TO STA. 1150+57.78

F.A.P. RTE.	SECTION	COUNTY	TOTAL SHEETS	SHEET NO.
322	(58-64HB-1)B-1	MACON	149	120
CONTRACT NO. 74387			ILLINOIS FED. AID PROJECT	