

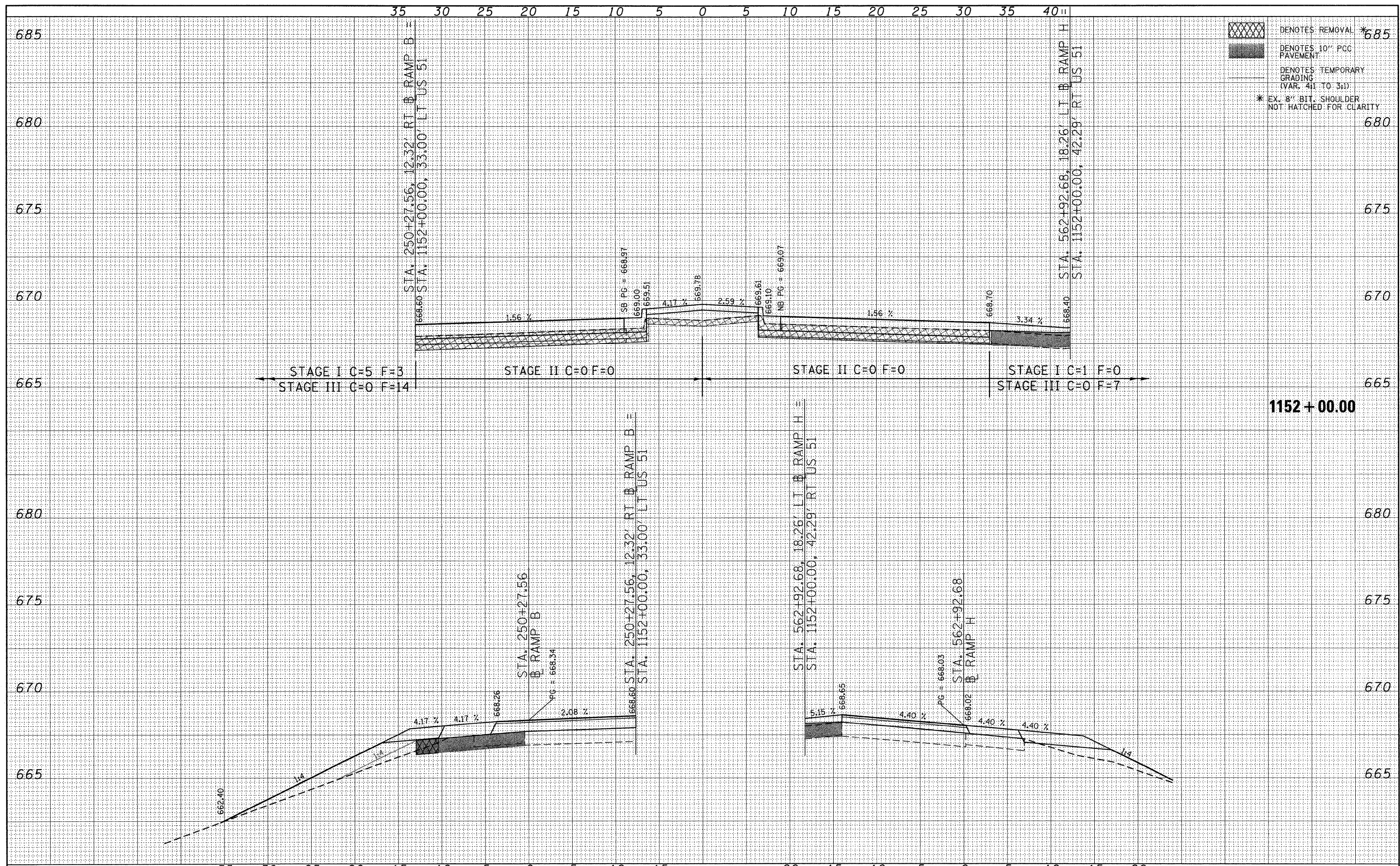



FINAL SURVEY	SURVEYED	BY	DATE
NOTE BOOK	PLOTTED		
AREAS CHECKED	TEMPLATE		
NO.	AREAS CHECKED		

ORIGINAL SURVEY	SURVEYED	BY	DATE
NOTE BOOK	PLOTTED		
AREAS CHECKED	TEMPLATE		
NO.	AREAS CHECKED		



 DENOTES REMOVAL *685
 DENOTES 10" PCC PAVEMENT
 DENOTES TEMPORARY GRADING (VAR. 4:1 TO 3:1)
 * EX. 8" BIT SHOULDER NOT HATCHED FOR CLARITY

FILE NAME = P:\080276\US 51 over I-72\4-CADD\4.2-TR\SHEETS	USER NAME = jheger 0774387-ahf-xasht.dgn	DESIGNED - JWS	REVISED -	STATE OF ILLINOIS DEPARTMENT OF TRANSPORTATION	CROSS SECTIONS US 51 CROSS SECTIONS		F.A.P. RTE. 322	SECTION (58-64HB-1)B-1	COUNTY MACON	TOTAL SHEETS 149	SHEET NO. 128	
PLOT SCALE = 5.0000' / in.	CHECKED - SJK	REVISED -	REVISED -		SCALE: 1" = 5"	SHEET NO. 14 OF 35 SHEETS	STA. 1152+00.00 TO STA. 1152+00.00	CONTRACT NO. 74387				
PLOT DATE = 3/12/2010	DATE - 3/12/2010	REVISED -	REVISED -		ILLINOIS FED. AID PROJECT							