

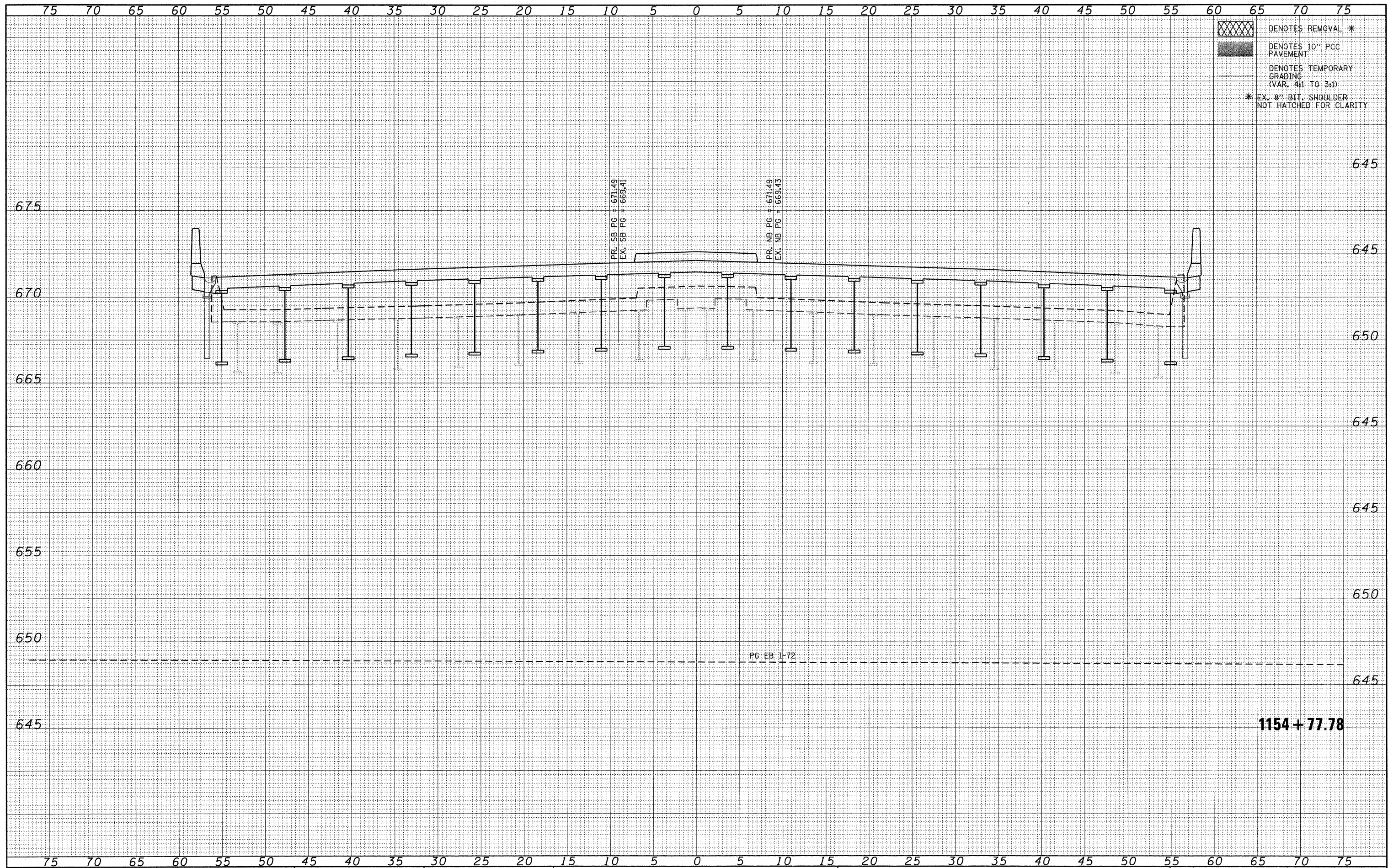



FINAL SURVEY	SURVEYED	BY	DATE
SURVEY	PLOTTED		
NOTE BOOK	TEMPLATE		
NO.	AREAS CHECKED		

ORIGINAL SURVEY	SURVEYED	BY	DATE
SURVEY	PLOTTED		
NOTE BOOK	TEMPLATE		
NO.	AREAS CHECKED		



 DENOTES REMOVAL *
 DENOTES 10" PCC PAVEMENT
 DENOTES TEMPORARY GRADING (VAR. 4:1 TO 3:1)
 * EX. 8" BIT. SHOULDER NOT HATCHED FOR CLARITY

FILE NAME = P:\080276\US 51 over I-72\4-CADD\4.2-TR\SHEETS
 USER NAME = jheger
 D774387-shr-xaht.dgn
 PLOT SCALE = 5.0000' / 1"
 PLOT DATE = 3/12/2010

DESIGNED -	JWS	REVISED -	
DRAWN -	JWS	REVISED -	
CHECKED -	SJK	REVISED -	
DATE -	3/12/2010	REVISED -	

STATE OF ILLINOIS
DEPARTMENT OF TRANSPORTATION

CROSS SECTIONS
US 51 CROSS SECTIONS

SCALE: 1" = 5" SHEET NO. 20 OF 35 SHEETS STA. 1153+51.03 TO STA. 1156+04.53

F.A.P. RTE.	SECTION	COUNTY	TOTAL SHEETS	SHEET NO.
322	(58-64HB-1)B-1	MACON	149	134
CONTRACT NO. 74387			ILLINOIS FED. AID PROJECT	