

STATE OF ILLINOIS  
DEPARTMENT OF TRANSPORTATION

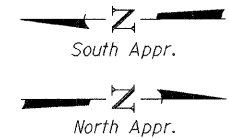

Notes: See sheet 17 of 21 for Sections C-C & D-D and View E-E.  
a<sub>100</sub> (E), a<sub>101</sub> (E), and w<sub>100</sub> (E) bar spacings measured perpendicular to  $\phi$  Rdwy.

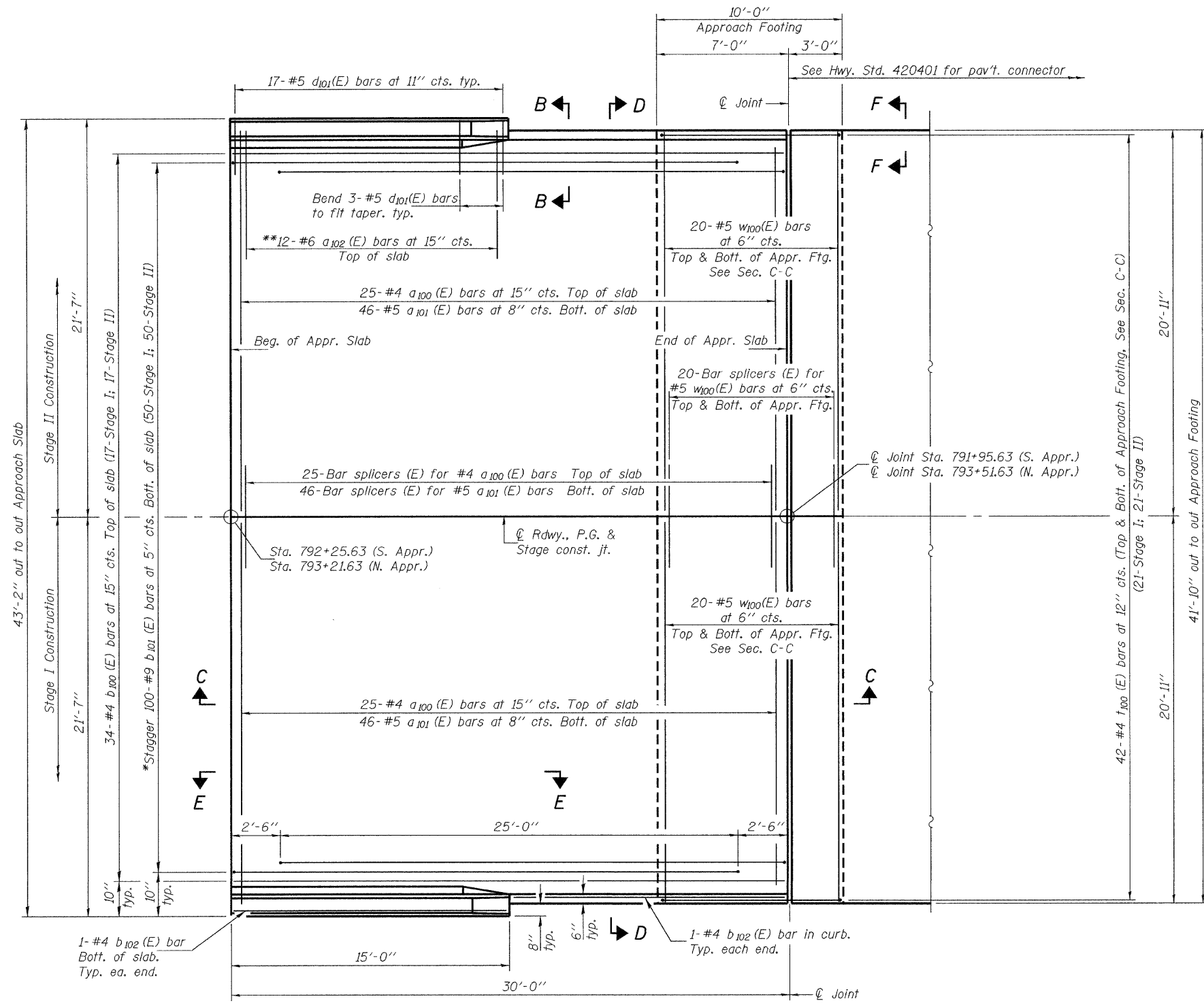

PLAN

(North Approach shown - South Approach similar by mirror image)

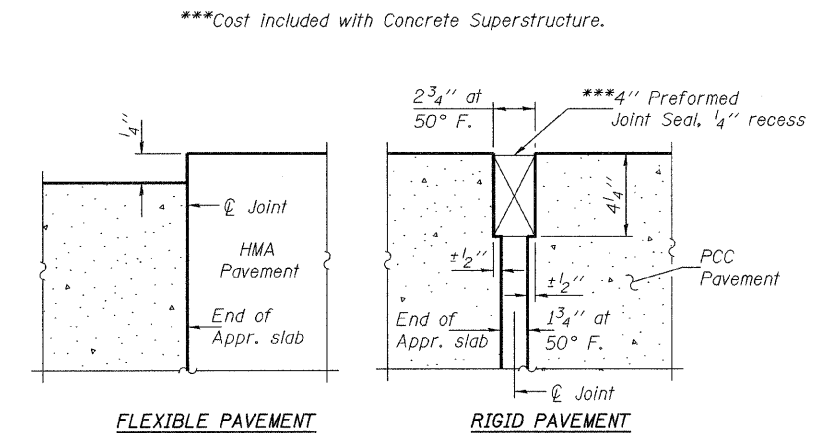

DETAIL A

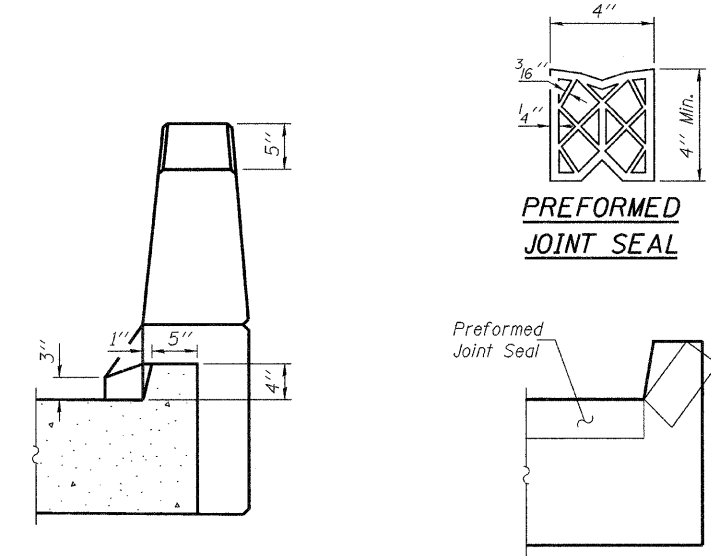

Angle Preformed Joint Seal at 45° at curbs when req'd for drainage.

DESIGNED	Roy Ahanchi
CHECKED	Jay D. Edwards
DRAWN	h.t. duong
CHECKED	GRA/JDE

EXAMINED	Thomas J. Domagalaki ENGINEER OF BRIDGE DESIGN
PASSED	Ralph E. Anderson ENGINEER OF BRIDGES AND STRUCTURES

\*Tilt #9 b<sub>101</sub> (E) bars as required to maintain clearance.  
\*\*Spaced between a<sub>100</sub> (E), typ. ea. parapet.

BRIDGE APPROACH SLAB DETAILS  
STRUCTURE NO. 079-0050

SHEET NO. 16 21 SHEETS	F.A.P. RTE.	SECTION	COUNTY	TOTAL SHEETS	SHEET NO.
	682	21BR, 21-I-1	RANDOLPH	77	55
CONTRACT NO. 76126					
FED. ROAD DIST. NO.		ILLINOIS FED. AID PROJECT			