

F.A.P. RTE.	SECTION	COUNTY	TOTAL SHEETS	SHEET NO.
310	60-16	MADISON	662	39
STA. 92+50 TO STA. 123+00			FED. AID PROJECT	
CONTRACT NO. 76311				

FAP 310 310-1 PI STA. = 80+34.80 Δ = 23° 43' 39" (LT) D = 1° 45' 19" R = 3,264.43' T = 685.77' L = 1,351.88' E = 71.25' e = 4.80% T.R. = 40.00' S.E. RUN = 216.00' P.C. STA. = 73+49.03 P.T. STA. = 87+00.91	FAP 310 310-2 PI STA. = 102+83.08 Δ = 4° 10' 45" (LT) D = 0° 49' 17" R = 6,976.16' T = 254.54' L = 508.86' E = 4.64' e = 2.70% T.R. = 48.00' S.E. RUN = 123.00' P.C. STA. = 100+28.54 P.T. STA. = 105+37.40	FAP 310 310-3 PI STA. = 111+57.88 Δ = 4° 41' 50" (RT) D = 0° 33' 53" R = 10,148.10' T = 416.21' L = 831.96' E = 8.53' e = 1.50% T.R. = 69.00' S.E. RUN = 69.00' P.C. STA. = 107+41.67 P.T. STA. = 115+73.63	ACCESS ROAD A2-1 PI STA. = 15+42.00 Δ = 138° 47' 00" (RT) D = 34° 43' 29" R = 165.00' T = 438.78' L = 399.67' E = 303.78' e = 4.00% T.R. = 33.00' S.E. RUN = 87.00' P.C. STA. = 11+03.22 P.T. STA. = 15+02.89	ACCESS ROAD A2-2 PI STA. = 16+62.76 Δ = 54° 22' 57" (LT) D = 34° 43' 29" R = 165.00' T = 84.77' L = 156.61' E = 20.50' e = 4.00% T.R. = 33.00' S.E. RUN = 87.00' P.C. STA. = 15+77.99 P.T. STA. = 17+34.60	ACCESS ROAD A2-3 PI STA. = 29+19.79 Δ = 34° 26' 03" (LT) D = 5° 32' 48" R = 1,033.00' T = 320.10' L = 620.82' E = 48.46' e = 3.50% T.R. = 21.00' S.E. RUN = 51.00' P.C. STA. = 25+99.68 P.T. STA. = 32+20.51	ACCESS ROAD A3-1 PI STA. = 15+53.00 Δ = 138° 47' 00" (LT) D = 34° 43' 29" R = 165.00' T = 438.78' L = 399.67' E = 303.78' e = 4.00% T.R. = 33.00' S.E. RUN = 87.00' P.C. STA. = 11+14.22 P.T. STA. = 15+13.89	ACCESS ROAD A3-2 PI STA. = 16+69.98 Δ = 51° 04' 23" (RT) D = 34° 43' 29" R = 165.00' T = 78.83' L = 147.08' E = 17.86' e = 4.00% T.R. = 33.00' S.E. RUN = 87.00' P.C. STA. = 15+91.15 P.T. STA. = 17+38.23	RAMP A RA-1 PI STA. = 2+30.43 Δ = 3° 30' 37" (RT) D = 0° 49' 48" R = 6,904.00' T = 211.55' L = 422.97' E = 3.24' e = 2.70% T.R. = NA S.E. RUN = NA P.C. STA. = 0+18.88 P.T. STA. = 4+41.85	RAMP A RA-2 PI STA. = 11+21.41 Δ = 34° 20' 18" (RT) D = 5° 39' 42" R = 1,012.00' T = 312.67' L = 606.51' E = 47.20' e = 8.00% T.R. = NA S.E. RUN = 249 P.C. STA. = 8+08.74 P.T. STA. = 14+15.25
--	---	---	---	--	--	---	--	--	---

ACCESS ROAD A1-1 PI STA. = 14+25.00 Δ = 32° 40' 07" (RT) D = 21° 37' 16" R = 265.00' T = 77.66' L = 151.10' E = 11.15' e = 8.00% T.R. = 30.00' S.E. RUN = 147.00' P.C. STA. = 13+47.34 P.T. STA. = 14+98.43	ACCESS ROAD A1-2 PI STA. = 17+91.29 Δ = 32° 40' 07" (LT) D = 21° 37' 16" R = 265.00' T = 77.66' L = 151.10' E = 11.15' e = 8.00% T.R. = 30.00' S.E. RUN = 147.00' P.C. STA. = 17+13.63 P.T. STA. = 18+64.72	ACCESS ROAD A1-3 PI STA. = 39+11.97 Δ = 47° 48' 17" (LT) D = 8° 40' 52" R = 660.00' T = 292.50' L = 109.03' E = 61.91' e = 5.50% T.R. = 30.00' S.E. RUN = 102.00' P.C. STA. = 36+19.46 P.T. STA. = 41+70.13	ACCESS ROAD A1-4 PI STA. = 47+13.63 Δ = 23° 45' 34" (RT) D = 6° 59' 14" R = 820.00' T = 172.50' L = 340.04' E = 17.95' e = 5.50% T.R. = 30.00' S.E. RUN = 93.00' P.C. STA. = 45+41.13 P.T. STA. = 48+81.17	ACCESS ROAD A1-5 PI STA. = 61+00.00 Δ = 9° 27' 54" (RT) D = 8° 40' 52" R = 660.00' T = 54.64' L = 109.03' E = 2.26' e = 5.50% T.R. = 30.00' S.E. RUN = 102.00' P.C. STA. = 60+45.36 P.T. STA. = 61+54.39	ACCESS ROAD A1-6 PI STA. = 65+08.06 Δ = 5° 22' 05" (RT) D = 8° 40' 52" R = 660.00' T = 30.94' L = 61.84' E = 0.72' e = 5.50% T.R. = 30.00' S.E. RUN = 102.00' P.C. STA. = 64+77.12 P.T. STA. = 65+38.96	RAMP A RA-3 PI STA. = 20+00.75 Δ = 2° 52' 21" (RT) D = 0° 46' 34" R = 7,381.89' T = 185.09' L = 370.09' E = 2.32' e = N.C. T.R. = NA S.E. RUN = NA P.C. STA. = 18+15.66 P.T. STA. = 21+85.76	RAMP B RB-1 PI STA. = 8+79.54 Δ = 4° 17' 57" (RT) D = 0° 46' 34" R = 7,381.89' T = 277.08' L = 553.89' E = 5.20' e = N.C. T.R. = NA S.E. RUN = NA P.C. STA. = 6+02.46 P.T. STA. = 11+56.35
---	---	---	--	--	---	--	--

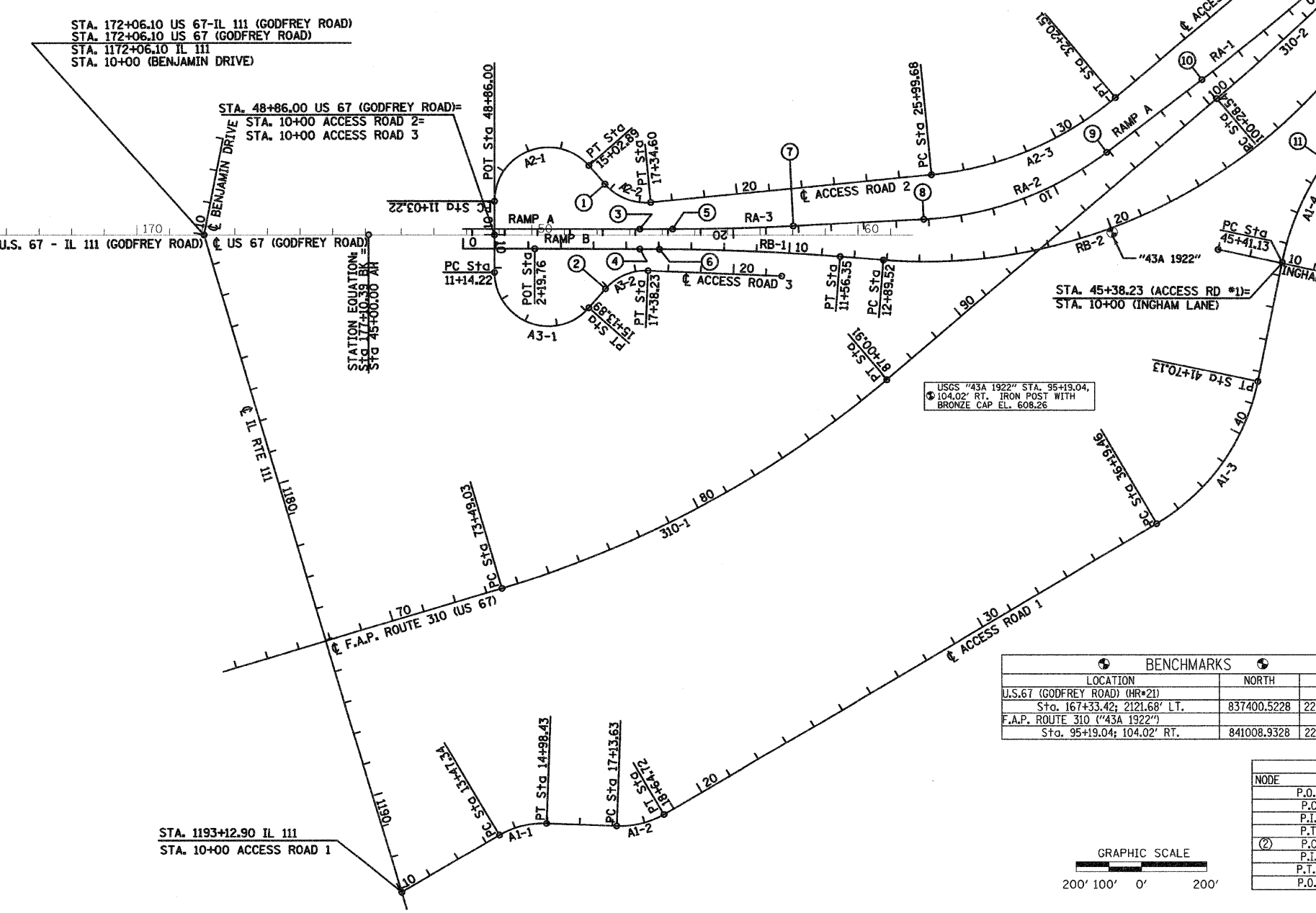

NODE	DESCRIPTION	NORTH	EAST
①	P.O.T. Station 0+00.00	841468.3713	2287742.3978
②	P.C. Station 0+18.88	841456.7828	2287757.3002
③	P.I. Station 2+30.43	841326.9189	2287924.3012
④	P.T. Station 4+41.85	841187.0738	2283519.1781
⑤	P.C. Station 8+08.74	840944.5416	2288358.3334
⑥	P.I. Station 11+21.41	840737.8536	2288592.9427
⑦	P.T. Station 14+15.25	840434.8490	2288670.0769
⑧	P.C. Station 18+15.66	840046.8067	2288768.8588
⑨	P.I. Station 20+00.75	839867.4414	2288814.5188
⑩	P.T. Station 21+85.76	839686.0132	2288851.1328
⑪	P.O.T. Station 22+86.36	839587.4003	2288871.0338
⑫	P.O.T. Station 28+28.22	839056.2030	2288977.9997

NODE	DESCRIPTION	NORTH	EAST
⑬	P.O.T. Station 0+00.00	839068.0115	2289036.8263
⑭	P.O.T. Station 2+19.76	839283.4734	2288993.5757
⑮	P.O.T. Station 5+41.86	839599.4233	2288930.9290
⑯	P.C. Station 6+02.46	839658.8704	2288919.1719
⑰	P.I. Station 8+79.54	839930.6822	2288865.4144
⑱	P.T. Station 11+56.35	840205.7590	2288832.1842
⑲	P.C. Station 12+89.52	840337.9647	2288816.2133
⑳	P.I. Station 14+15.25	841290.8645	2288701.0999
㉑	P.T. Station 17+38.23	841657.3561	2287813.9962
㉒	P.C. Station 21+85.76	841720.1954	2287661.8919
㉓	P.I. Station 24+49.35	841790.0554	2287492.7937
㉔	P.T. Station 28+28.22	841894.2450	2287342.3937
㉕	P.C. Station 31+90.97	841894.2473	2287342.3937
㉖	P.I. Station 35+55.50	842042.6119	2287128.2308
㉗	P.T. Station 38+16.03	842201.8434	2286922.0193
㉘	P.O.T. Station 40+76.45	842584.9858	2286425.8336

DESCRIPTION	NORTH	EAST
P.O.T. Station 8+00.00	841338.0560	2288582.9680
P.O.T. Station 12+00.00	841738.0180	2288588.4970

DESCRIPTION	NORTH	EAST
P.O.T. Station 10+00.00	842035.9060	228722.4990
P.O.T. Station 15+00.00	842535.9060	228722.5750

NODE	DESCRIPTION	NORTH	EAST
①	P.O.T. Station 10+00.00	839154.3974	2288976.6478
②	P.C. Station 11+14.22	839176.8765	2289088.6324
③	P.I. Station 15+53.00	839263.2323	2289518.8323
④	P.T. Station 15+13.89	839481.7358	2289138.3254
⑤	P.C. Station 15+91.15	839520.2114	2289071.3230
⑥	P.I. Station 16+69.98	839559.4670	2289002.9624
⑦	P.T. Station 17+38.23	839637.3134	2288990.5482
⑧	P.O.T. Station 21+48.06	840042.0277	2288926.0083

NAME	DATE

DESCRIPTION	NORTH	EAST
P.O.T. Station 160+00.00	837099.0108	2289389.2339
Sta 177+10.39(BK) = Sta 45+00.00(AH)	838775.9468	2289052.6158
P.C. Station 61+68.11	840411.4300	2288724.3186

DESCRIPTION	NORTH	EAST
P.O.T. Station 56+27.91	837868.7856	2290838.8640
P.C. Station 73+49.03	839389.0977	2290032.0701
P.I. Station 80+34.80	839994.8527	2289710.6101
P.T. Station 87+00.91	840420.0517	2289172.5751
P.C. Station 100+28.54	841243.2278	2288130.9509
P.I. Station 102+83.08	841401.0523	2287931.2442
P.T. Station 105+37.40	841543.9030	2287720.5666
P.C. Station 107+41.67	841658.5433	2287551.4940
P.I. Station 111+57.88	841892.1258	2287207.0042
P.T. Station 115+73.63	842153.1341	2286882.7996
P.C. Station 121+55.12	842571.7847	2286429.8584

DESCRIPTION	NORTH	EAST
P.O.T. Station 10+00.00	838281.5220	2289151.8630
P.O.T. Station 13+00.00	838280.4220	2288851.8640

DESCRIPTION	NORTH	EAST
P.O.T. Station 1172+06.10	838281.5220	2289151.8640
P.O.T. Station 1202+06.10	839693.5580	2291798.7780

NODE	DESCRIPTION	NORTH	EAST
①	P.O.T. Station 10+00.00	839273.1481	2291010.7040
②	P.C. Station 13+47.34	839531.4672	2290778.5107
③	P.I. Station 14+25.00	839589.2268	2290726.5927
④	P.T. Station 14+98.43	839665.8735	2290714.0653
⑤	P.C. Station 17+13.63	839878.2500	2290679.3537
⑥	P.I. Station 17+91.29	839954.8967	2290666.8262
⑦	P.T. Station 18+64.72	840012.6563	2290614.9083
⑧	P.C. Station 18+64.72	841317.6812	2289441.8705
⑨	P.I. Station 39+11.97	841535.2204	2289246.3327
⑩	P.T. Station 41+70.13	841536.4670	2288953.8317
⑪	P.C. Station 45+41.13	841538.0482	2288582.8367
⑫	P.I. Station 47+13.63	841538.7834	2288410.3403
⑬	P.T. Station 48+81.17	841608.9547	2288252.7600
⑭	P.C. Station 60+45.36	842082.5423	2287189.2462
⑮	P.I. Station 61+54.39	842104.7688	2287139.3331
⑯	P.T. Station 61+54.39	842134.9007	2287093.7545
⑰	P.C. Station 64+77.12	842312.8820	2286824.5329
⑱	P.I. Station 65+08.06	842329.9450	2286798.7228
⑲	P.T. Station 65+38.96	842349.3478	2286774.6221

NODE	DESCRIPTION	NORTH	EAST
①	P.O.T. Station 10+00.00	839154.3970	2288976.6480
②	P.C. Station 11+03.22	839134.0832	2288875.4482
③	P.I. Station 15+42.00	839047.7274	2288445.2483
④	P.T. Station 15+02.89	839396.1485	2288711.9541
⑤	P.C. Station 15+77.99	839455.7890	2288757.6071
⑥	P.I. Station 16+62.76	839523.0993	2288809.1311
⑦	P.T. Station 17+34.60	839604.1839	2288784.4191
⑧	P.C. Station 25+99.68	840431.6871	2288532.2219
⑨	P.I. Station 29+19.79	840737.8860	2288438.9020
⑩	P.T. Station 32+20.51	840937.6634	2288188.7913
⑪	P.O.T. Station 41+32.06	841506.5640	2287476.5580

ILLINOIS DEPARTMENT OF TRANSPORTATION

# HORIZONTAL CONTROL

SCALE: VERT. 1"=200'  
HORIZ. 1"=200'  
DATE: 09-04-09

DRAWN BY: JWC  
CHECKED BY: JAR

