

F.A.P. RTE.	SECTION	COUNTY	TOTAL SHEETS	SHEET NO.
310	60-16	MADISON	662	95
STA. 207+40		TO STA. 240+00		
FED. ROAD DIST. NO. 8 ILLINOIS FED. AID PROJECT				
CONTRACT NO. 76311				

STA. 172+06.10 US 67-IL 111 (GODFREY ROAD)
 STA. 172+06.10 US 67 (GODFREY ROAD)
 STA. 1172+06.10 IL 111
 STA. 10+00 (BENJAMIN DRIVE)

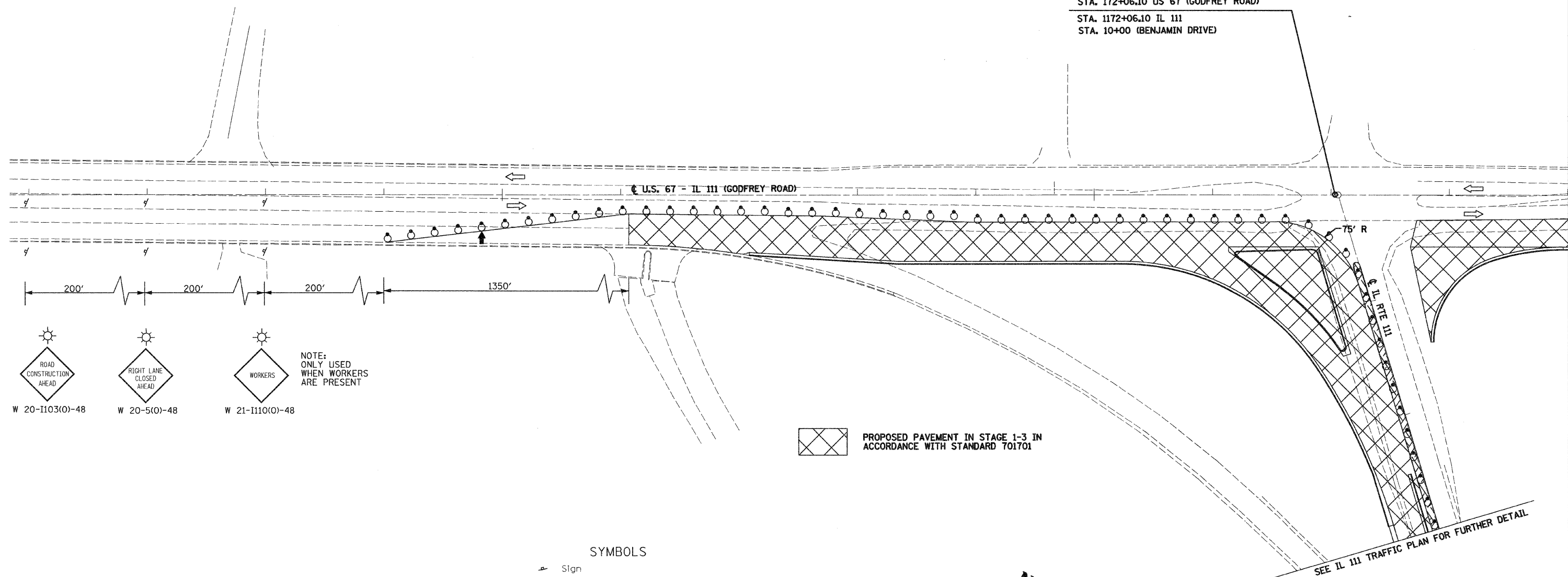

NOTE: ONLY USED WHEN WORKERS ARE PRESENT

W 20-1103(O)-48
 W 20-5(O)-48
 W 21-1110(O)-48

PROPOSED PAVEMENT IN STAGE 1-3 IN ACCORDANCE WITH STANDARD 701701

- SYMBOLS**
- Sign
 - Barricade or drum with monodirectional steady burning light
 - Vertical panel with Monodirectional Steady Burning Lights
 - Type III barricade with Flashers
 - Flashing Light
 - Arrow Board

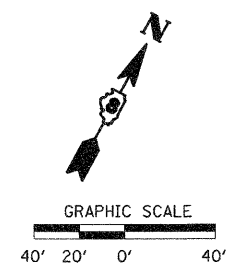

REVISIONS	
NAME	DATE

ILLINOIS DEPARTMENT OF TRANSPORTATION

US 67 STAGE 1-3 TRAFFIC PLAN

SCALE: VERT. _____
 HORIZ. _____

DATE: 09-04-09

DRAWN BY: T.W.C.
 CHECKED BY: J.J.C.

... \Temp_SitePlan\111\111_01.dgn 9/4/2009 3:31:46 PM