

F.A.P. RTE.	SECTION	COUNTY	TOTAL SHEETS	SHEET NO.
310	60-16	MADISON	662	111
STA. 45+38.23 (ACCESS RD #1) = STA. 10+00 (INGHAM LANE)		TO STA.		
FED. ROAD DIST. NO. 8 ILLINOIS		FED. AID PROJECT		
CONTRACT NO. 76311				

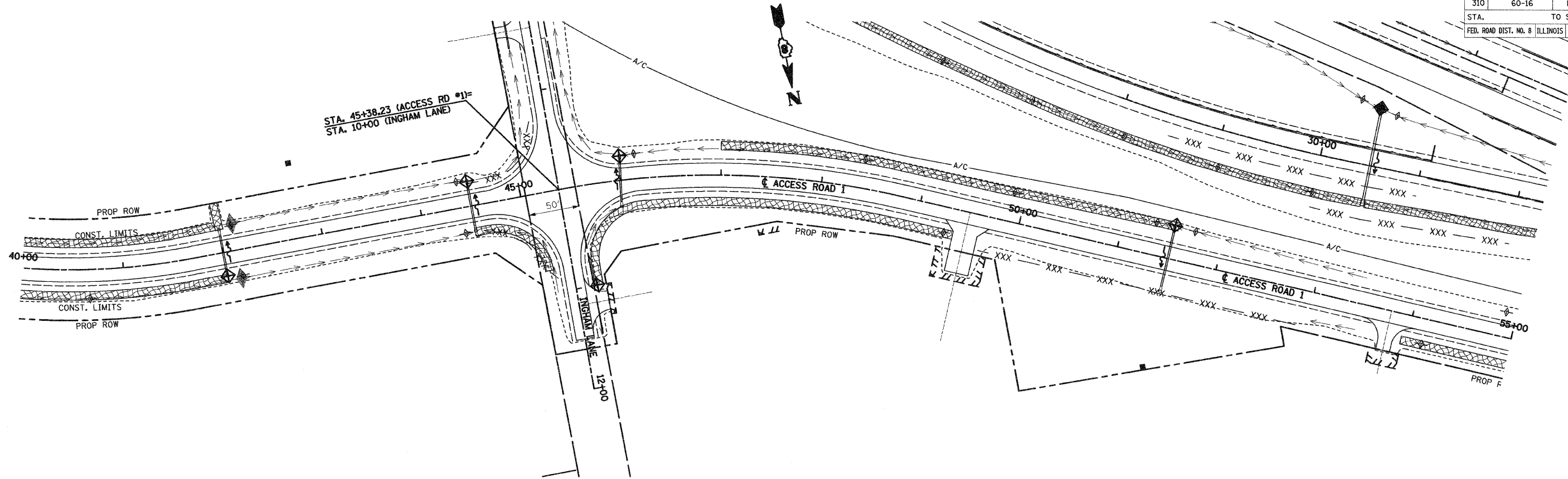

ACCESS ROAD 1

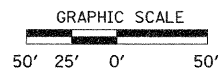
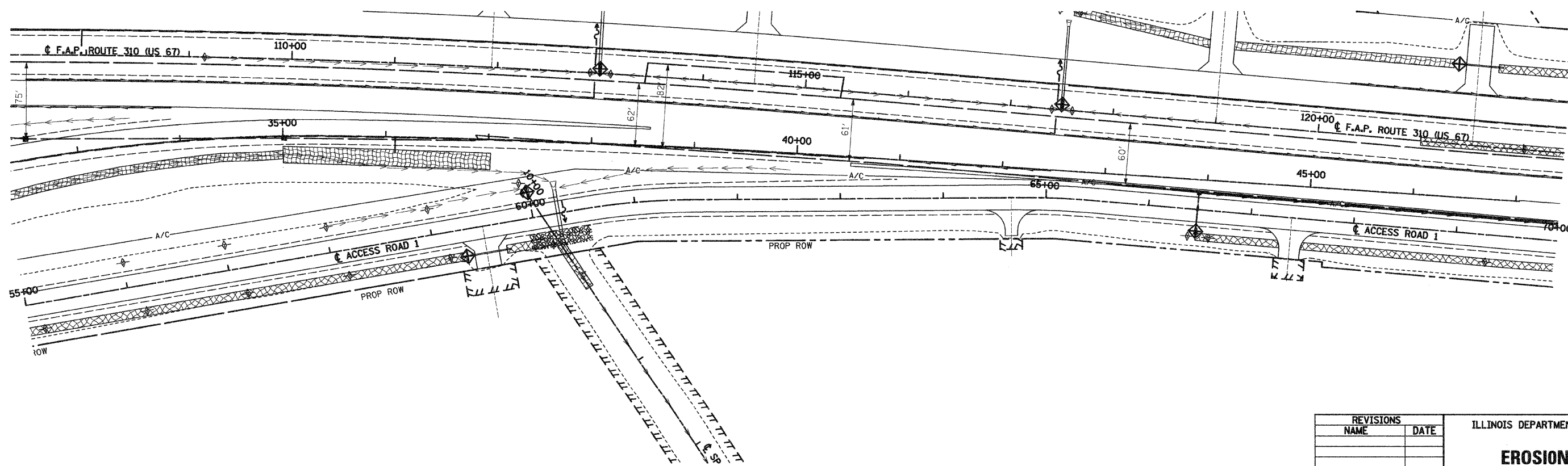

ACCESS ROAD 1

REVISIONS	
NAME	DATE

ILLINOIS DEPARTMENT OF TRANSPORTATION

EROSION CONTROL PLAN

SCALE: VERT.
HORIZ.
DATE: 09-04-09

DRAWN BY: U.J.
CHECKED BY: M.A.R.

E:\2009\50\0909\0909.dwg 9/4/2009 8:47:31 AM