

DATE: 7/28/2008
 BY: J.M.M.
 CHECKED: J.M.M.
 PLAN NO. 729
 REVISIONS:
 1. DATE: 7/28/2008
 BY: J.M.M.
 CHECKED: J.M.M.
 PLAN NO. 729

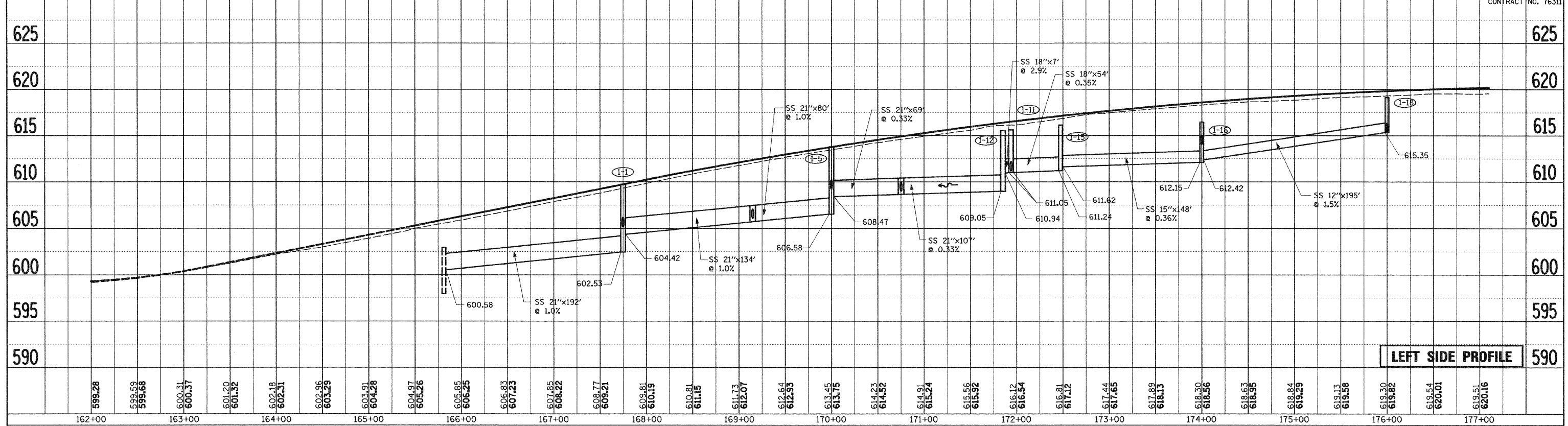

LEFT SIDE PROFILE

DATE: 7/28/2008
 BY: J.M.M.
 CHECKED: J.M.M.
 PROFILE NO. 730
 REVISIONS:
 1. DATE: 7/28/2008
 BY: J.M.M.
 CHECKED: J.M.M.
 PROFILE NO. 730

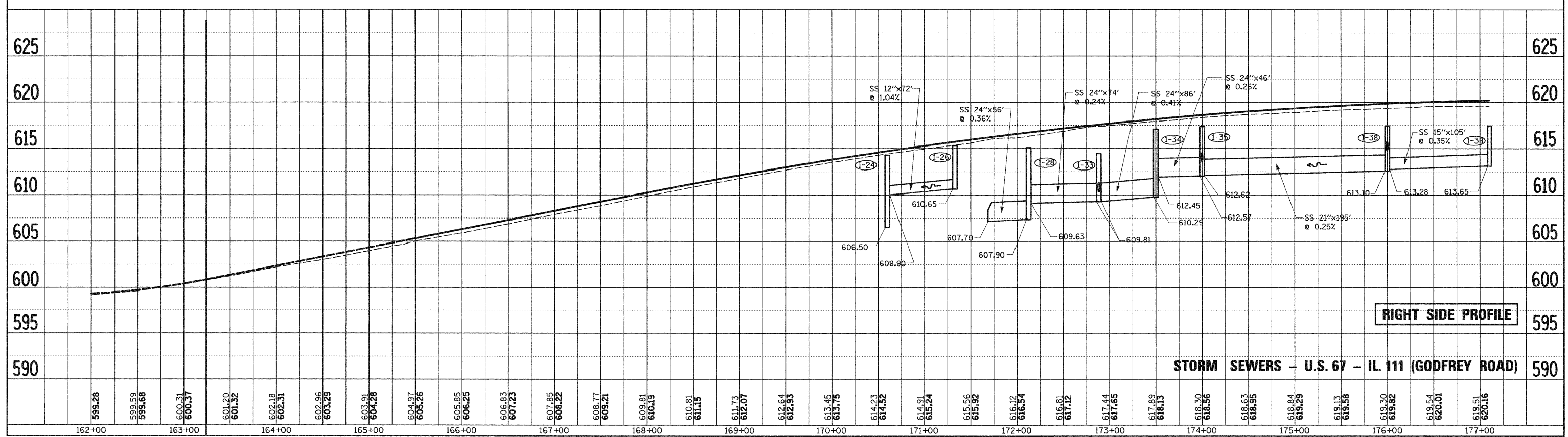

RIGHT SIDE PROFILE

STORM SEWERS - U.S. 67 - IL. 111 (GODFREY ROAD)