

STATIONING ALONG U.S. RTE 67	OFFSET TO EOP FEET	EDGE OF PAVT ELEV FEET	STATIONING ALONG BENJAMIN ROAD	OFFSET TO EOP FEET
171+54.43	24.00	615.61	10+13.57	55.34
171+73.90	27.95	615.51	10+21.20	37.00
171+90.30	39.17	615.41	10+35.38	23.07
172+01.03	55.89	615.71	10+53.86	15.77
172+03.48	64.34	615.84	10+62.63	15.00

STATIONING ALONG U.S. RTE 67	OFFSET TO EOP FEET	EDGE OF PAVT ELEV FEET	STATIONING ALONG BENJAMIN ROAD	OFFSET TO EOP FEET
172+86.10	20.00	617.21	10+35.08	74.63
172+66.66	23.95	616.46	10+35.20	54.79
172+50.27	35.17	615.71	10+43.04	36.54
172+39.53	51.89	615.81	10+57.37	22.78
172+36.16	71.47	615.91	10+75.93	15.68
172+37.08	79.66	615.95	10+84.15	15.00

STATIONING ALONG U.S. RTE 67	OFFSET TO EOP FEET	EDGE OF PAVT ELEV FEET	STATIONING ALONG IL 111
170+26.17	56.00	613.68	1172+07.94
170+46.14	57.00	613.93	1172+14.65
170+65.90	59.99	614.17	1172+23.19
170+85.27	64.93	614.42	1172+33.51
171+04.06	71.79	614.66	1172+45.48
171+22.06	80.48	614.90	1172+58.99
171+39.10	90.93	615.14	1172+73.90
171+55.01	103.03	615.38	1172+90.07
171+69.64	116.66	615.22	1173+07.33
171+83.09	132.00	615.06	1173+25.89
171+92.65	145.16	614.92	1173+41.24
172+05.11	164.87	614.74	1173+63.70
172+14.97	182.04	614.58	1173+83.00
172+24.22	199.77	614.61	1174+02.63
172+32.76	217.86	614.65	1174+22.41
172+40.57	236.27	614.68	1174+42.29

STATIONING ALONG U.S. RTE 67	OFFSET TO EOP FEET	EDGE OF PAVT ELEV FEET	STATIONING ALONG IL 111	OFFSET TO EOP FEET
173+98.71	44.00	618.25	1173+03.69	171.79
173+78.74	45.00	617.93	1172+98.88	152.38
173+58.97	47.99	617.60	1172+96.06	132.59
173+40.03	52.80	617.28	1172+95.21	113.07
173+21.54	61.37	616.95	1172+98.10	92.89
173+06.33	74.28	616.63	1173+06.08	74.61
172+95.07	90.73	616.30	1173+18.60	59.09
172+88.54	109.57	615.98	1173+34.76	47.41
172+87.08	129.48	615.65	1173+53.40	40.29
172+88.50	149.42	615.33	1173+72.91	35.91
172+91.91	169.12	615.00	1173+92.76	33.50
172+95.50	182.79	614.76	1174+06.89	33.00

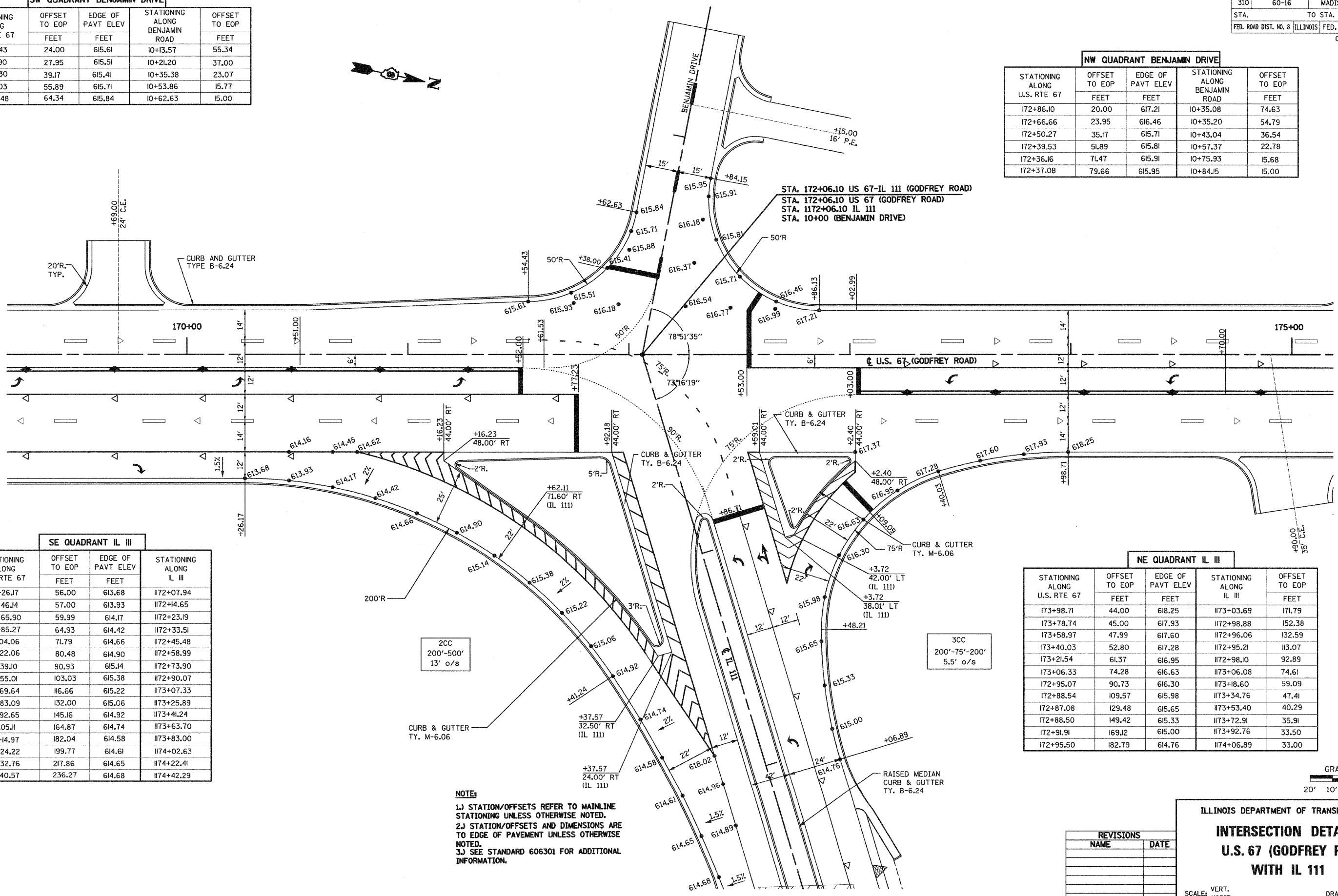

NOTE:
 1.) STATION/OFFSETS REFER TO MAINLINE STATIONING UNLESS OTHERWISE NOTED.
 2.) STATION/OFFSETS AND DIMENSIONS ARE TO EDGE OF PAVEMENT UNLESS OTHERWISE NOTED.
 3.) SEE STANDARD 606301 FOR ADDITIONAL INFORMATION.

REVISIONS	
NAME	DATE

ILLINOIS DEPARTMENT OF TRANSPORTATION

INTERSECTION DETAILS U.S. 67 (GODFREY RD) WITH IL 111

SCALE: VERT. _____
 HORIZ. _____
 DATE: 09-04-09

DRAWN BY: T.W.C.
 CHECKED BY: J.J.C.

