

F.A. RTE.	SECTION	COUNTY	TOTAL SHEETS	SHEET NO.
310	60-16	MADISON	662	156
STA.		TO STA.		
FED. ROAD DIST. NO. 8		ILLINOIS		FED. AID PROJECT
CONTRACT NO. 76311				



PI Sta. 160+96.28  
 $\Delta = 8^\circ 26' 25''$  (LT)  
 $D = 1^\circ 29' 08''$   
 $T = 284.59'$   
 $R = 3,856.80'$   
 $L = 568.16'$   
 $E = 10.49'$   
PCC Sta. 158+11.69  
PT Sta. 163+79.84  
S.E. RATE 4.3%  
S.E. ATTAINED  
Sta. 156+39.69 TO Sta. 158+76.69  
Sta. 163+54.84 TO Sta. 163+79.84

PI Sta. 168+25.32  
 $\Delta = 17^\circ 30' 00''$  (LT)  
 $D = 1^\circ 58' 47''$   
 $T = 445.48'$   
 $R = 2,894.31'$   
 $L = 884.02'$   
 $E = 34.08'$   
PCC Sta. 163+79.84  
PT Sta. 172+63.86  
S.E. RATE 5.2%  
S.E. ATTAINED  
Sta. 163+54.84 TO Sta. 163+79.84  
Sta. 171+85.86 TO Sta. 174+59.86

**BURIED TURN LANE**  
PI Sta. 53+00.87  
 $\Delta = 11^\circ 40' 10''$  (LT)  
 $D = 1^\circ 56' 46''$   
 $T = 300.87'$   
 $R = 2,944.24'$   
 $L = 599.65'$   
 $E = 15.33'$   
PC Sta. 50+00.00  
PT Sta. 55+99.65

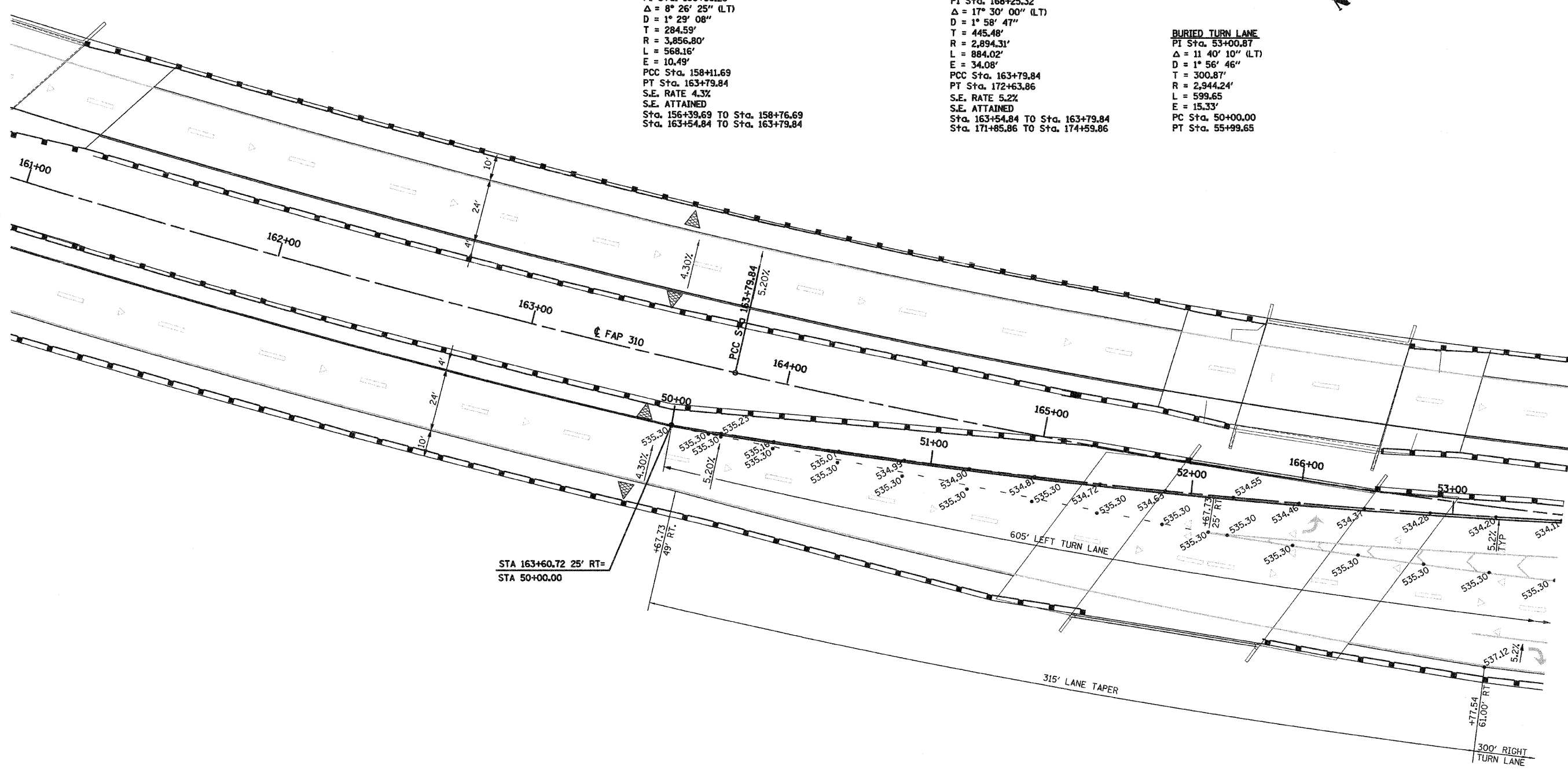

STA 163+60.72 25' RT=  
STA 50+00.00

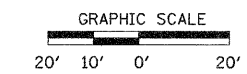

**NOTE:**  
1.) STATION/OFFSETS REFER TO MAINLINE STATIONING UNLESS OTHERWISE NOTED.  
2.) STATION/OFFSETS AND DIMENSIONS ARE TO EDGE OF PAVEMENT UNLESS OTHERWISE NOTED.

REVISIONS	
NAME	DATE

ILLINOIS DEPARTMENT OF TRANSPORTATION

### INTERSECTION DETAILS

#### F.A.P. 310 (US 67)

#### WITH LAGEMANN ROAD (CH 36)

SCALE: VERT. \_\_\_\_\_  
HORIZ. \_\_\_\_\_

DATE: 09-04-09

DRAWN BY: T.W.C.  
CHECKED BY: J.J.C.