

SE QUADRANT DAVIS LANE				
STATIONING ALONG F.A.P. RTE 310	OFFSET TO EOP FEET	EDGE OF PAVT ELEV FEET	STATIONING ALONG DAVIS LANE	OFFSET TO EOP FEET
201+36.10	49.00 LT	555.70	9+36.06	80.42 RT
201+46.05	49.83 LT	555.73	9+36.97	70.47 RT
201+64.86	56.35 LT	555.78	9+33.83	50.82 RT
201+82.06	70.43 LT	555.84	9+22.94	31.43 RT
201+86.59	76.58 LT	555.78	9+17.67	25.91 RT
201+94.41	94.89 LT	555.62	9+01.00	15.02 RT
201+95.82	114.74 LT	555.46	8+81.69	10.19 RT
201+95.23	119.19 LT	555.42	8+77.21	10.00 RT

SW QUADRANT DAVIS LANE				
STATIONING ALONG F.A.P. RTE 310	OFFSET TO EOP FEET	EDGE OF PAVT ELEV FEET	STATIONING ALONG DAVIS LANE	OFFSET TO EOP FEET
203+06.87	61.00 LT	557.48	9+53.90	89.84 LT
202+96.91	61.71 LT	557.32	9+51.47	80.15 LT
202+77.78	67.33 LT	556.98	9+42.62	62.30 LT
202+61.02	78.11 LT	556.49	9+29.09	47.66 LT
202+54.85	84.16 LT	556.31	9+22.06	42.64 LT
202+47.48	92.80 LT	556.23	9+12.27	36.88 LT
202+35.64	108.91 LT	556.10	8+94.35	28.01 LT
202+25.35	126.05 LT	555.84	8+75.68	20.86 LT
202+16.69	144.07 LT	555.35	8+56.43	15.46 LT
202+09.75	162.82 LT	554.80	8+36.76	11.88 LT
202+06.94	172.42 LT	554.52	8+26.83	10.78 LT
202+04.58	182.13 LT	554.22	8+16.87	10.15 LT
202+03.09	189.57 LT	553.98	8+09.32	10.00 LT

DAVIS LN
 PI Sta. 6+27.03
 $\Delta = 9^\circ 44' 51''$ (RT)
 $D = 2^\circ 30' 00''$
 $T = 195.42'$
 $R = 2,291.83'$
 $L = 389.91'$
 $E = 8.32'$
 PC Sta. 4+31.60
 PT Sta. 8+21.51
 S.E. RATE= 4.5%
 S.E. ATTAINED
 Sta. 3+47.60 TO Sta. 4+59.60
 Sta. 7+94.26 TO Sta. 9+06.26

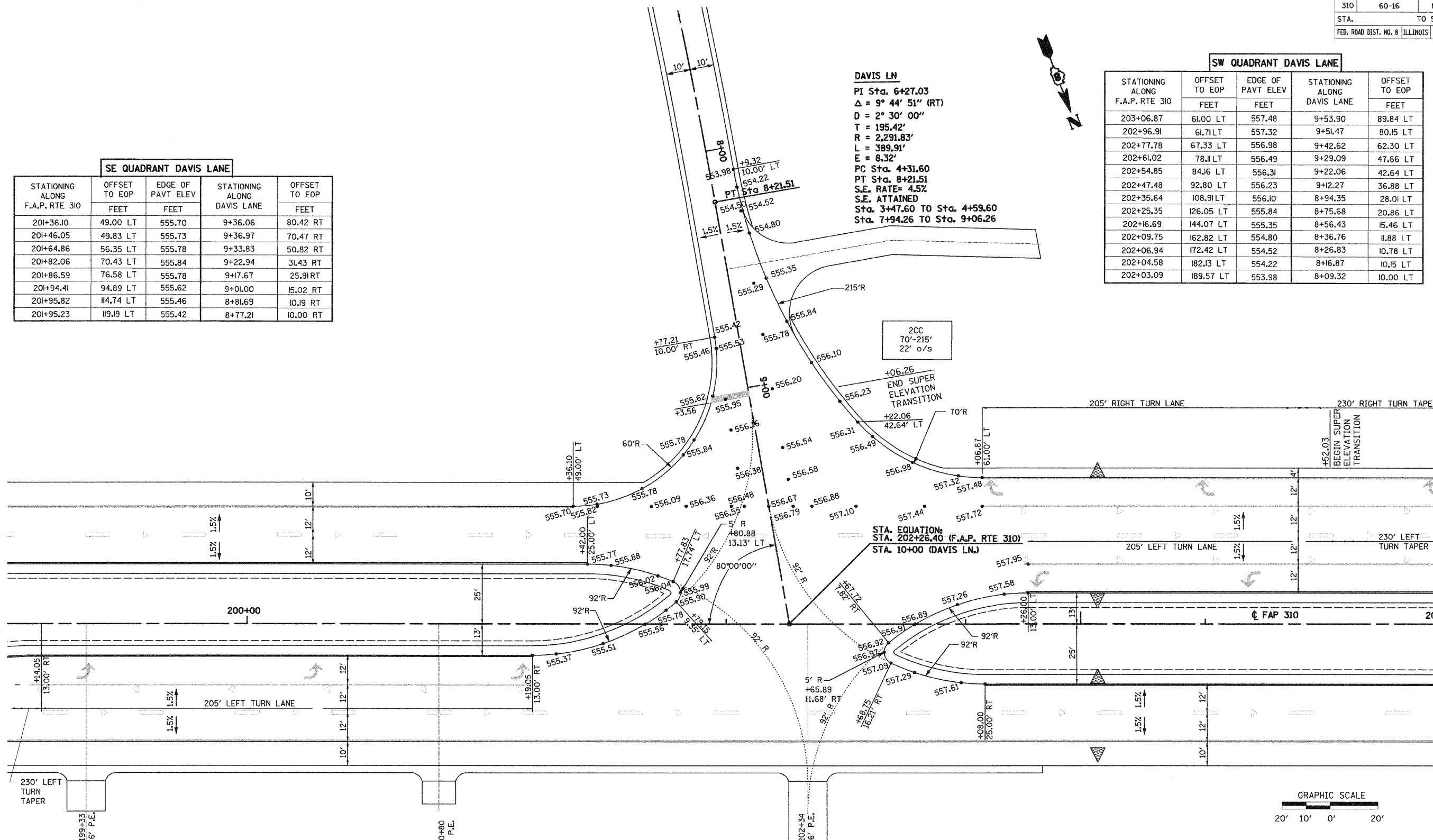

STA. EQUATION:
 STA. 202+26.40 (F.A.P. RTE 310)
 STA. 10+00 (DAVIS LN)

NOTE:
 1) STATION/OFFSETS REFER TO MAINLINE STATIONING UNLESS OTHERWISE NOTED.
 2) STATION/OFFSETS AND DIMENSIONS ARE TO EDGE OF PAVEMENT UNLESS OTHERWISE NOTED.

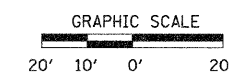

REVISIONS	
NAME	DATE

ILLINOIS DEPARTMENT OF TRANSPORTATION
INTERSECTION DETAILS
F.A.P. ROUTE 310 (US 67)
WITH DAVIS LANE (T.R. 16)
 SCALE: VERT. _____
 HORIZ. _____
 DATE : 09-04-09
 DRAWN BY : T.W.C.
 CHECKED BY : J.J.C.