

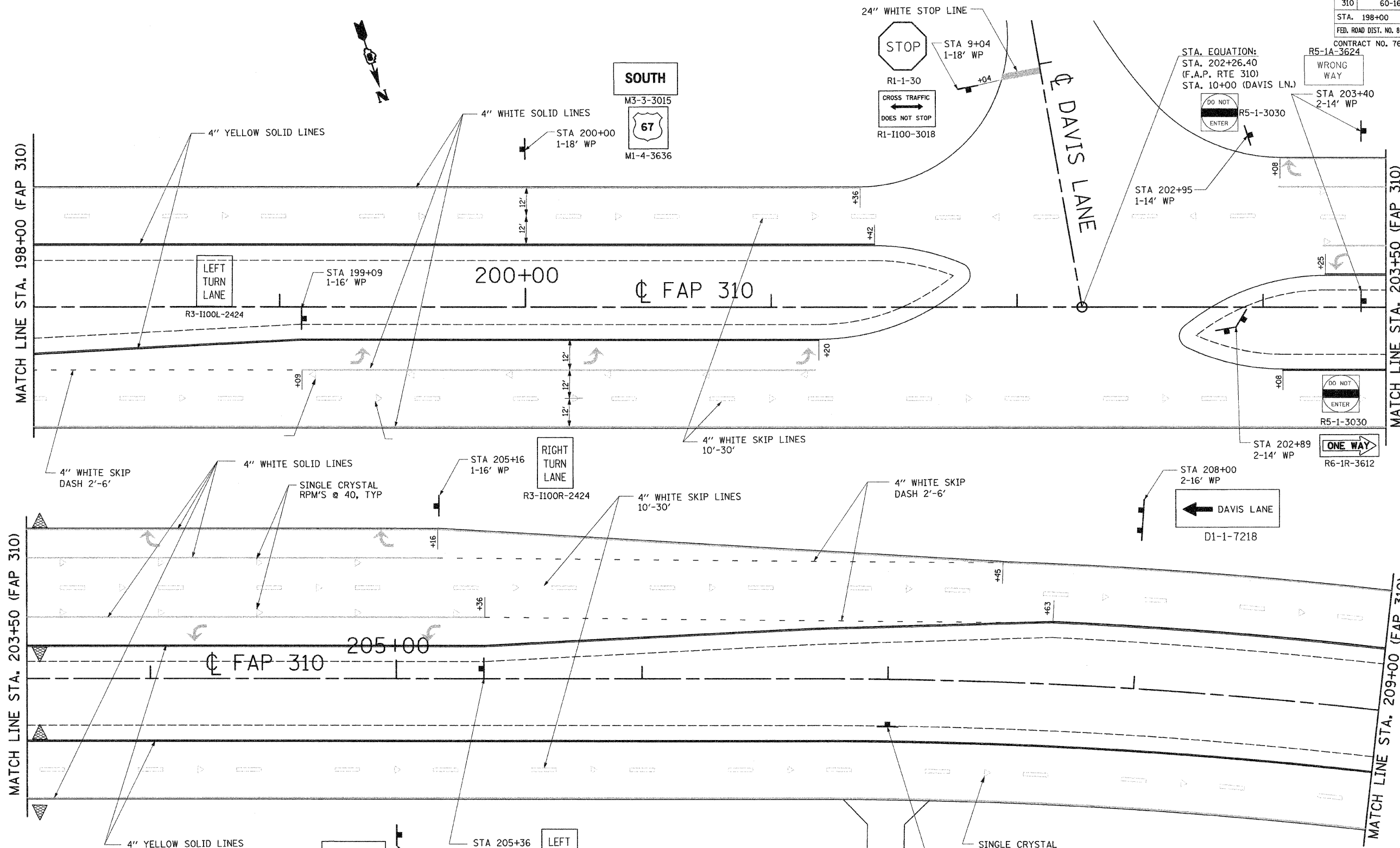

F.A.P. RTE.	SECTION	COUNTY	TOTAL SHEETS	SHEET NO.
310	60-16	MADISON	662	173
STA. 198+00		TO STA. 209+00		
FED. ROAD DIST. NO. 8 ILLINOIS FED. AID PROJECT				

CONTRACT NO. 76311



SOUTH

M3-3-3015



MI-4-3636

NORTH

M3-1-3015



MI-4-3636

- ▷ ONE-WAY CRYSTAL MARKER
- ▶ ONE-WAY AMBER MARKER
- ◆ TWO-WAY AMBER MARKER
- SEE STANDARD 781001 WP-WOOD POST
- ▲ THERMOPLASTIC PAVEMENT MARKING

ONE WAY



R6-2-1824

REVISIONS	
NAME	DATE

ILLINOIS DEPARTMENT OF TRANSPORTATION

SIGNING AND PAVEMENT MARKING PLANS

SCALE: VERT. _____
 HORIZ. _____

DATE: 09-04-09

DRAWN BY: U.J.
 CHECKED BY: J.J.C.

