

F.A.P. RTE.	SECTION	COUNTY	TOTAL SHEETS	SHEET NO.
310	60-16	MADISON	662	180
STA.		TO STA.		
FED. ROAD DIST. NO. 8 ILLINOIS		FED. AID PROJECT		
CONTRACT NO. 76311				

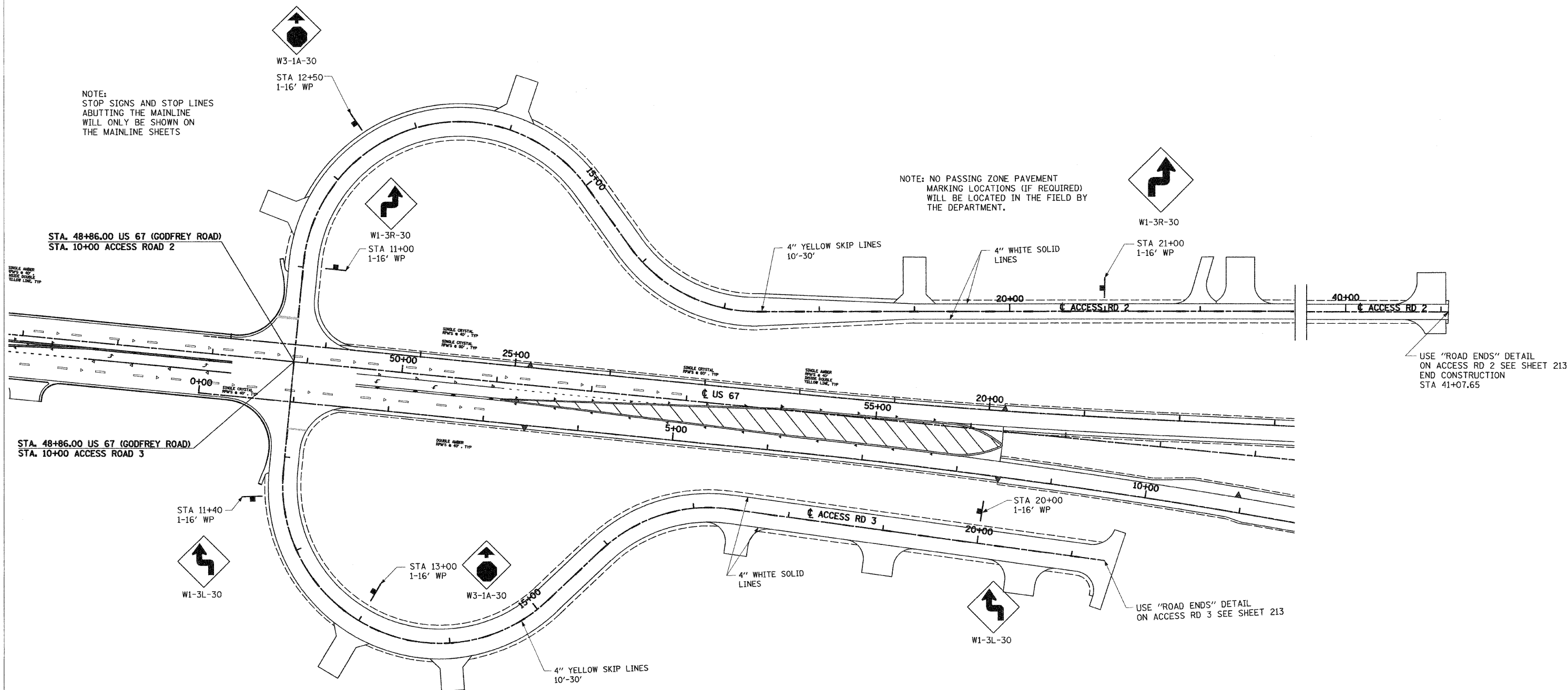

NOTE:
STOP SIGNS AND STOP LINES
ABUTTING THE MAINLINE
WILL ONLY BE SHOWN ON
THE MAINLINE SHEETS

NOTE: NO PASSING ZONE PAVEMENT
MARKING LOCATIONS (IF REQUIRED)
WILL BE LOCATED IN THE FIELD BY
THE DEPARTMENT.



USE "ROAD ENDS" DETAIL
ON ACCESS RD 2 SEE SHEET 213
END CONSTRUCTION
STA 41+07.65

USE "ROAD ENDS" DETAIL
ON ACCESS RD 3 SEE SHEET 213

REVISIONS	
NAME	DATE

ILLINOIS DEPARTMENT OF TRANSPORTATION
**SIGNING AND
PAVEMENT
MARKING PLANS**
SCALE: VERT. _____
HORIZ. _____
DATE : 09-04-09
DRAWN BY : U.J.
CHECKED BY : J.J.C.

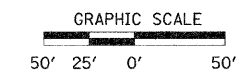

E:\21267\21267.dwg 9/22/2009 3:05:25 PM