

MCKINLEY AVE CURVE 1
 PI STA = 1+80.79
 $\Delta = 34^\circ 29' 34''$ (RT)
 D = 19' 05' 55"
 R = 300.00'
 T = 93.13'
 L = 180.60'
 E = 14.12'
 e = NC
 T.R. = N/A
 S.E. RUN = N/A
 PC STA = 0+87.66
 PT STA = 2+68.26

S CLINTON ST CURVE 1
 PI STA = 7+61.16
 $\Delta = 15^\circ 04' 25''$ (RT)
 D = 22' 28' 08"
 R = 255.00'
 T = 33.74'
 L = 67.09'
 E = 2.22'
 e = NC
 T.R. = N/A
 S.E. RUN = N/A
 PC STA = 7+27.42
 PT STA = 7+94.51

S CLINTON ST CURVE 2
 PI STA = 8+27.17
 $\Delta = 14^\circ 36' 02''$ (LT)
 D = 22' 28' 08"
 R = 255.00'
 T = 32.67'
 L = 64.98'
 E = 2.08'
 e = NC
 T.R. = N/A
 S.E. RUN = N/A
 PC STA = 7+94.51
 PT STA = 8+59.49

S CLINTON ST CURVE 3
 PI STA = 10+87.24
 $\Delta = 21^\circ 59' 37''$ (RT)
 D = 22' 28' 08"
 R = 255.00'
 T = 49.55'
 L = 97.88'
 E = 4.77'
 e = NC
 T.R. = N/A
 S.E. RUN = N/A
 PC STA = 10+37.69
 PT STA = 11+35.57

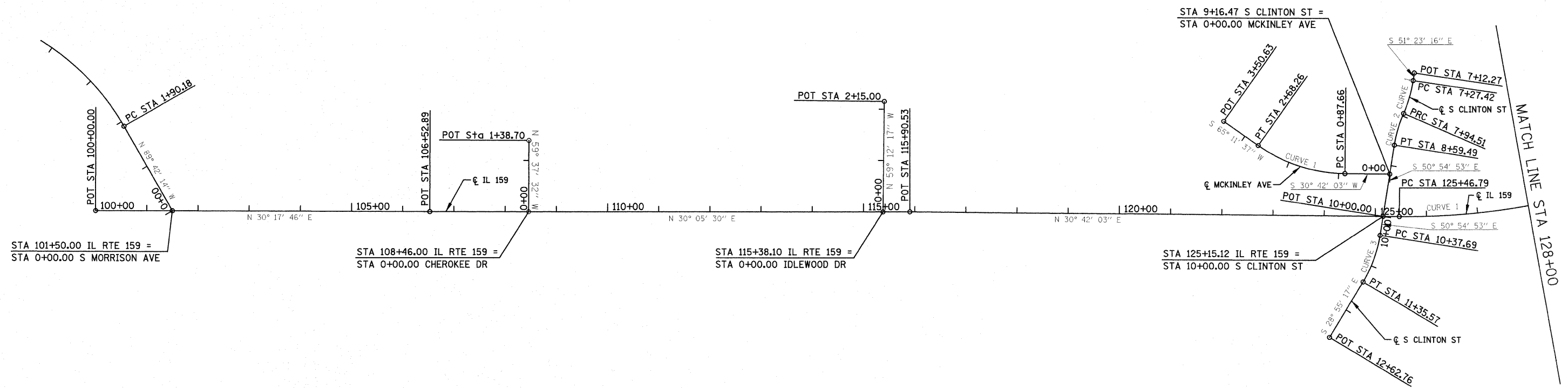

IL RTE 159 CURVE 1
 PI STA = 130+35.23
 $\Delta = 39^\circ 46' 51''$ (LT)
 D = 4' 14' 39"
 R = 1,350.00'
 T = 488.44'
 L = 937.31'
 E = 85.64'
 e = 3.50%
 T.R. = 73'
 S.E. RUN = 126'
 PC STA = 125+46.79
 PT STA = 134+84.11

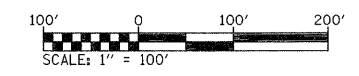

FILE NAME = P:\Projects\51350\1\CADD\DN\0876830-sh	USER NAME = default ATB.dgn	DESIGNED - DRAWN -	REVISED - REVISED -	STATE OF ILLINOIS DEPARTMENT OF TRANSPORTATION	PROPOSED ALIGNMENT			F.A.P. RTE 600	SECTION 60-(30,31,128)-1	COUNTY MADISON/ST. CLAIR	TOTAL SHEETS 399	SHEET NO. 53
PLOT SCALE = 100.0000' / IN.					CHECKED -	REVISED -	SCALE: 1" = 100'	SHEET NO. 1 OF 2 SHEETS		CONTRACT NO. 76830		
PLOT DATE = 4/30/2010					DATE -	REVISED -	STA 100+00.00 TO STA 128+00.00			FED. ROAD DIST NO. ILLINOIS FED. AID PROJECT		