

- KEY**
- ✕ TREES TO BE REMOVED
 - AS 2-1/2" TREE, ACER SACCHARUM (SUGAR MAPLE), 2-1/2" CALIPER, BALLED AND BURLAPPED
 - OP 2-1/2" TREE, QUERCUS PALUSTRIS (PIN OAK), 2-1/2" CALIPER, BALLED AND BURLAPPED
 - OR 2-1/2" TREE, QUERCUS RUBRA (RED OAK), 2-1/2" CALIPER, BALLED AND BURLAPPED
 - CC 2" TREE, CERCIS CANADENSIS (EASTERN REDBUD), 2" CALIPER, TREE FORM, BALLED AND BURLAPPED
 - MS 2" TREE, MALUS SNOWDRIFT (SNOWDRIFT CRAB APPLE), 2" CALIPER, TREE FORM, BALLED AND BURLAPPED
 - PS 3" EVERGREEN, PINUS STROBUS (EASTERN WHITE PINE), 3" CALIPER, BALLED AND BURLAPPED

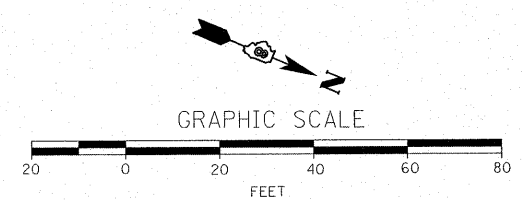
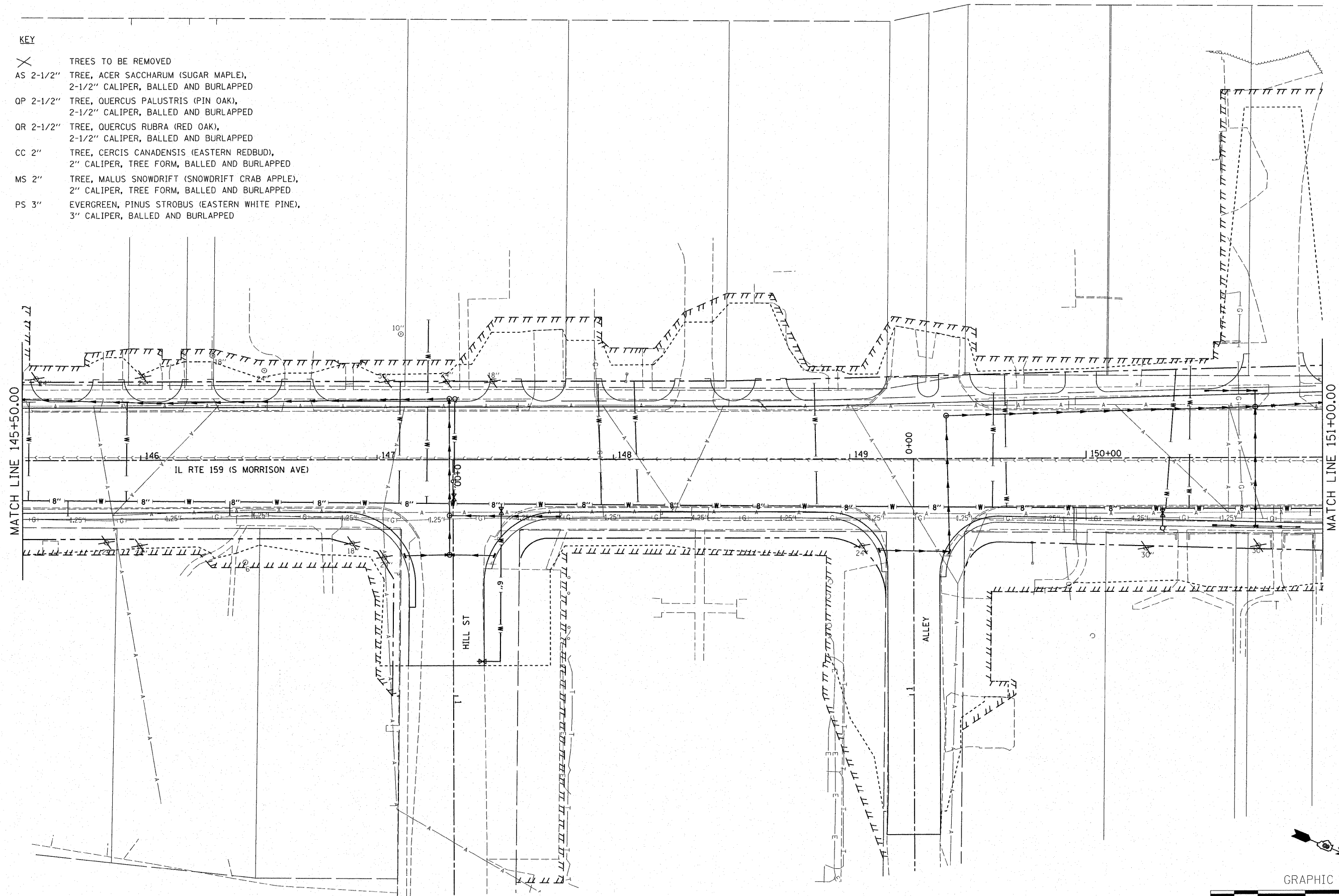

FILE NAME = D876830-sht-1ndscp.dgn

USER NAME = cha
 PLOT SCALE = 1:20
 PLOT DATE = 8/24/2009

DESIGNED -
 DRAWN -
 CHECKED -
 DATE -

REVISED -
 REVISED -
 REVISED -
 REVISED -

**STATE OF ILLINOIS
 DEPARTMENT OF TRANSPORTATION**

LANDSCAPE PLAN
 SCALE: 1:20 SHEET NO. OF SHEETS STA. 145+50.00 TO STA. 151+00.00

F.A. RTE.	SECTION	COUNTY	TOTAL SHEETS	SHEET NO.
600	60-(30,31,128)-1		399	237
CONTRACT NO. 76830				
FED. ROAD DIST. NO. ILLINOIS FED. AID PROJECT				