

DATE	
BY	
FINAL SURVEY	
SURVEYED	
NOTE BOOK	
TEMPLATE	
AREAS CHECKED	
NO.	

DATE	
BY	
ORIGINAL SURVEY	
SURVEYED	
NOTE BOOK	
TEMPLATE	
AREAS CHECKED	
NO.	

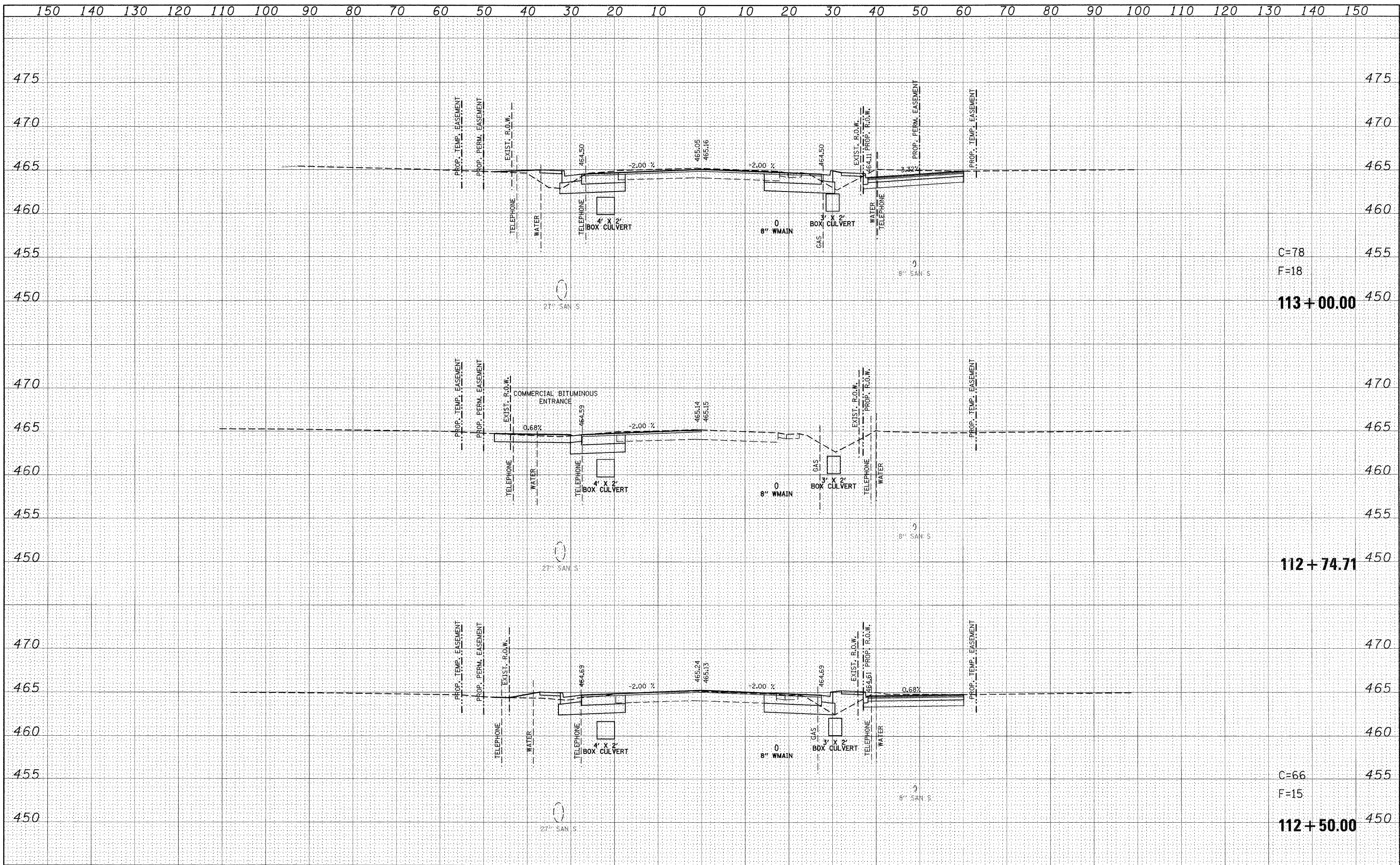

C=78
F=18
113+00.00

112+74.71

C=66
F=15
112+50.00

FILE NAME =	USER NAME = default	DESIGNED -	REVISED -	STATE OF ILLINOIS DEPARTMENT OF TRANSPORTATION	IL ROUTE 159 MAINLINE CROSS SECTIONS			F.A.P. RTE.	SECTION	COUNTY	TOTAL SHEETS	SHEET NO.
ps\projects\1513501\cadd\dgn\d876830-shr-ssht-115.dgn		DRAWN -	REVISED -		600	60-(30,31,128)-1	ST. CLAIR/MADISON	399	292			
PLOT SCALE = 10,0000' / IN.		CHECKED -	REVISED -		SCALE: SHEET NO. 13 OF 120 SHEETS STA. 112+50.00 TO STA. 113+00.00			CONTRACT NO. 76830				
PLOT DATE = 8/24/2009		DATE -	REVISED -		ILLINOIS FED. AID PROJECT							