

FINAL SURVEY	DATE
SURVEYED	
NOTE BOOK	
NO.	
AREAS CHECKED	

ORIGINAL SURVEY	DATE
SURVEYED	
NOTE BOOK	
NO.	
AREAS CHECKED	

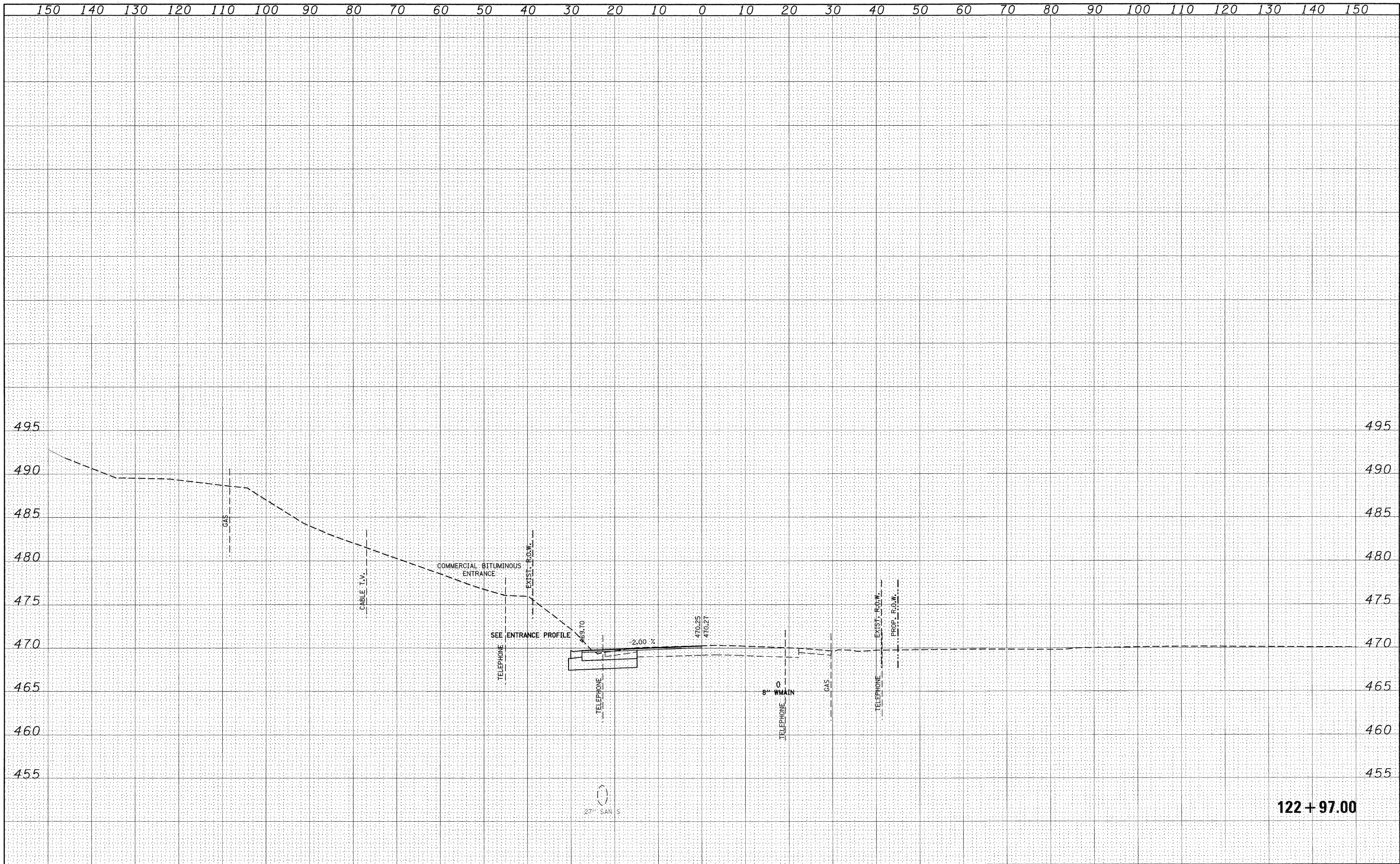

122 + 97.00

FILE NAME =	USER NAME = default	DESIGNED -	REVISED -	STATE OF ILLINOIS DEPARTMENT OF TRANSPORTATION	IL ROUTE 159 MAINLINE CROSS SECTIONS		F.A.P. RTE.	SECTION	COUNTY	TOTAL SHEETS	SHEET NO.	
p:\projects\513581\cadd\dgn\d876830-sht-xshs-1	L159.dgn	DRAWN -	REVISED -		SCALE:	SHEET NO. 26 OF 120 SHEETS	STA. 122+97.00 TO STA. 122+97.00	600	60-(30,31,128)-1	ST. CLAIR/MADISON	399	305
	PLOT SCALE = 10,0000' / IN.	CHECKED -	REVISED -		CONTRACT NO. 76830							
	PLOT DATE = 8/24/2009	DATE -	REVISED -		ILLINOIS FED. AID PROJECT							