

FINAL SURVEY	DATE
BY	
NO. CHECKED	
NO. CHECKED	

ORIGINAL SURVEY	DATE
BY	
NO. CHECKED	
NO. CHECKED	

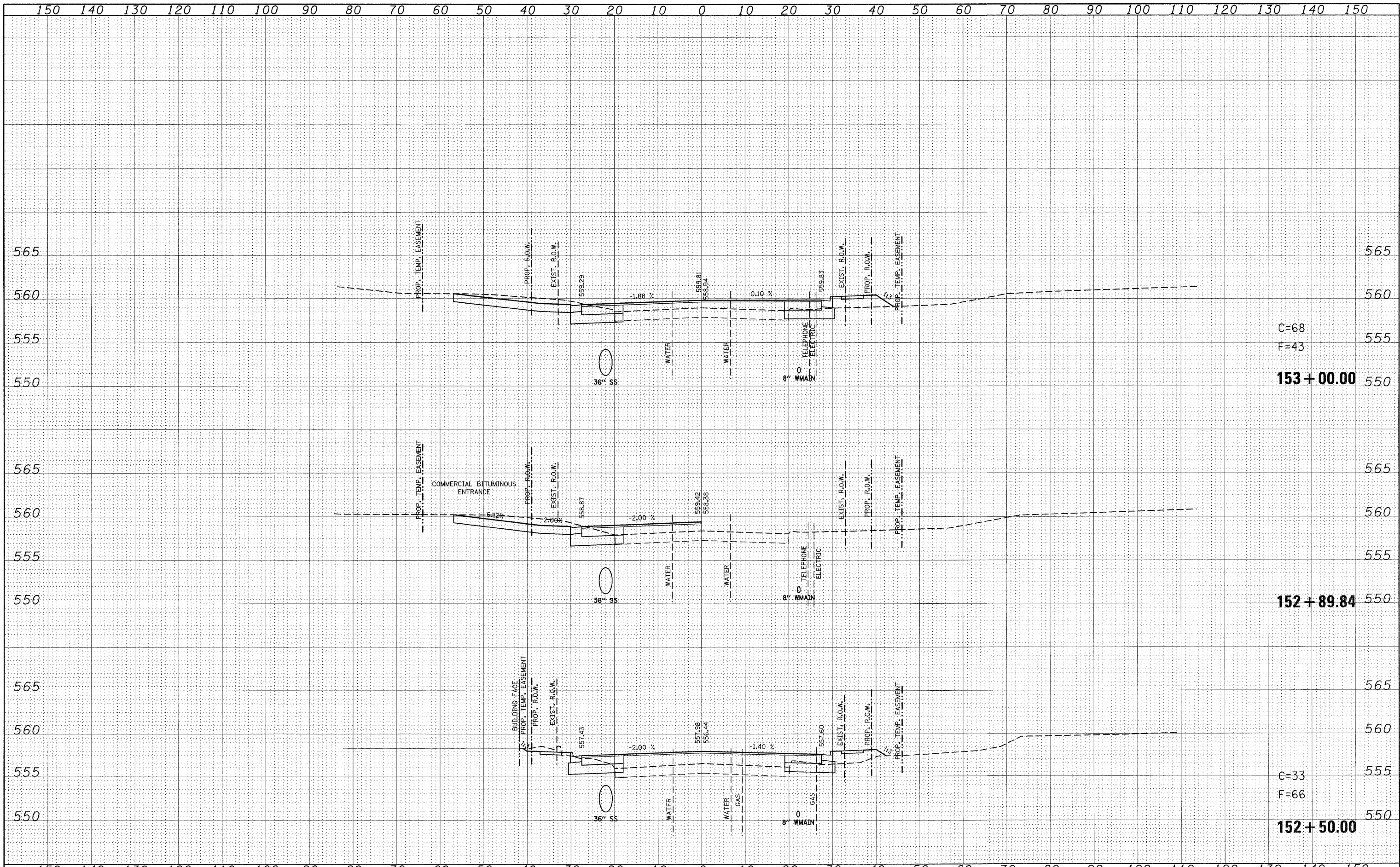

FILE NAME =	USER NAME = default	DESIGNED -	REVISED -	STATE OF ILLINOIS DEPARTMENT OF TRANSPORTATION				IL ROUTE 159 MAINLINE CROSS SECTIONS				F.A.P. RTE.	SECTION	COUNTY	TOTAL SHEETS	SHEET NO.
pt\projects\1513581\cadd\dgn\d876838-sht-xssht-1	159.dgn	DRAWN -	REVISED -					SCALE:	SHEET NO. 67 OF 120 SHEETS	STA. 152+50.00	TO STA. 153+00.00	600	60-(30,31,128)-1	ST. CLAIR/MADISON	399	346
	PLOT SCALE = 1/8" = 10.0000' / IN.	CHECKED -	REVISED -					CONTRACT NO. 76830				ILLINOIS FED. AID PROJECT				
	PLOT DATE = 8/24/2009	DATE -	REVISED -													