

150 140 130 120 110 100 90 80 70 60 50 40 30 20 10 0 10 20 30 40 50 60 70 80 90 100 110 120 130 140 150

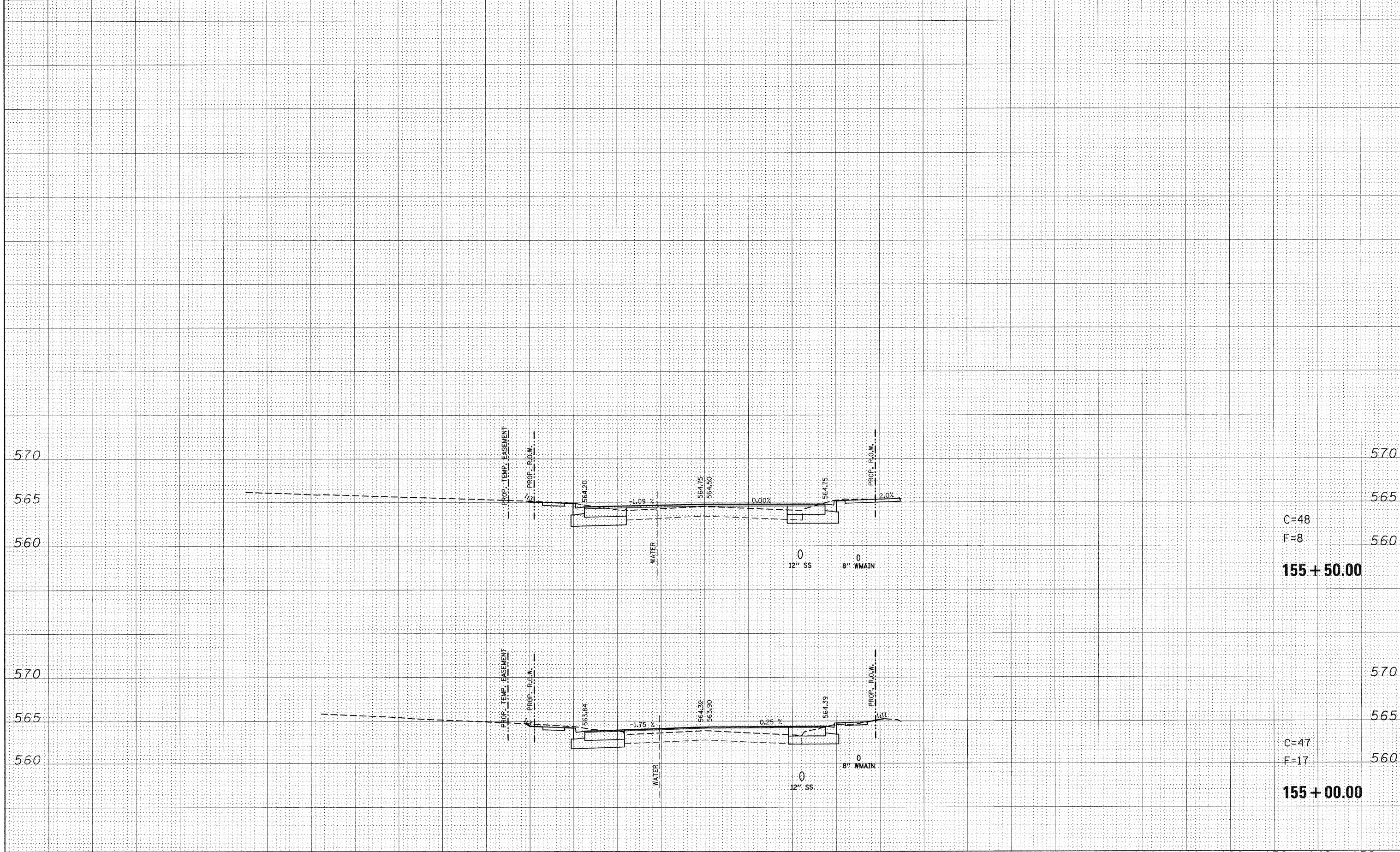

150 140 130 120 110 100 90 80 70 60 50 40 30 20 10 0 10 20 30 40 50 60 70 80 90 100 110 120 130 140 150

FILE NAME = P:\Projects\513501\CADD\GDN\d876830-sht-xssht-159.dgn  
 USER NAME = default  
 PLOT SCALE = 10.0000' / 1" IN.  
 PLOT DATE = 12/17/2009

DESIGNED -  
 DRAWN -  
 CHECKED -  
 DATE -

REVISED -  
 REVISED -  
 REVISED -  
 REVISED -

STATE OF ILLINOIS  
 DEPARTMENT OF TRANSPORTATION

Rev  
 IL ROUTE 159  
 MAINLINE CROSS SECTIONS

SCALE: SHEET NO. 69 OF 120 SHEETS STA. 155+00.00 TO STA. 156+00.00

F.A.P. RTE.	SECTION	COUNTY	TOTAL SHEETS	SHEET NO.
600	60-(30,31,128)-1	ST. CLAIR/MADISON	399	348
ILLINOIS FED. AID PROJECT			CONTRACT NO. 76830	

FINAL SURVEY	SURVEYED	BY	DATE
NOTE BOOK	PLOTTED		
NO.	TEMPLATE		
	AREA CHECKED		

ORIGINAL SURVEY	SURVEYED	BY	DATE
NOTE BOOK	PLOTTED		
NO.	TEMPLATE		
	AREA CHECKED		

C=48  
 F=8  
**155 + 50.00**

C=47  
 F=17  
**155 + 00.00**