

BY	DATE
FINAL SURVEY	SURVEYED
NOTE BOOK NO.	PLOTTED
	TEMPLATE
	AREAS CHECKED

BY	DATE
ORIGINAL SURVEY	SURVEYED
NOTE BOOK NO.	PLOTTED
	TEMPLATE
	AREAS CHECKED

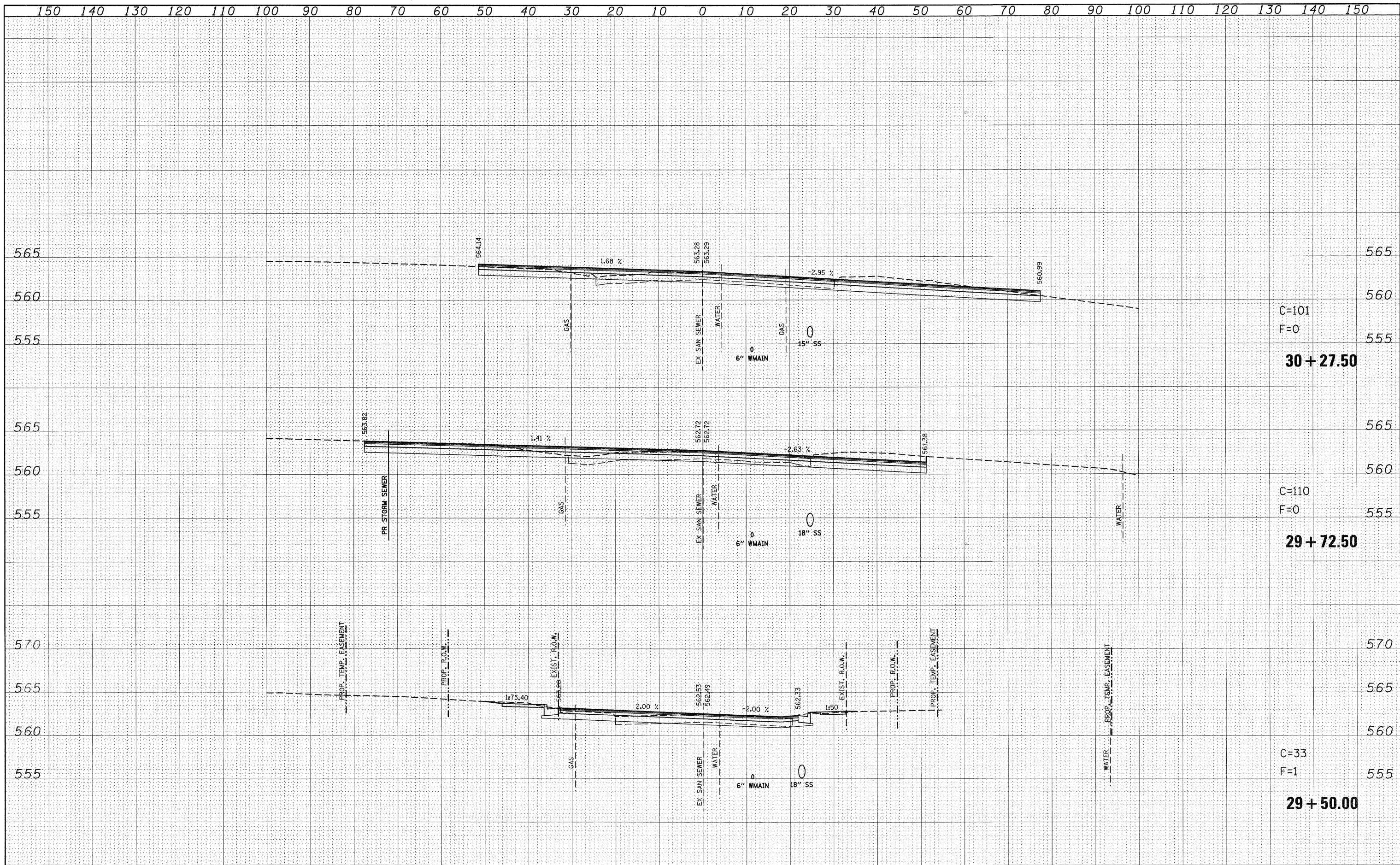

FILE NAME = P:\Projects\513501\CADD\DDN\d876830-shr-xssht-0	USER NAME = default	DESIGNED -	REVISED -	STATE OF ILLINOIS DEPARTMENT OF TRANSPORTATION	E. CHURCH ST SIDE ROAD CROSS SECTIONS		F.A.P. RTE. 600	SECTION 60-(30,31,128)-1	COUNTY ST. CLAIR/MADISON	TOTAL SHEETS 399	SHEET NO. 395	
PLOT SCALE = 10.0000' / IN.	PLotted	DRAWN -	REVISED -		SCALE:	SHEET NO. 116 OF 120 SHEETS	STA. 29+50.00 TO STA. 30+27.50	CONTRACT NO. 76830		ILLINOIS FED. AID PROJECT		
PLOT DATE = 8/25/2009		CHECKED -	REVISED -									
		DATE -	REVISED -									