

CONDUIT TRANSVERSING "STEEP SIDE SLOPE" AREAS WILL BE AVOIDED TO LIMIT EROSION. CONDUIT WILL RUN DOWN THE SIDE SLOPE (TOWARD) THE TOE OF THE SLOPE, RUN ALONG THE TOE (NEAR THE TOE) OF THE SLOPE, AND THEN STRAIGHT UP THE SIDE SLOPE. THE CONTRACTOR MAY BE DIRECTED BY THE ENGINEER TO USE THIS PROCEDURE AT ADDITIONAL LOCATIONS.

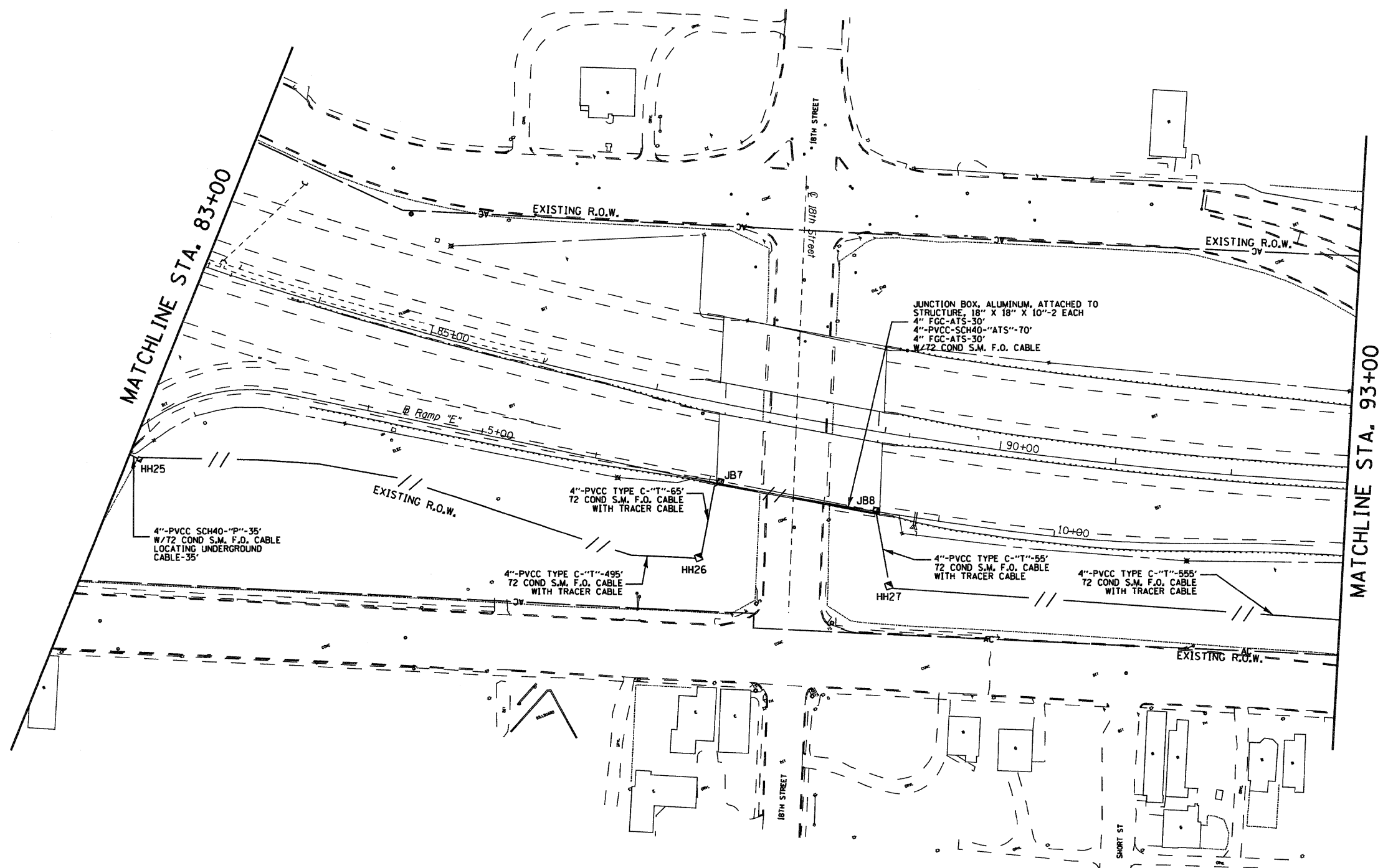

EB 1-64
 STA. 83+00 TO
 STA. 93+00
 SHEET 6 OF 15

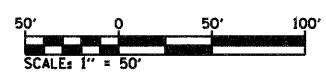

FILE NAME =	USER NAME = prestonne	DESIGNED -	REVISED -	STATE OF ILLINOIS DEPARTMENT OF TRANSPORTATION	ITS PLAN		F.A.I. RTE. =	SECTION	COUNTY	TOTAL SHEETS	SHEET NO.
cl:\pw\work\p\widot\prestonne\dms67883\8876c36-shr-itsplan.dgn		DRAWN -	REVISED -		64	DIST 8 ITS 2010-1	ST. CLAIR	34	19		
PLOT SCALE = 100.0000' / IN.		CHECKED -	REVISED -		SCALE: _____ SHEET NO. ____ OF ____ SHEETS STA. _____ TO STA. _____		FED. ROAD DIST. NO. _____ ILLINOIS FED. AID PROJECT		CONTRACT NO. 76C36		
PLOT DATE = 3/14/2010		DATE -	REVISED -								