

**STAGE 1 TRAFFIC CONTROL ITEMS**

IMPACT ATTENUATORS, TEMPORARY	TEMPORARY CONCRETE BARRIER	4" MARKING	8" MARKING	12" MARKING	WORK ZONE PAVEMENT MARKING REMOVAL	TEMPORARY INFORMATION SIGNING	AGGREGATE BASE COURSE, TYPE A, 12"	HMA SURFACE COURSE, MIX "D", N70	HMA BINDER COURSE, IL-19.0, N70
EACH	FOOT	FOOT	FOOT	FOOT	SQ FT	SQ FT	SQ YD	TON	TON
6	3430	12849	476	766	3025	490	810	79	427

**PAVEMENT MARKING LAYOUT-STAGE 1**

	ROADWAY	STATION	OFFSET
1	WB I-64	107+35.23	0.00' RT
2	WB I-64	104+11.77	32.00' RT
3	WB I-64	103+61.11	43.92' RT
4	WB I-64	102+65.20	47.80' RT
5	EB I-64	39+42.84	22.75' RT
175	WB I-64	105+15.26	1.00' LT
8	EB I-64	41+62.98	19.54' RT
9	EB I-64	41+81.72	0.39' LT
13	EB I-64	45+35.55	1.18' RT
20	WB I-64	92+40.39	1.00' LT
21	EB I-64	51+20.71	1.00' LT
22	WB I-64	89+11.35	1.00' LT
23	BAUGH AVE	7+07.27	41.03' LT
24	BAUGH AVE	5+86.47	11.72' LT
25	BAUGH AVE	5+88.23	0.02' LT
26	BAUGH AVE	5+55.84	18.75' LT
27	BAUGH AVE	5+15.65	5.39' LT
28	BAUGH AVE	110+16.20	5.58' RT
186	BAUGH AVE	111+19.99	5.75' RT
187	BAUGH AVE	115+82.06	5.75' RT
29	ST. CLAIR AVE	39+35.84	78.13' RT
30	ST. CLAIR AVE	37+85.90	42.08' RT
31	ST. CLAIR AVE	36+08.55	9.31' RT
32	ST. CLAIR AVE	35+39.30	9.27' RT
33	ST. CLAIR AVE	33+01.10	9.14' RT
34	ST. CLAIR AVE	30+22.44	9.14' RT
38	WB I-64	87+22.21	32.00' RT
39	WB I-64	85+00.63	35.88' RT
40	EB I-64	55+17.76	1.00' LT
41	EB I-64	57+74.62	0.60' LT
42	ST. CLAIR AVE	29+39.80	75.04' RT
43	ST. CLAIR AVE	29+09.96	135.90' RT
44	EB I-64	59+92.66	0.03' LT
188	RAMP E	10+83.81	13.47' RT

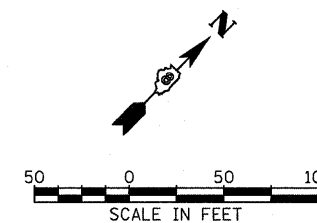
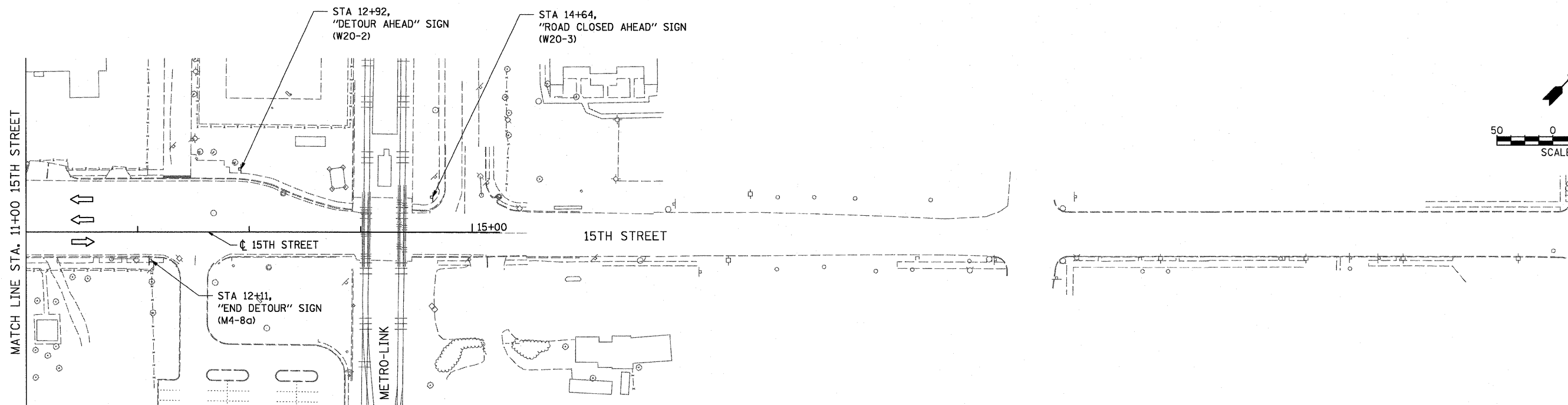
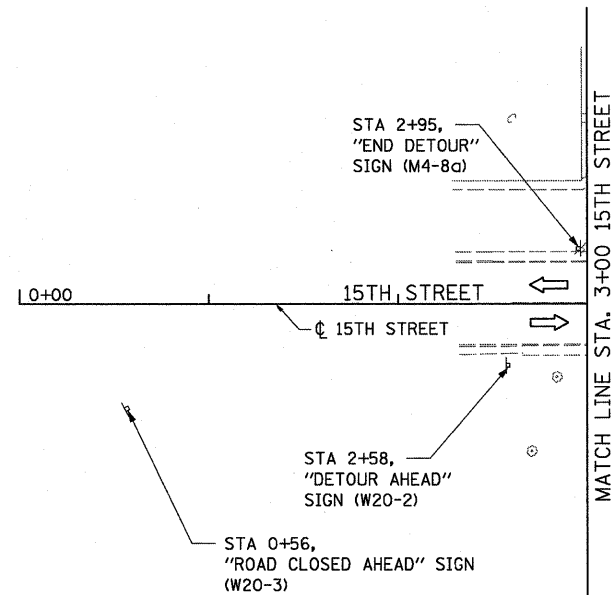
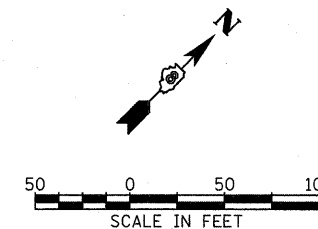

FILE NAME =	USER NAME = IDOT	DESIGNED - TTB	REVISED -	<b>STATE OF ILLINOIS DEPARTMENT OF TRANSPORTATION</b>	<b>SUGGESTED STAGES OF CONSTRUCTION AND TRAFFIC CONTROL - STAGE 1</b>		F.A.I. RTE.	SECTION	COUNTY	TOTAL SHEETS	SHEET NO.		
#FILE#		DRAWN - TTB	REVISED -				64	82-1-2HB	ST. CLAIR	345	79		
		CHECKED - JAH	REVISED -				SCALE: 1" = 50'		SHEET NO. 4 OF 4 SHEETS		STA. XX+XX TO STA. XX+XX		CONTRACT NO. 76C49
		DATE - 3/19/2010	REVISED -				FED. ROAD DIST. NO.		ILLINOIS FED. AID PROJECT				