

STATE OF ILLINOIS
DEPARTMENT OF TRANSPORTATION

Notes:
See sheet 15 of 44 for Sections C-C & D-D.
Bars indicated thus 46 x 2-#5 etc. indicates 46 lines of bars with 2 lengths per line.

*** Cost included with Concrete Superstructure.

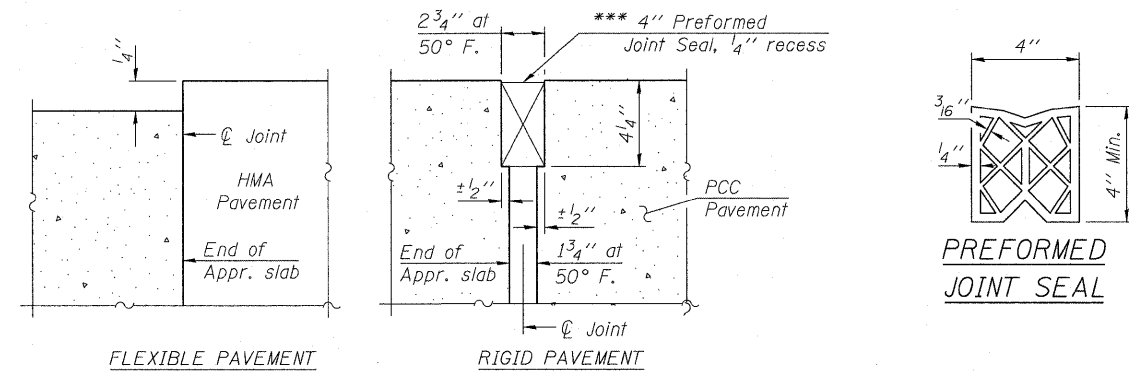

DETAIL A

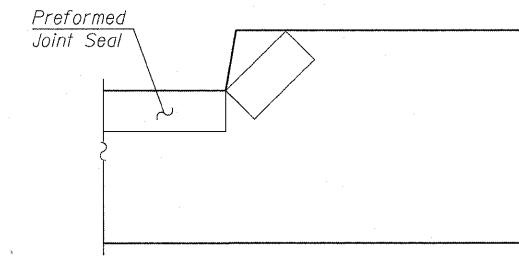

VIEW F-F

Angle Preformed Joint Seal at 45°
at curbs when req'd for drainage.

MIN. BAR LAPS

- #4 bar = 1'-8"
- #5 bar = 2'-2"
- #6 bar = 2'-7"

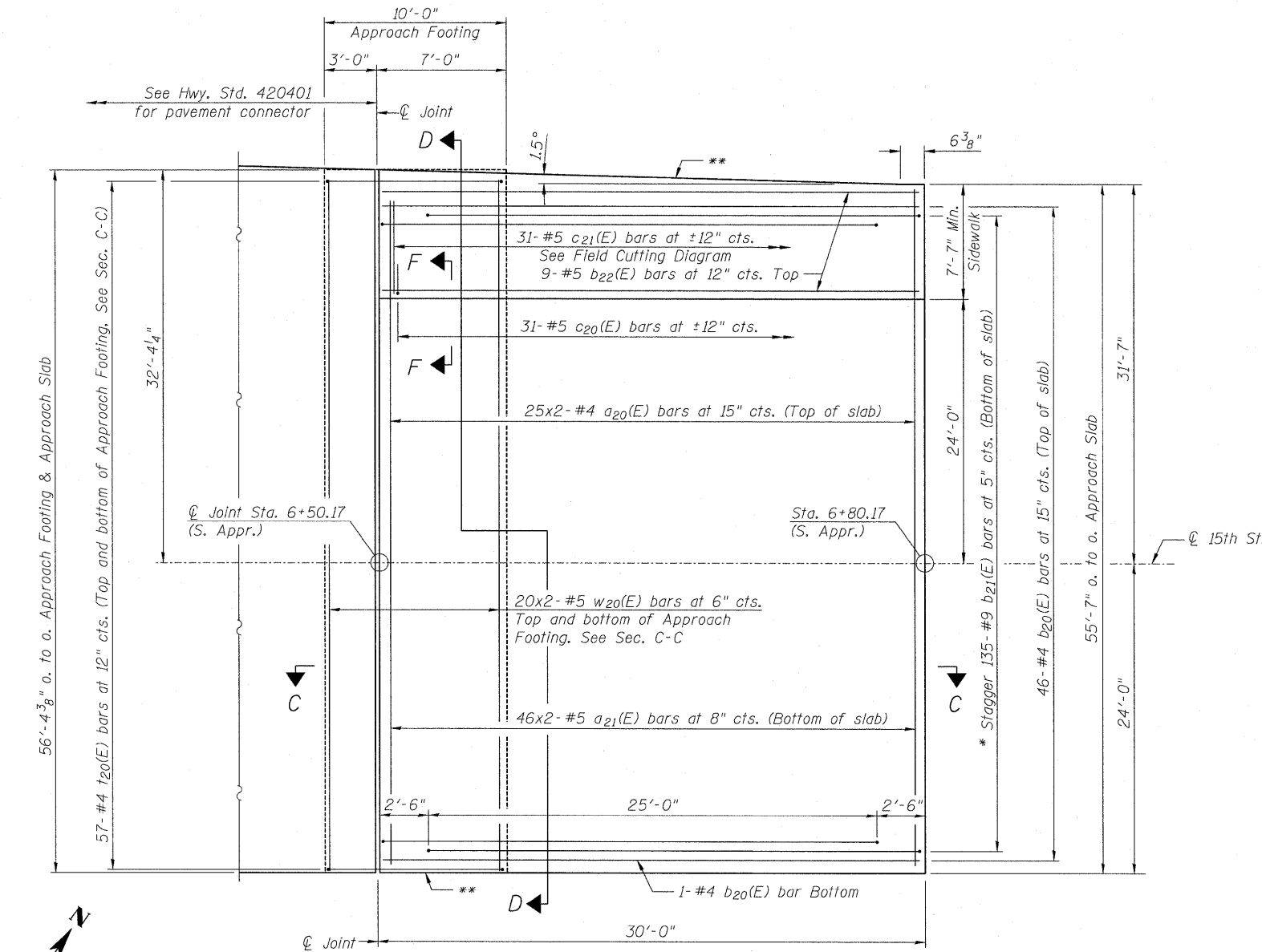

PLAN

* Tilt #9 b₂₁(E) bars as required to maintain clearance.
** Closed cell joint filler according to Article 1051.08 of the Standard Specifications, full depth of slab and sidewalk, full length of wingwall parapet. Cost included with Concrete Superstructure.

ZROKA engineering
Zroka Engineering, P.C.
4216 North Hermitage
Chicago, IL 60613

| | |
|----------|-----|
| DESIGNED | LAS |
| CHECKED | JLA |
| DRAWN | SAW |
| CHECKED | LAS |

3-31-2010

SOUTH BRIDGE APPROACH SLAB DETAILS 1
STRUCTURE NO. 082-0377

| | | | | | |
|---------------------------|----------------|----------|--------------------|-----------------|--------------|
| SHEET NO. 14 44 SHEETS | F.A.I. RTE. | SECTION | COUNTY | TOTAL SHEETS | SHEET NO. |
| | 64 | 82-1-2HB | ST. CLAIR | 345 | 221 |
| | | | CONTRACT NO. 76C49 | | |
| ILLINOIS FED. AID PROJECT | | | | | |

Revised 4/15/2010