

DATE	
BY	
FINAL SURVEY	
SURVEY	
NOTE BOOK	
TEMPLATE	
AREAS CHECKED	
NO.	

DATE	
BY	
ORIGINAL SURVEY	
SURVEY	
NOTE BOOK	
TEMPLATE	
AREAS CHECKED	
NO.	

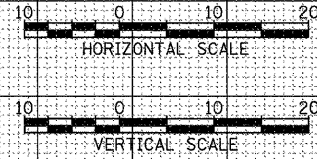
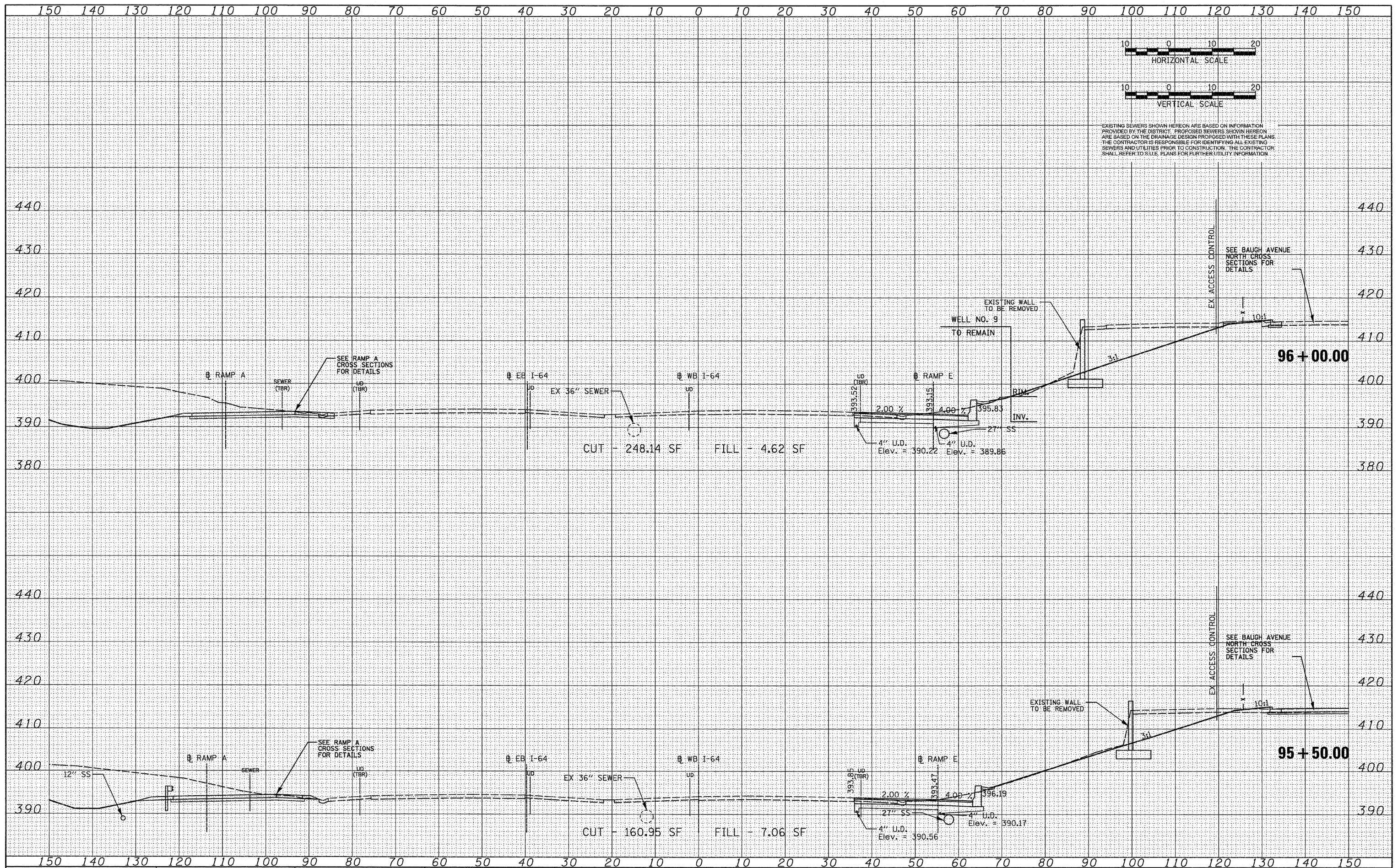

EXISTING SEWERS SHOWN HEREON ARE BASED ON INFORMATION PROVIDED BY THE DISTRICT. PROPOSED SEWERS SHOWN HEREON ARE BASED ON THE DRAINAGE DESIGN PROPOSED WITH THESE PLANS. THE CONTRACTOR IS RESPONSIBLE FOR IDENTIFYING ALL EXISTING SEWERS AND UTILITIES PRIOR TO CONSTRUCTION. THE CONTRACTOR SHALL REFER TO BLUE PLANS FOR FURTHER UTILITY INFORMATION.

FILE NAME = DBTRI-76C49-sh\_t.XS\_64WB.dgn

USER NAME = IDOT

DESIGNED - TTB

DRAWN - GDO

CHECKED - JAH

DATE - 3/19/2010

REVISED -

REVISED -

REVISED -

REVISED -

**STATE OF ILLINOIS**  
**DEPARTMENT OF TRANSPORTATION**

**CROSS SECTIONS - WB I-64**

SCALE: 1" = 10'      SHEET NO. 6 OF 16 SHEETS      STA. 95+50.00 TO STA. 96+00.00

F.A. RTE.	SECTION	COUNTY	TOTAL SHEETS	SHEET NO.
64	82-1-2HB	ST. CLAIR	345	297
CONTRACT NO. 76C49				

FED. ROAD DIST. NO.      ILLINOIS FED. AID PROJECT