

DATE	
BY	
FINAL SURVEY	
SURVEY	
NOTE BOOK	
NO.	
TEMPLATES	
AREAS CHECKED	

DATE	
BY	
ORIGINAL SURVEY	
SURVEY	
NOTE BOOK	
NO.	
TEMPLATES	
AREAS CHECKED	

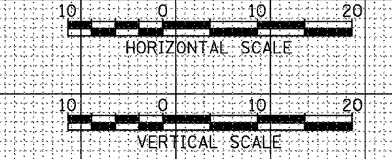
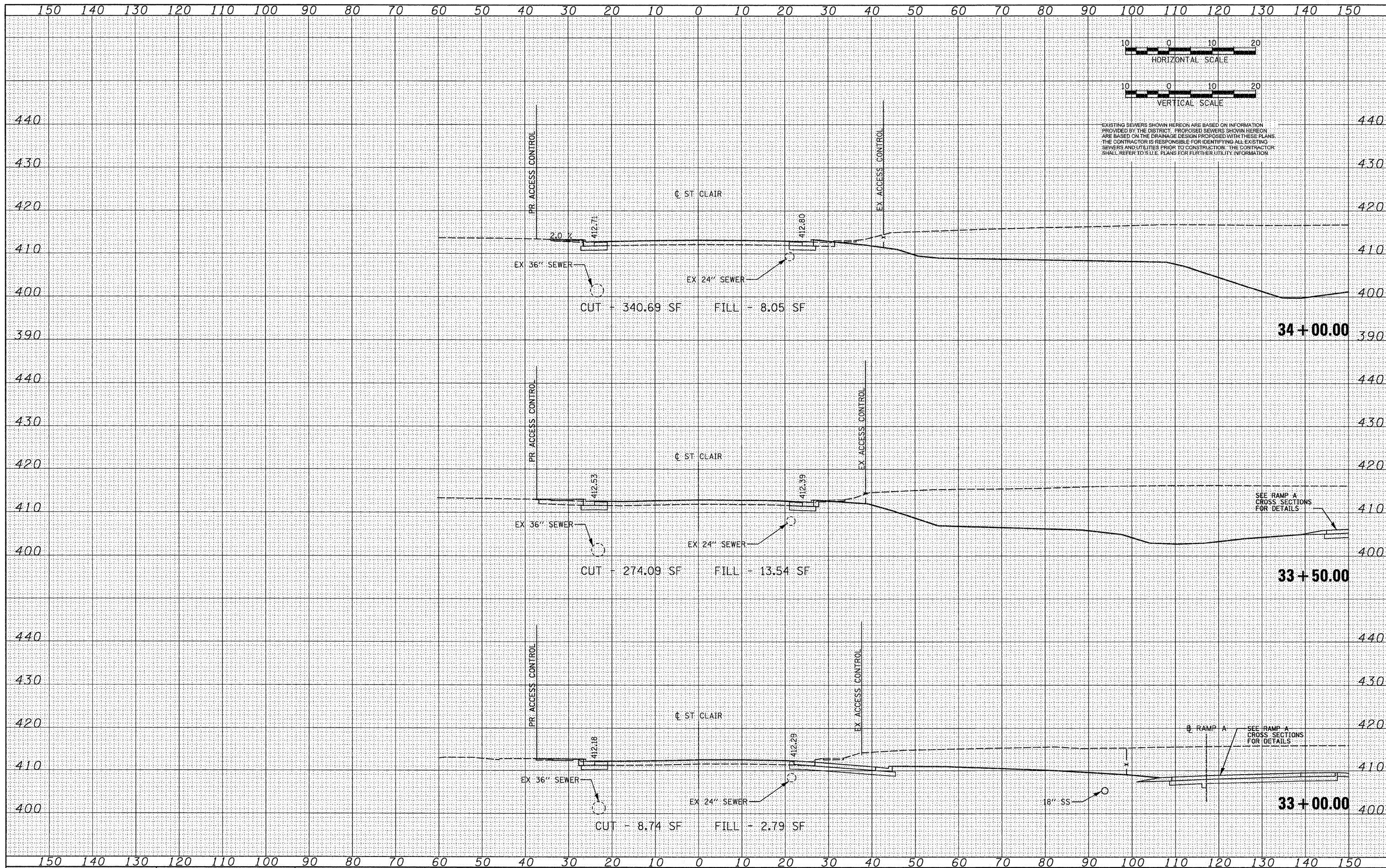

EXISTING SEWERS SHOWN HEREON ARE BASED ON INFORMATION PROVIDED BY THE DISTRICT. PROPOSED SEWERS SHOWN HEREON ARE BASED ON THE DRAINAGE DESIGN PROPOSED WITH THESE PLANS. THE CONTRACTOR IS RESPONSIBLE FOR IDENTIFYING ALL EXISTING SEWERS AND UTILITIES PRIOR TO CONSTRUCTION. THE CONTRACTOR SHALL REFER TO S.U.E. PLANS FOR FURTHER UTILITY INFORMATION.

FILE NAME = DBTRI-76C49-ahc.XS-StClair.dgn

USER NAME = IDOT
 DESIGNED - TTB
 DRAWN - GDO
 CHECKED - JAH
 DATE - 3/19/2010

REVISED -
 REVISED -
 REVISED -
 REVISED -

**STATE OF ILLINOIS
 DEPARTMENT OF TRANSPORTATION**

CROSS SECTIONS - ST CLAIR AVENUE

SCALE: 1" = 10' SHEET NO. 4 OF 10 SHEETS STA. 33+00.00 TO STA. 34+00.00

F.A. RTE.	SECTION	COUNTY	TOTAL SHEETS	SHEET NO.
64	82-1-2HB	ST. CLAIR	345	321
CONTRACT NO. 76C49				

FED. ROAD DIST. NO. ILLINOIS FED. AID PROJECT