

DATE	
BY	
FINAL SURVEY	
NOTE BOOK	
NO.	

DATE	
BY	
ORIGINAL SURVEY	
NOTE BOOK	
NO.	

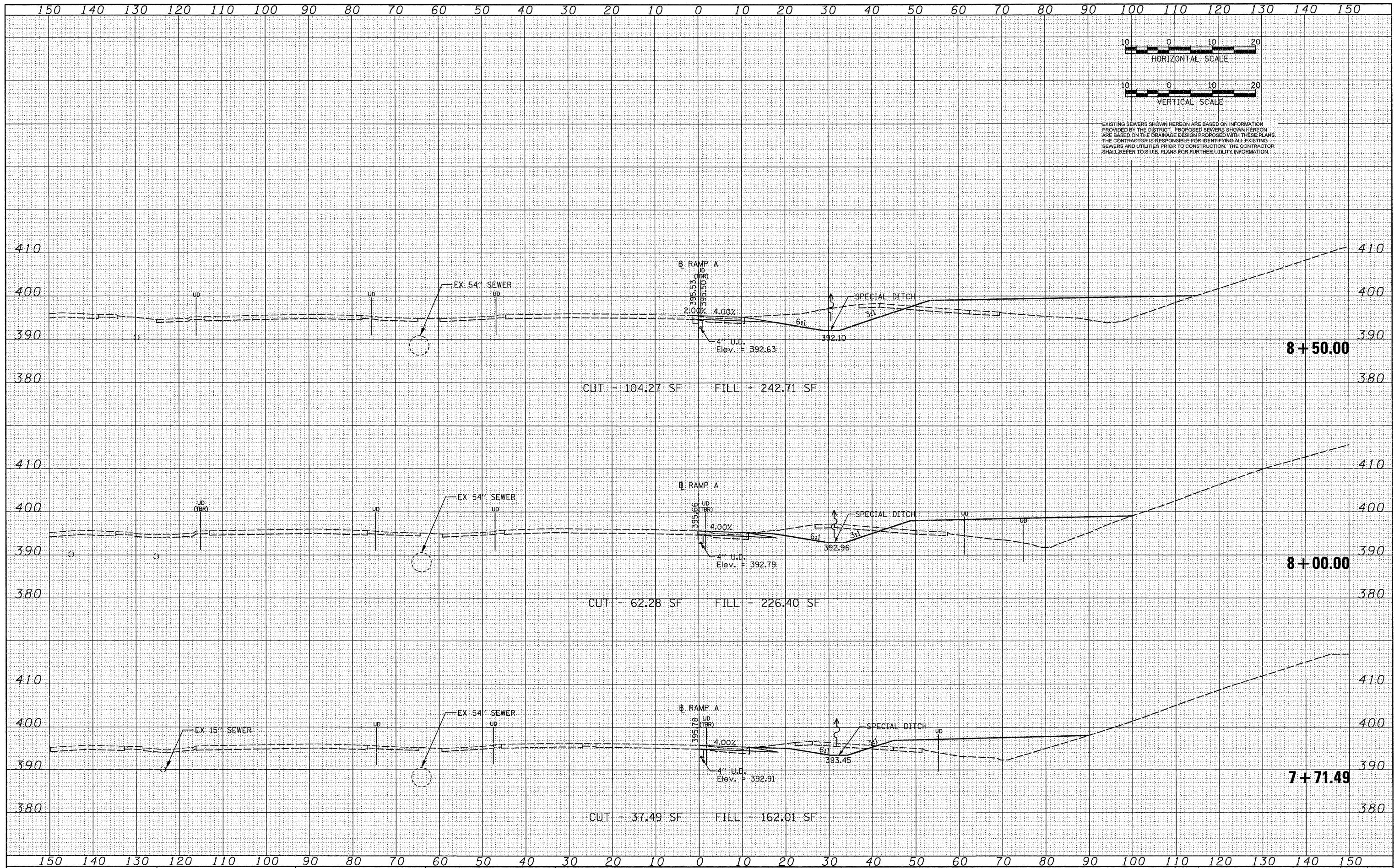

EXISTING SEWERS SHOWN HEREON ARE BASED ON INFORMATION PROVIDED BY THE DISTRICT. PROPOSED SEWERS SHOWN HEREON ARE BASED ON THE DRAINAGE DESIGN PROPOSED WITH THESE PLANS. THE CONTRACTOR IS RESPONSIBLE FOR IDENTIFYING ALL EXISTING SEWERS AND UTILITIES PRIOR TO CONSTRUCTION. THE CONTRACTOR SHALL REFER TO S.U.E. PLANS FOR FURTHER UTILITY INFORMATION.

FILE NAME = DBTRI-76C49-ah.t.XS\_RampA.dgn

USER NAME = IDOT  
 DESIGNED - TTB  
 DRAWN - GDO  
 CHECKED - JAH  
 DATE - 3/19/2010

REVISED -  
 REVISED -  
 REVISED -  
 REVISED -

STATE OF ILLINOIS  
 DEPARTMENT OF TRANSPORTATION

CROSS SECTIONS - RAMP A

SCALE: 1" = 10' SHEET NO. 1 OF 10 SHEETS STA. 7+71.49 TO STA. 8+50.00

F.A. RTE.	SECTION	COUNTY	TOTAL SHEETS	SHEET NO.
64	82-1-2HB	ST. CLAIR	345	328
CONTRACT NO. 76C49				
FED. ROAD DIST. NO. [ILLINOIS] FED. AID PROJECT				