

DATE	
BY	
FINAL SURVEY	
TEMPLATE	
NOTE BOOK	
AREAS CHECKED	
NO.	

DATE	
BY	
ORIGINAL SURVEY	
TEMPLATE	
NOTE BOOK	
AREAS CHECKED	
NO.	

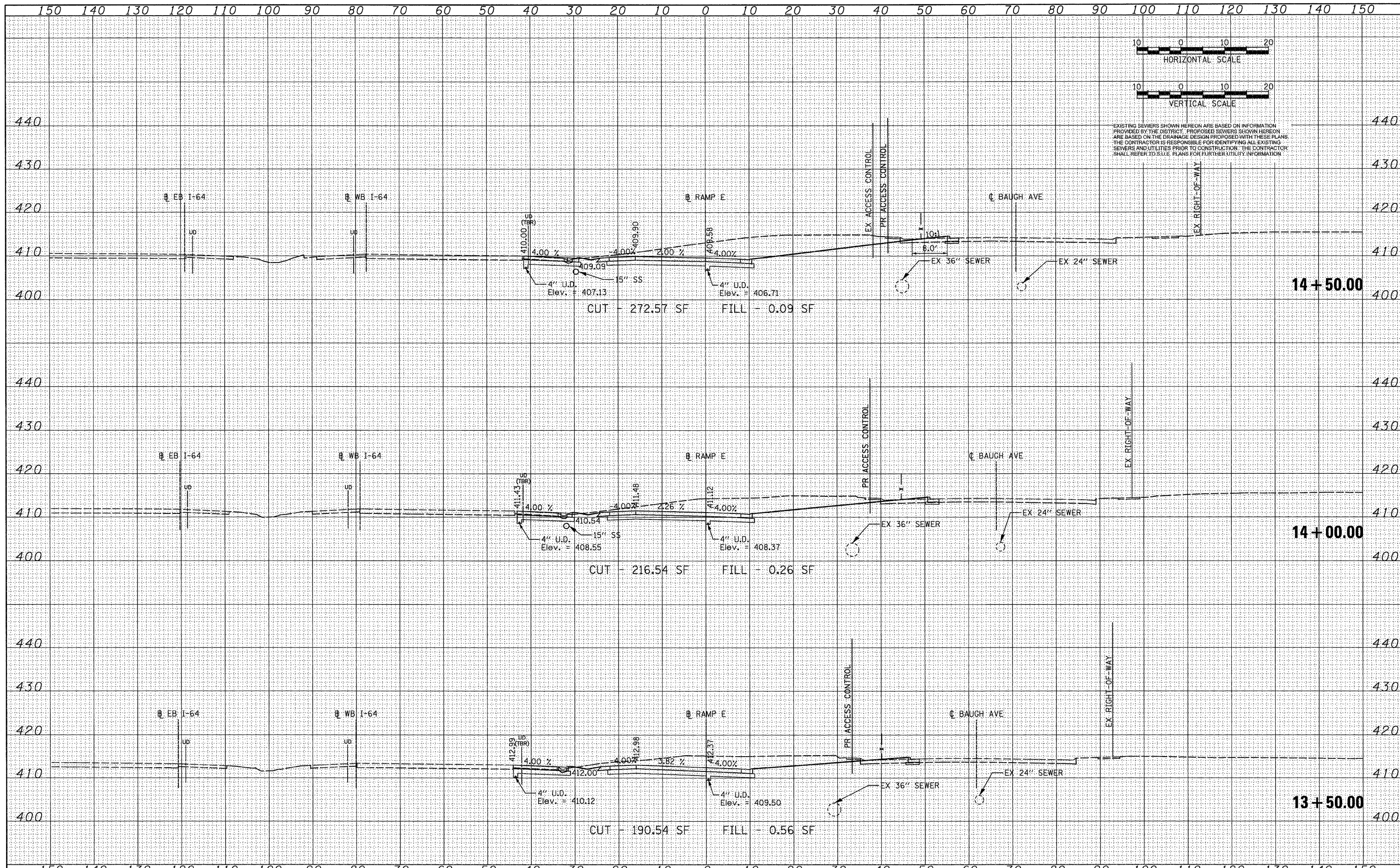

EXISTING SEWERS SHOWN HEREON ARE BASED ON INFORMATION PROVIDED BY THE DISTRICT. PROPOSED SEWERS SHOWN HEREON ARE BASED ON THE DRAINAGE DESIGN PROPOSED WITH THESE PLANS. THE CONTRACTOR IS RESPONSIBLE FOR IDENTIFYING ALL EXISTING SEWERS AND UTILITIES PRIOR TO CONSTRUCTION. THE CONTRACTOR SHALL REFER TO S.U.E. PLANS FOR FURTHER UTILITY INFORMATION.

FILE NAME = D8TRI-76C49-sht.XS_RampE.dgn	USER NAME = IDDT	DESIGNED - TTB	REVISED -	STATE OF ILLINOIS DEPARTMENT OF TRANSPORTATION	CROSS SECTIONS - RAMP E		F.A. RTE. 64	SECTION 82-1-2HB	COUNTY ST. CLAIR	TOTAL SHEETS 345	SHEET NO. 344	
PLOT SCALE = 10.0000' / IN.	CHECKED - JAH	DRAWN - GDO	REVISED -		SCALE: 1" = 10'	SHEET NO. 3 OF 4 SHEETS	STA. 13+50.00 TO STA. 14+50.00	CONTRACT NO. 76C49		ILLINOIS FED. AID PROJECT		
PLOT DATE = 3/18/2010	DATE - 3/19/2010	CHECKED - JAH	REVISED -									
		DATE - 3/19/2010	REVISED -									