

F.A.P. RTE.	SECTION	COUNTY	TOTAL SHEETS	SHEET NO.
592	121-1RS-2	ST. CLAIR	13	1
FED. ROAD DIST. NO.	ILLINOIS	CONTRACT NO. 76D18		

STATE OF ILLINOIS
DEPARTMENT OF TRANSPORTATION
DIVISION OF HIGHWAYS

**PROPOSED
HIGHWAY PLANS**

FAP ROUTE 592 (IL 13)
SECTION 121-1RS-2
ST CLAIR COUNTY
RESURFACING IL 13 BETWEEN IL 163 & IL 13 E JCT
C-98-072-09

FOR INDEX OF SHEETS, SEE SHEET NO. 2

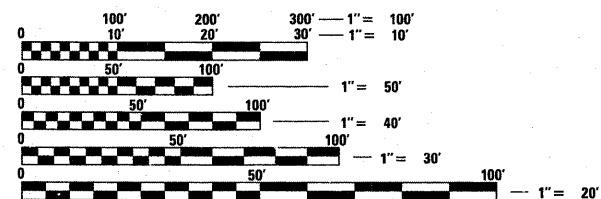
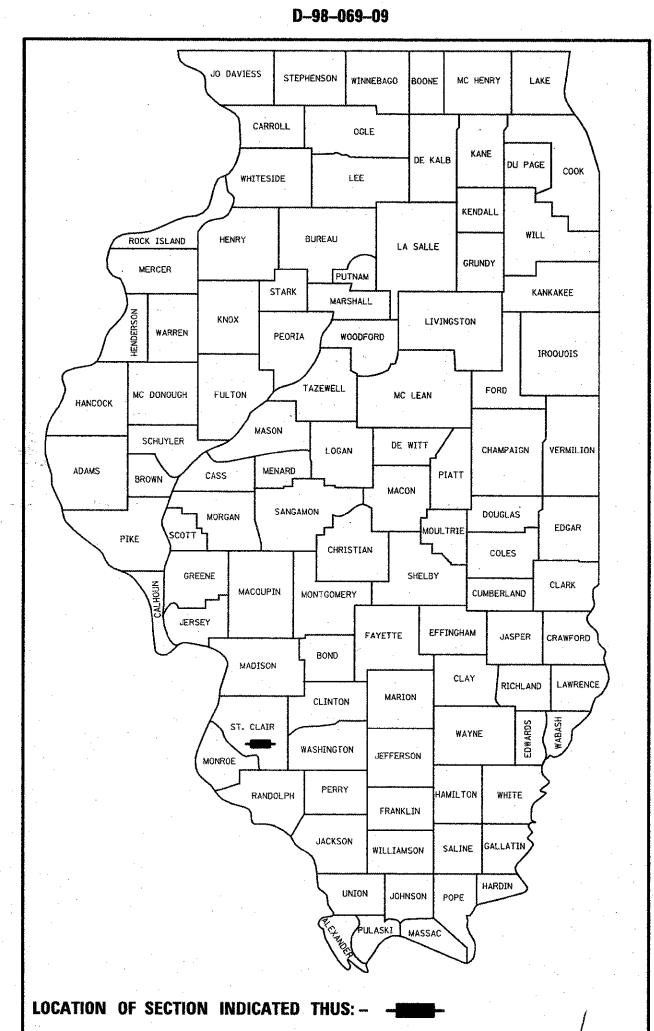

FULL SIZE PLANS HAVE BEEN PREPARED USING STANDARD ENGINEERING SCALES. REDUCED SIZED PLANS WILL NOT CONFORM TO STANDARD SCALES. IN MAKING MEASUREMENTS ON REDUCED PLANS, THE ABOVE SCALES MAY BE USED.

J.U.L.I.E.
JOINT UTILITY LOCATION INFORMATION FOR EXCAVATION
1-600-892-0123
OR 811

PROJECT ENGINEER: PATTI LEBEAU (618) 346-3179
PROJECT MANAGER: HERVE GELIN (618) 346-3323

CONTRACT NO. 76D18

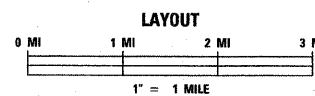
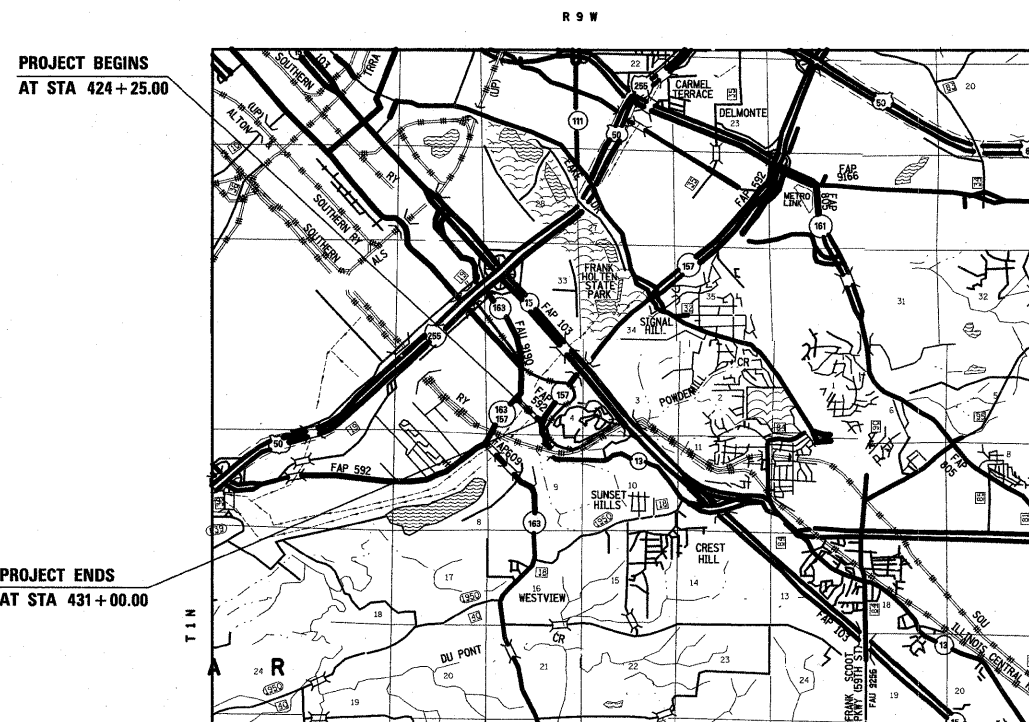

LATITUDE /LONGITUDE
START: 38.5592 /-90.1007
END: 38.5606 /-90.1022

GROSS LENGTH = 675 FT = 0.128 MILE
NET LENGTH = 675 FT = 0.128 MILE

TRAFFIC DATA
ADT: 7500 (2010)
9200 (2030)
SU: 2.4%
MU: 0.9%

STATE OF ILLINOIS
DEPARTMENT OF TRANSPORTATION
DIVISION OF HIGHWAYS

SUBMITTED *March 16, 2010*
My Chami
DEPUTY DIRECTOR OF HIGHWAYS, REGION 5 ENGINEER

May 7, 2010
Scott B. Stitt P.E. & I
ACTING ENGINEER OF DESIGN AND ENVIRONMENT

May 7, 2010
Christine M. Reed/er
DIRECTOR OF HIGHWAYS, CHIEF ENGINEER

**PRINTED BY THE AUTHORITY
OF THE STATE OF ILLINOIS**

GENERAL NOTES

EROSION CONTROL & SEDIMENT CONTROL NOTES

INDEX OF SHEETS

1. COVER PAGE
2. INDEX OF SHEETS/HIGHWAY STANDARDS/GENERAL NOTES
COMMITMENTS/EROSION CONTROL & SEDIMENT CONTROL NOTES
3. SUMMARY OF QUANTITIES
4. TYPICAL SECTIONS
5. SCHEDULE OF QUANTITIES
6. TIE POINTS & BUTT-JOINT DETAILS
7. - 8. PLAN AND PROFILE SHEETS
9. PAVEMENT MARKING DETAILS
10. - 13. CROSS SECTIONS

1. THE STANDARDS AND REVISION NUMBERS SHALL APPLY TO THIS PROJECT.
2. THE CONTRACTOR SHALL VERIFY ALL DIMENSIONS AND CONDITIONS IN THE FIELD PRIOR TO CONSTRUCTION AND ORDERING MATERIALS.
3. THE THICKNESS OF THE HMA MIXTURES SHOWN ON THE PLANS IS THE NORMAL THICKNESS. DEVIATIONS MAY OCCUR DUE TO IRREGULARITIES IN THE EXISTING SURFACE OR BASE ON WHICH THE HMA MIXTURE IS PLACED.
4. ILLINOIS STATE LAW REQUIRES A 48-HOUR NOTICE BE GIVEN TO ALL UTILITIES BEFORE DIGGING. FIELD MARKING OF FACILITIES MAY BE OBTAINED BY CONTACTING J.U.L.I.E. FOR NON-MEMBERS, THE UTILITY COMPANY DIRECTLY. AGENCIES KNOWN TO HAVE FACILITIES WITHIN THE PROJECT AREA ARE AS FOLLOWS:

- AMERENIP
- AMERENUE
- AT&T ILLINOIS
- CENTERPOINT ENERGY
- COMMONFIELDS OF CAHOKIA PUBLIC WATER DISTRICT
- ILLINOIS AMERICAN WATER COMPANY
- MCI NETWORK SERVICES, INC.
- 36ONETWORKS (USA) INC.

MEMBERS OF J.U.L.I.E (800) 892-0123 ARE INDICATED BY *. NON-MEMBERS MUST BE NOTIFIED INDIVIDUALLY.

5. THE CONTRACTOR SHALL BE RESPONSIBLE FOR SEEDING, FERTILIZING, AND MULCHING ANY AREAS DISTURBED OUTSIDE THE LIMITS OF CONSTRUCTION. THIS WORK WILL NOT BE MEASURED FOR PAYMENT. THE SEEDING SHALL BE CLASS 2. THE APPLICATION OF THE SEEDING, FERTILIZER, AND MULCH SHALL BE TO THE SATISFACTION OF THE ENGINEER. FINAL SEEDING SHALL BE PERFORMED AS SOON AS POSSIBLE.

6. IF THE CONTRACTOR, FOR HIS CONSTRUCTION ACTIVITY, REMOVES TREES WITHIN THE RIGHT-OF-WAY LIMITS WHICH ARE NOT DESIGNATED ON THE PLANS FOR REMOVAL, I.E. IN ORDER TO GAIN ACCESS TO THE PROJECT SITE; IT WILL BE HIS RESPONSIBILITY TO REPLACE THE TREES AT A 1:1 RATIO. THE TREES WILL BE REPLACED WITH A 1 GALLON NATIVE ILLINOIS TREE SPECIES AND SHALL BE APPROVED BY THE ENGINEER. THE TREE REMOVAL AND TREE REPLACEMENT WILL BE AT THE CONTRACTOR'S EXPENSE, AND NO ADDITIONAL COMPENSATION WILL BE ALLOWED.

7. PROPOSED PAVEMENT MARKING SHALL MATCH EXISTING AS DIRECTED BY THE RESIDENT ENGINEER.

8. SHORT TERM PAVEMENT MARKING SHALL BE APPLIED TO MILLED, PRIMED, LB, AND FINAL SURFACE. ONLY REMOVAL FROM FINAL SURFACE PAID AS WORK ZONE PAVEMENT MARKING REMOVAL.

9. NO OVERNIGHT LANE CLOSURES ALLOWED.

10. THE FOLLOWING MIXTURE REQUIREMENTS ARE APPLICABLE FOR THIS CONTRACT:

MIXTURE USE	SURFACE	LEVEL BINDER	BINDER
AC/PG	PG 64-22	PG 64-22	PG 64-22
RAP. % (MAX)	SEE SPEC.	SEE SPEC.	SEE SPEC.
DESIGN AIR VOIDS	4.0% @ Ndes=70	4.0% @ Ndes=70	4.0% @ Ndes=70
MIX COMPOSITION			
(GRADATION MIXTURE)	IL 12.5/9.5	IL 9.5	IL 19.0
FRICITION AGG	MIXTURE "D"	MIXTURE "C"	MIXTURE "B"

••TOP LIFT SHOULDERS - DESIGN THIS MIX AT 2.0% VOIDS AND ADD ASPHALT TO REDUCE VOIDS TO 1.5%.

PLAN QUANTITIES FOR HOT-MIX ASPHALT SURFACE COURSE ITEMS ARE CALCULATED USING A UNIT WEIGHT OF 112 LB/SQ YD/IN (59.8 KG/SQ M/25 MM THICKNESS).

ALL EROSION CONTROL PRODUCTS FURNISHED SHALL BE SPECIFICALLY RECOMMENDED BY THE MANUFACTURER FOR THE USE SPECIFIED IN THE EROSION CONTROL PLAN. PRIOR TO APPROVAL AND USE OF THE PRODUCT, THE CONTRACTOR SHALL SUBMIT TO THE ENGINEER A NOTARIZED CERTIFICATION BY THE PRODUCER STATING THE INTENDED USE OF THE PRODUCT AND THAT THE PHYSICAL PROPERTIES REQUIRED FOR THIS APPLICATION ARE MET OR EXCEEDED. THE CONTRACTOR SHALL PROVIDE MANUFACTURER RECOMMENDED INSTALLATION PROCEDURES TO FACILITATE THE ENGINEER IN CONSTRUCTION INSPECTION.

TEMPORARY SEEDING SHALL BE COMPLETED ON A WEEKLY BASIS ON EXPOSED GROUND AND SHALL BE PAID FOR AS "TEMPORARY EROSION CONTROL SEEDING" AND NO OTHER PAYMENT WILL BE PERMITTED. FOR CALCULATION PURPOSES, TWO APPLICATIONS OF TEMPORARY SEEDING WERE ASSUMED.

ALL AREAS DISTURBED FOR ANY REASON SHALL BE PERMANENTLY SEEDED AS DIRECTED BY THE ENGINEER. ALL AREAS DISTURBED BY THE CONTRACTOR OUTSIDE THE PROPOSED CONSTRUCTION LIMITS SHALL BE SEEDED AT THE CONTRACTOR'S EXPENSE

CLASS 2 SEEDING IS TO BE PLACED AS SOON AS EARTHWORK IS COMPLETED.

EARTH STOCKPILES SHALL BE TEMPORARILY SEEDED IF THEY ARE TO REMAIN UNUSED FOR MORE THAN FOURTEEN DAYS.

FINAL SEEDING SHALL BE PERFORMED AS SOON AS POSSIBLE.

HIGHWAY STANDARDS

000001-05
001006
482001-02
482011-03
630001-08
701201-03
701306-02
701901-01
780001-02
781001-03

COMMITMENTS

NONE

FILE NAME =	USER NAME = gelinh	DESIGNED -	REVISED -	STATE OF ILLINOIS DEPARTMENT OF TRANSPORTATION	INDEX OF SHEETS /HIGHWAY STANDARDS GENERAL NOTES /COMMITMENTS	F.A.P. RTE.	SECTION	COUNTY	TOTAL SHEETS	SHEET NO.	
cd:\pwork\PW100T\GELINH\0146285\d876	8-ah-plant.dgn	DRAWN -	REVISED -			592	121-IRS-2	ST CLAIR	13	2	
PLOT SCALE = 50,0000' / IN.		CHECKED -	REVISED -			CONTRACT NO. 76D18					
PLOT DATE = 3/17/2010		DATE -	REVISED -			SCALE: _____	SHEET NO. 1 OF 1 SHEETS	STA. _____ TO STA. _____	ILLINOIS FED. AID PROJECT		

SUMMARY OF QUANTITIES

SUMMARY OF QUANTITIES			TOTAL QUANTITIES	CONSTRUCTION TYPE CODE		
CODE NO	ITEM	UNIT		100% STATE I000-2A		
20400800	FURNISHED EXCAVATION	CU YD	80	80		
25000200	SEEDING, CLASS 2	ACRE	0.25	0.25		
25000400	NITROGEN FERTILIZER NUTRIENT	POUND	10	10		
25000500	PHOSPHORUS FERTILIZER NUTRIENT	POUND	10	10		
25000600	POTASSIUM FERTILIZER NUTRIENT	POUND	10	10		
25100105	MULCH, METHOD 1	ACRE	0.5	0.5		
28000250	TEMPORARY EROSION CONTROL SEEDING	POUND	20	20		
28000400	PERIMETER EROSION BARRIER	FOOT	405	405		
40600200	BITUMINOUS MATERIALS (PRIME COAT)	TON	0.6	0.6		
40600300	AGGREGATE (PRIME COAT)	TON	3	3		
40600635	LEVELING BINDER (MACHINE METHOD), N70	TON	42	42		
40600982	HOT-MIX ASPHALT SURFACE REMOVAL - BUTT JOINT	SQ YD	170	170		
40603085	HOT-MIX ASPHALT BINDER COURSE, IL-19.0, N70	TON	360	360		
40603340	HOT-MIX ASPHALT SURFACE COURSE, MIX "D", N70	TON	160	160		
44000198	HOT-MIX ASPHALT SURFACE REMOVAL, VARIABLE DEPTH	SQ YD	992	992		
48101500	AGGREGATE SHOULDERS, TYPE B 6"	SQ YD	450	450		
63300575	REMOVE AND REERECT RAIL ELEMENT OF EXISTING GUARD RAIL	FOOT	300	300		
67100100	MOBILIZATION	L SUM	1	1		
70100450	TRAFFIC CONTROL AND PROTECTION, STANDARD 701201	L SUM	1	1		
70100460	TRAFFIC CONTROL AND PROTECTION, STANDARD 701306	L SUM	1	1		
70300100	SHORT-TERM PAVEMENT MARKING	FOOT	608	608		
78300220	TEMPORARY PAVEMENT MARKING - LINE 4"	FOOT	2700	2700		
70301000	WORK ZONE PAVEMENT MARKING REMOVAL	SQ FT	1103	1103		
* 78000200	THERMOPLASTIC PAVEMENT MARKING - LINE 4"	FOOT	2716	2716		
* 78100100	RAISED REFLECTIVE PAVEMENT MARKER	EACH	9	9		
* 78200410	GUARDRAIL MARKERS, TYPE A	EACH	6	6		
78300100	PAVEMENT MARKING REMOVAL	SQ FT	900	900		
78300200	RAISED REFLECTIVE PAVEMENT MARKER REMOVAL	EACH	9	9		

**Specialty Items*

FILE NAME =	USER NAME = gelnh	DESIGNED -	REVISED -	STATE OF ILLINOIS DEPARTMENT OF TRANSPORTATION	SUMMARY OF QUANTITIES	F.A.P. RTE.	SECTION	COUNTY	TOTAL SHEETS	SHEET NO.	
ct:\pwork\pwidot\GELINH\d0146285\d876.d	8-shr-plan.dgn	DRAWN -	REVISED -			592	121-IRS-2	ST CLAIR	13	3	
PLOT SCALE = 50.0000' / IN.	CHECKED -	REVISED -	REVISED -			SCALE: _____ SHEET NO. 1 OF 1 SHEETS		STA. _____ TO STA. _____		FED. ROAD DIST. NO. _____ ILLINOIS FED. AID PROJECT	
PLOT DATE = 3/17/2010	DATE -	REVISED -	REVISED -			CONTRACT NO. 76D18					

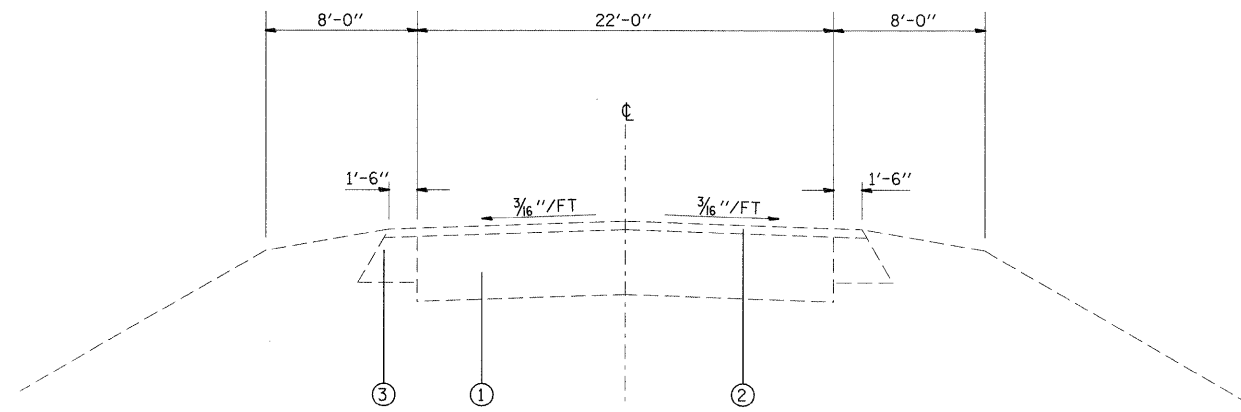

EXISTING TANGENT SECTION
 STA. 424+00.00 TO STA. 426+56.34
 STA. 429+99.91 TO STA. 431+00.00

- LEGEND**
- ① EXISTING PAVEMENT
 - ② EXISTING HMA SURFACE COURSE, 1 1/2"
 - ③ EXISTING HMA WIDENING
 - ④ EXISTING HMA SHOULDER
 - ⑤ PROPOSED BITUMINOUS MATERIAL (PRIME COAT)
 - ⑥ PROPOSED AGGREGATE (PRIME COAT)
 - ⑦ PROPOSED LEVELING BINDER, (MM) 3/4"
 - ⑧ PROPOSED HMA BINDER COURSE, MIX D, (VARIES 2" to 8 1/2")
 - ⑨ PROPOSED HMA SURFACE COURSE 1 1/2"
 - ⑩ PROPOSED HMA SHOULDERS
 - ⑪ PROPOSED AGGREGATE SHOULDERS, TYPE B

HMA SURFACE REMOVAL (VARIABLE DEPTH)

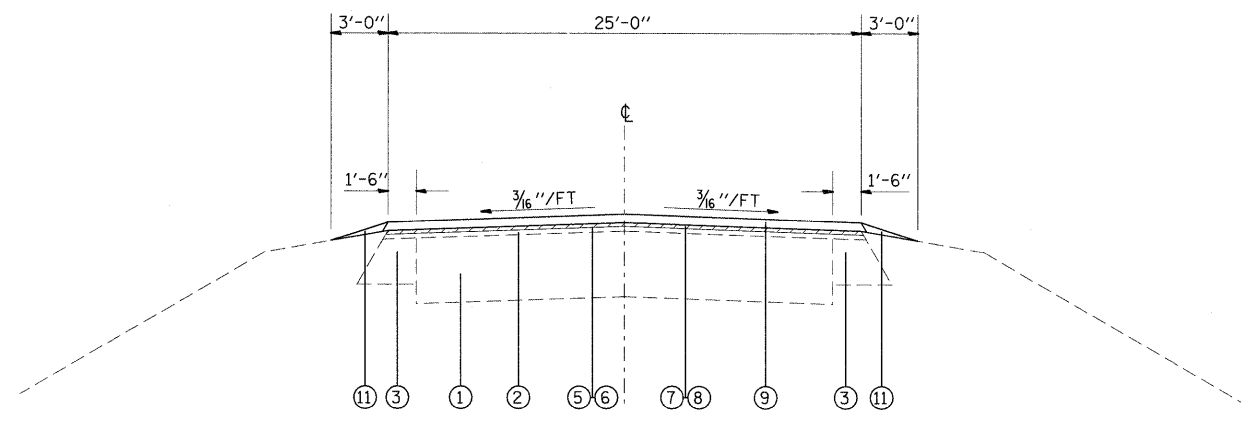

PROPOSED TANGENT SECTION
 STA. 424+00.00 TO STA. 426+56.34
 STA. 429+99.91 TO STA. 431+00.00

FILE NAME =	USER NAME = gelinh	DESIGNED -	REVISED -	STATE OF ILLINOIS DEPARTMENT OF TRANSPORTATION	TYPICAL SECTIONS	F.A.P. RTE. 592	SECTION 121-IRS-2	COUNTY ST CLAIR	TOTAL SHEETS 13	SHEET NO. 4		
cr:\pw_work\FWIDOT\GELINH\d0146285\d876	8-sh-t-plan.dgn	DRAWN -	REVISED -			SCALE: _____ SHEET NO. 1 OF 1 SHEETS STA. _____ TO STA. _____		CONTRACT NO. 76D18				
	PLOT SCALE = 50,000 / IN.	CHECKED -	REVISED -			FED. ROAD DIST. NO. _____ ILLINOIS FED. AID PROJECT						
	PLOT DATE = 3/18/2010	DATE -	REVISED -									

RESURFACING SCHEDULE

STATION	AGGREGATE PRIME COAT (TON)	BITUMINOUS MATERIAL PRIME COAT (TON)	LEVELING BINDER (TON)	HMA BINDER COURSE MIX "B", N70 (TON)	HMA SURFACE COURSE MIX "D", N70 (TON)	AGGREGATE SHOULDER TYPE B 6" (SQ YD)	REM & REER RAIL ELEM. OF EXISTING GUARD RAIL (FT)	HMA SURFACE REMOVAL BUTT-JOINT (SQ YD)
424+25.00 RT/LT TO 431+00.00 RT/LT	2.84	0.59			159.29			86.67
424+25.00 RT/LT TO 424+55.00 RT/LT								
424+25.00 RT TO 431+00.00 RT						225.00		
424+25.00 LT TO 431+00.00 LT						225.00		
424+25.00 RT/LT TO 426+00.00 RT/LT			21.28					
426+00.00 RT/LT TO 426+75.00 RT/LT				22.81				
426+75.00 RT/LT TO 427+00.00 RT/LT			2.91					
427+00.00 RT/LT TO 429+50.00 RT/LT				336.31				
427+50.00 RT/LT TO 429+00.00 RT/LT							300	
429+50.00 RT/LT TO 431+00.00 RT/LT			17.52					
430+70.00 RT/LT TO 431+00.00 RT/LT								83.33
TOTAL	2.84	0.59	41.71	359.12	159.29	450.00	300.00	170.00

EARTHWORK SCHEDULE

LOCATION	EMBANKMENT (CU YD)	EARTHWORK BALANCE WASTE (+) OR SHORTAGE (-) (CU YD)
STA 427+00.00 TO STA 429+50.00	77.6	-77.6

MILLING, BINDER, AND SURFACE SCHEDULE

STATION	EXISTING ELEV.	PROPOSED ELEV.	MILLING DEPTH (IN)	SURF THICKNESS (IN)	LEVELING BINDER THICK (IN)	BINDER THICKNESS (IN)
424+25.00	422.51	422.51	2.25	1.5	0.75	
424+50.00	422.66	422.52	3.93	1.5	0.75	
424+75.00	422.64	422.53	3.57	1.5	0.75	
425+00.00	422.67	422.56	3.57	1.5	0.75	
425+25.00	422.65	422.62	2.61	1.5	0.75	
425+50.00	422.71	422.71	2.25	1.5	0.75	
425+75.00	422.75	422.83	1.29	1.5	0.75	
426+00.00	422.80	422.98	0.09	1.5	0.75	
426+25.00	422.87	423.15		1.5		1.86
426+50.00	423.07	423.36		1.5		1.98
426+75.00	423.43	423.6	0.21	1.5	0.75	
427+00.00	423.69	423.84	0.45	1.5	0.75	
427+25.00	423.58	424.06		1.5		4.26
427+50.00	423.51	424.2		1.5		6.78
427+75.00	423.42	424.29		1.5		8.94
428+00.00	423.12	424.31		1.5		12.78
428+25.00	422.98	424.26		1.5		13.86
428+50.00	423.03	424.15		1.5		11.94
428+75.00	423.14	423.98		1.5		8.58
429+00.00	423.01	423.74		1.5		7.26
429+25.00	423.00	423.44		1.5		3.78
429+50.00	423.15	423.08	3.09	1.5	0.75	
429+75.00	422.96	422.65	5.97	1.5	0.75	
430+00.00	422.37	422.16	4.77	1.5	0.75	
430+25.00	421.63	421.61	2.49	1.5	0.75	
430+50.00	420.93	420.99	1.53	1.5	0.75	
430+75.00	420.24	420.34	1.05	1.5	0.75	
431+00.00	419.69	419.69	2.25	1.5	0.75	

PAVEMENT MARKING SCHEDULE

STATION	EDGE LINE	THERMOPLASTIC PVMT MKG		RAISED REFL. PKM MARKERS TWO-WAY (EA)
		4" WHITE LINE (FT)	4" DOUBLE YELLOW LINE (FT)	
424+23.00 LT TO 431+02.00 LT	EDGE LINE	679.00		
424+23.00 RT TO 431+02.00 RT	EDGE LINE	679.00		
424+23.00 CL TO 431+02.00 CL	CENTER LINE		1358.00	9
TOTAL		1358.00	1358.00	9

SEEDING SCHEDULE

LOCATION	SEEDING CLASS 2 (ACRE)	NITROGEN FERT. NUTR (POUND)	PHOSPHORUS FERT. NUTR (POUND)	POTASSIUM FERT. NUTR (POUND)	MULCH METHOD 1 (ACRE)
424+50.00 TO 430+00.00 RT	0.07	6.47	6.47	6.47	0.07
424+50.00 TO 430+50.00 LT	0.04	3.37	3.37	3.37	0.04
TOTAL	0.11	9.84	9.84	9.84	0.11

TEMPORARY EROSION CONTROL SCHEDULE

LOCATION	RT/LT	TEMP. EROS. CONTROL SEEDING (POUND)	MULCH METHOD 1 (ACRE)	PERIMETER EROSION BARRIER (FOOT)
424+50.00 TO 430+50.00	LT	6.74	0.07	
424+50.00 TO 430+00.00	RT	12.93	0.14	
427+50.00 TO 429+50.00	RT			204
427+50.00 TO 429+50.00	LT			201
TOTAL		19.67	0.22	405

REMOVAL SCHEDULE

STATION	HMA SURF REMOVAL VAR. DEPTH (SQ YD)	RAISED REFL. PVMT. MRK REMOVAL (EA)
424+25.00 TO 431+00.00		9
424+25.00 TO 426+00.00 RT/LT	505.56	
426+75.00 TO 427+00.00 RT/LT	69.44	
429+50.00 TO 431+00.00 RT/LT	416.67	
TOTAL	991.67	9

TEMPORARY PAVEMENT MARKING SCHEDULE

STATION	TEMP PVMT MARKING LINE 4" (FT)	SHORT TERM PAVEMENT MARKING (FT)	WORK ZONE PAVEMENT REMOVAL (SQ FT)	PAVEMENT MARKING REMOVAL (SQ FT)
424+25.00 TO 431+00.00	EDGE LINES	1350.0	405	135.0
424+25.00 TO 431+00.00	CENTER LINE	1350.0	202.5	67.5
TOTAL		2700.0	607.5	202.5

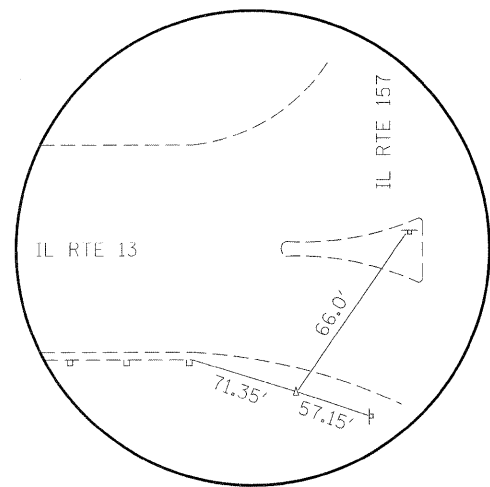

CONTROL POINT #13

REBAR & CAP
 N. 688965.70
 E. 2315805.75
 ELEV. 422.84

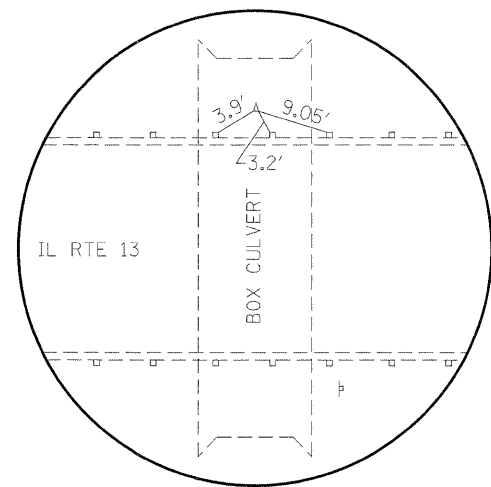

CONTROL POINT #14

REBAR & CAP
 N. 689405.53
 E. 2315429.83
 ELEV. 422.32

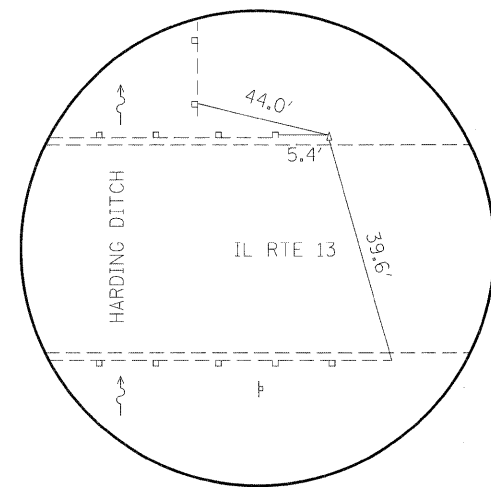

CONTROL POINT #15

REBAR & CAP
 N. 689915.76
 E. 2314957.81
 ELEV. 414.23

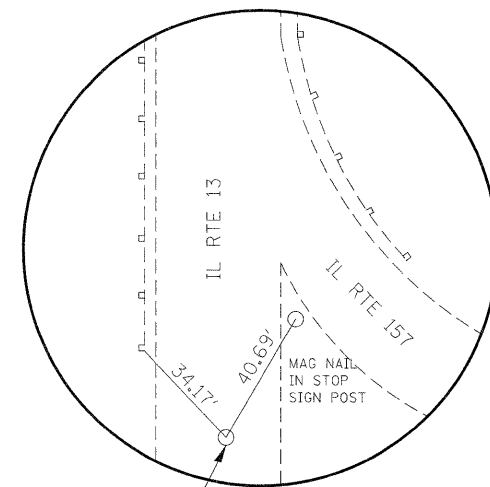

PCC STA 421+74.44

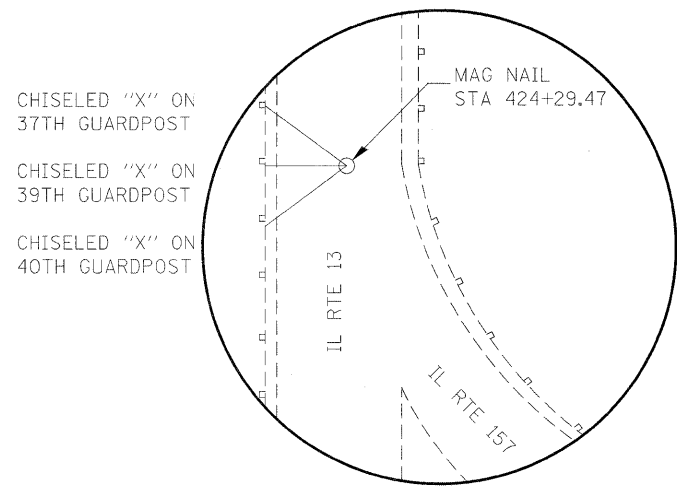

PT STA 424+29.47

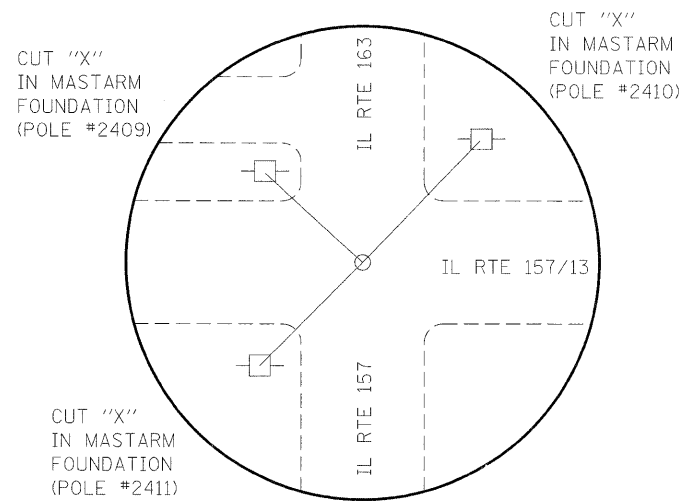

STA 441+11.84

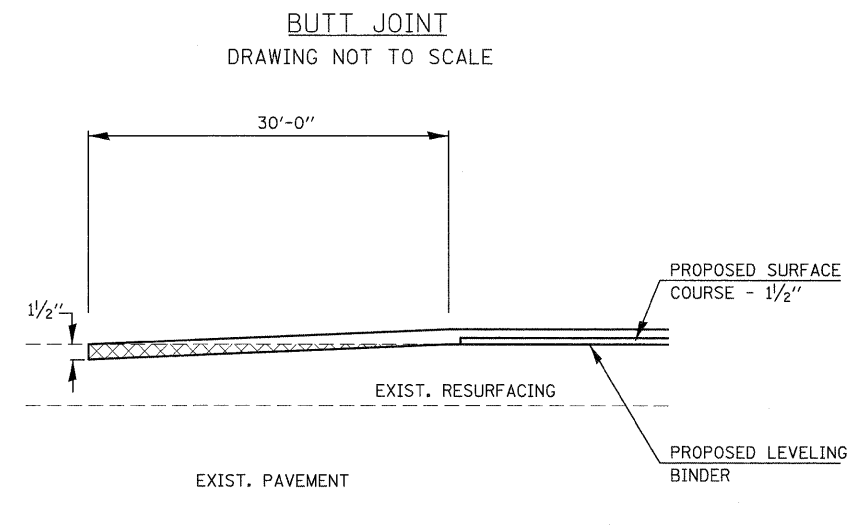

NOTES:
 NOT TO SCALE.
 ALL MEASUREMENTS ARE PULLED DIRECT, UNLESS OTHERWISE NOTED.

**STATE OF ILLINOIS
 DEPARTMENT OF TRANSPORTATION**

TIE POINT / BUTT JOINT DETAILS

FILE NAME =
 c:\pwork\pwork\WIDOT\GELINH\0146285\d876

USER NAME = gelinh
 B-sht-plan.dgn
 PLOT SCALE = 50.0000' / IN.
 PLOT DATE = 3/18/2010

DESIGNED -
 DRAWN -
 CHECKED -
 DATE -

REVISED -
 REVISED -
 REVISED -
 REVISED -

SCALE: SHEET NO. 1 OF 1 SHEETS STA. TO STA.

F.A.P. RTE.	SECTION	COUNTY	TOTAL SHEETS	SHEET NO.
592	121-1RS-2	ST CLAIR	13	6
CONTRACT NO. 76D18				
FED. ROAD DIST. NO. - ILLINOIS FED. AID PROJECT				

PLAN	SURVEYED	BY	DATE
	PLOTTED		
	NOTED		
	RT. OF WAY CHECKED		
	PAID FILE NAME		

PROFILE	SURVEYED	BY	DATE
	PLOTTED		
	NOTED		
	RT. OF WAY CHECKED		
	STRUCTURE NOTATION CHK'D		

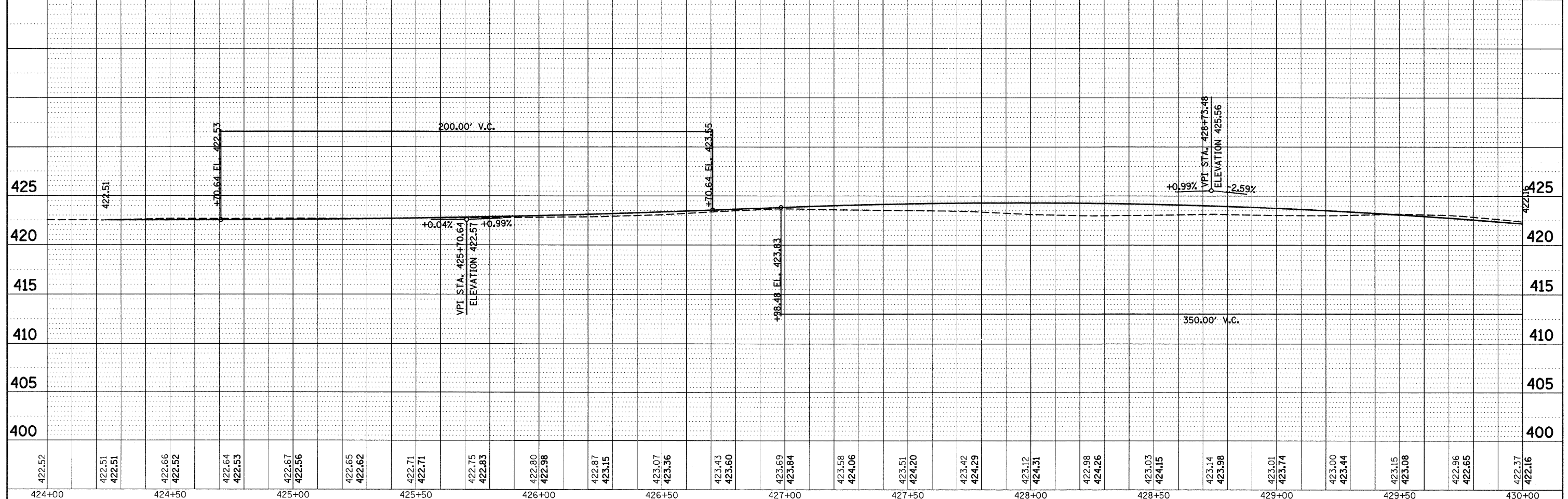
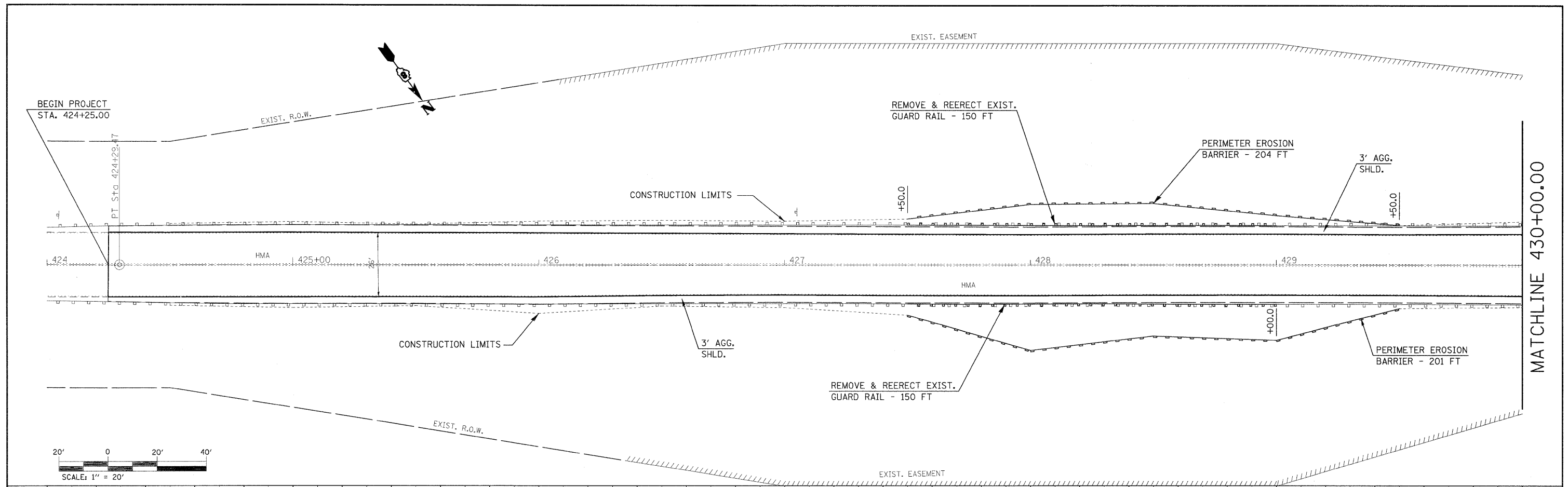

FILE NAME =	USER NAME = gelinh	DESIGNED -	REVISED -	STATE OF ILLINOIS DEPARTMENT OF TRANSPORTATION	PLAN AND PROFILE SCALE: 1" = 20' SHEET NO. 1 OF 2 SHEETS STA. 424+00.00 TO STA. 430+00.00	F.A.P. RTE.	SECTION	COUNTY	TOTAL SHEETS	SHEET NO.
es:\pw\work\p\WIDOT\GEL\INH\424146285\42676d18	shh-plnprf.dgn	DRAWN -	REVISED -			592	121-1RS-2	ST CLAIR	13	7
PLOT SCALE = 20.0000' / 1" IN.		CHECKED -	REVISED -			CONTRACT NO. 76D18				
PLOT DATE = 3/18/2012		DATE -	REVISED -			ILLINOIS FED. AID PROJECT				

PLAN	SURVEYED	DATE
	PLOTTED	
	NOTED	
	CHECKED	
	FILE NAME	
	NO.	

PROFILE	SURVEYED	DATE
	PLOTTED	
	GRADES CHECKED	
	STRUCTURE NOTATIONS CHECKED	
	NO.	

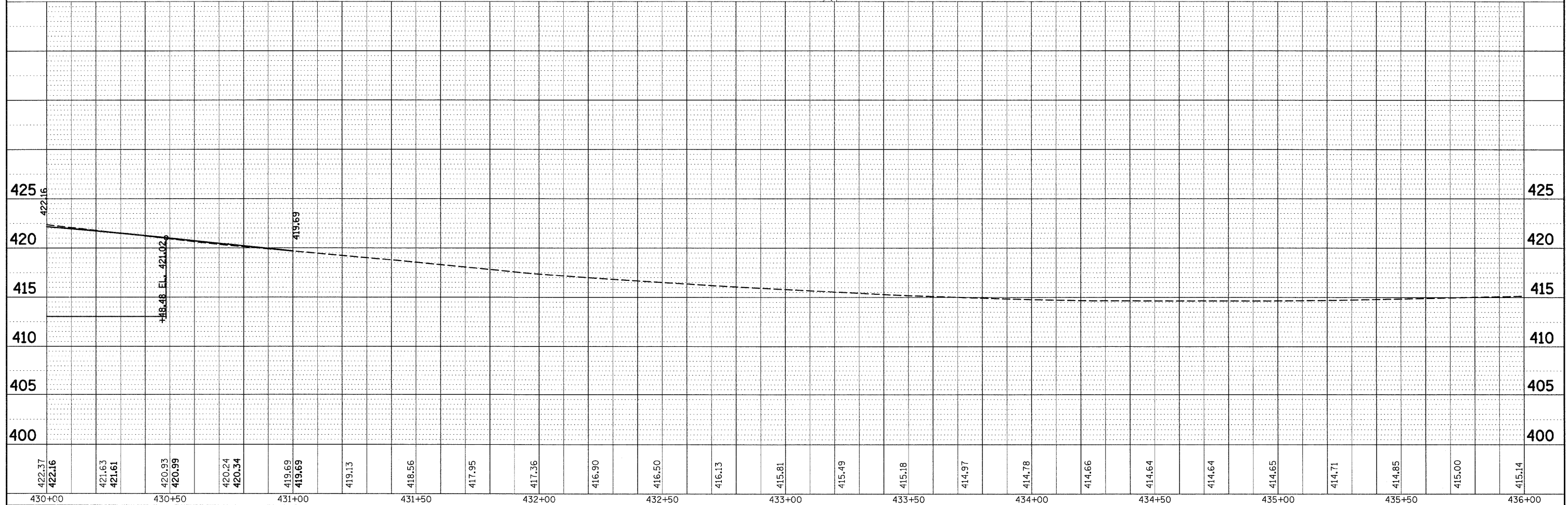
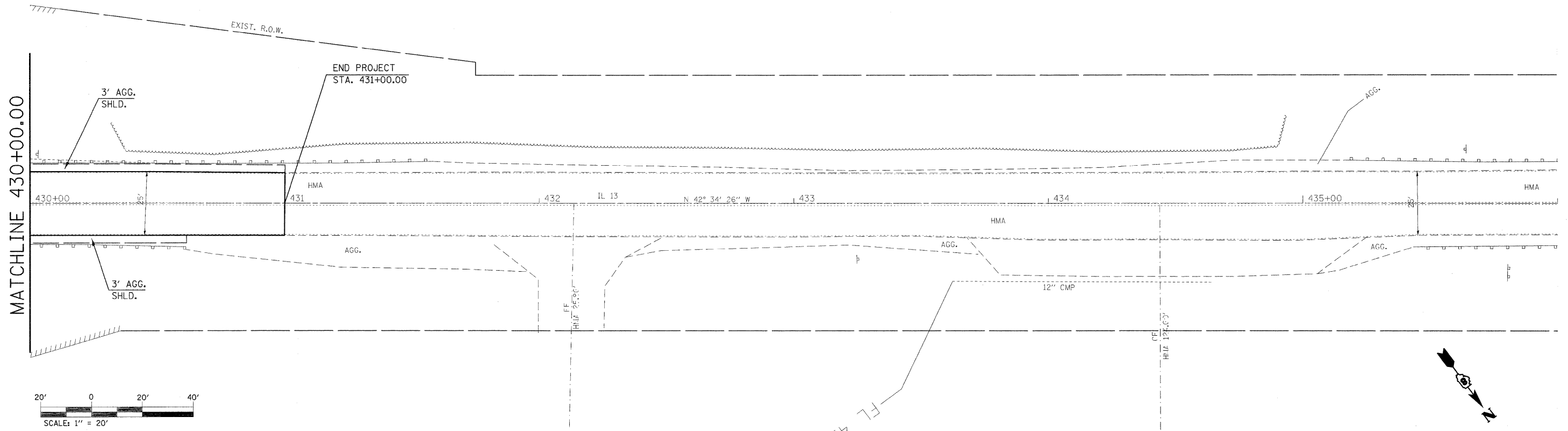

**STATE OF ILLINOIS
DEPARTMENT OF TRANSPORTATION**

PLAN AND PROFILE

FILE NAME =
at:\pwork\p\WIDOT\GEL\INH\d0146285\d876d18

USER NAME = gelinh
sht-plnpr.f.dgn
PLOT SCALE = 20,0000 ' / IN.
PLOT DATE = 3/12/2010

DESIGNED -
DRAWN -
CHECKED -
DATE -

REVISED -
REVISED -
REVISED -
REVISED -

SCALE: 1" = 20'

SHEET NO. 2 OF 2 SHEETS
STA. 430+00.00 TO STA. 436+00.00

F.A.P. RTE.	SECTION	COUNTY	TOTAL SHEETS	SHEET NO.
592	121-IRS-2	ST CLAIR	13	8
CONTRACT NO. 76D18				
ILLINOIS FED. AID PROJECT				

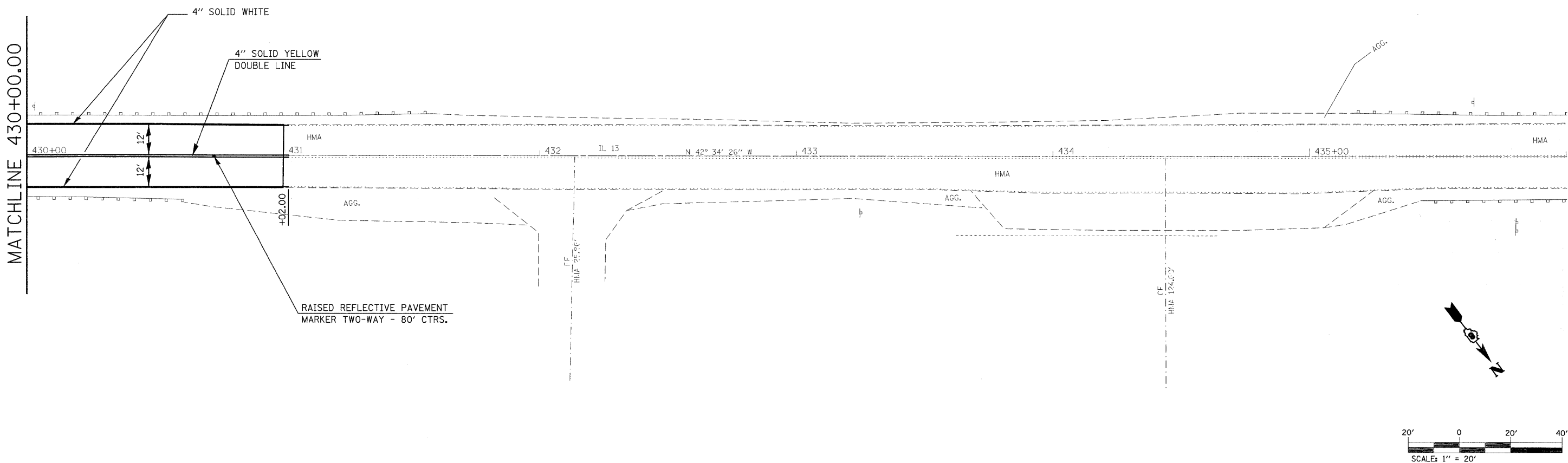
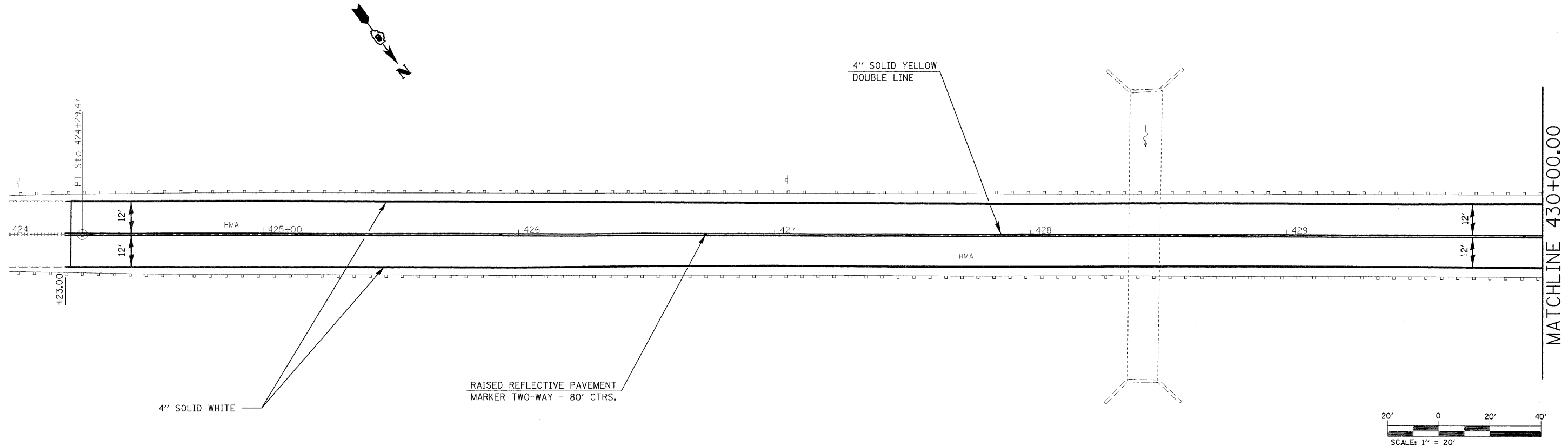

FILE NAME =	USER NAME = gelnh	DESIGNED -	REVISED -
ct:\pw\work\p\WIDOT\GELINH\2146285\d97608-sht-pmk.dgn		DRAWN -	REVISED -
PLOT SCALE = 20.0000' / IN.		CHECKED -	REVISED -
PLOT DATE = 3/12/2010		DATE -	REVISED -

**STATE OF ILLINOIS
DEPARTMENT OF TRANSPORTATION**

PAVEMENT MARKING DETAILS

SCALE: 1" = 20' SHEET NO. 1 OF 1 SHEETS STA. 424+00.00 TO STA. 436+00.00

F.A.P. RTE.	SECTION	COUNTY	TOTAL SHEETS	SHEET NO.
592	121-IRS-2	ST CLAIR	13	9
CONTRACT NO. 76D18				
ILLINOIS FED. AID PROJECT				

FINAL SURVEY	SURVEYED	BY	DATE
NOTE BOOK	PLOTTED		
NO.	DATE		
	AREAS		
	CHECKED		

ORIGINAL SURVEY	SURVEYED	BY	DATE
NOTE BOOK	PLOTTED		
NO.	DATE		
	AREAS		
	CHECKED		

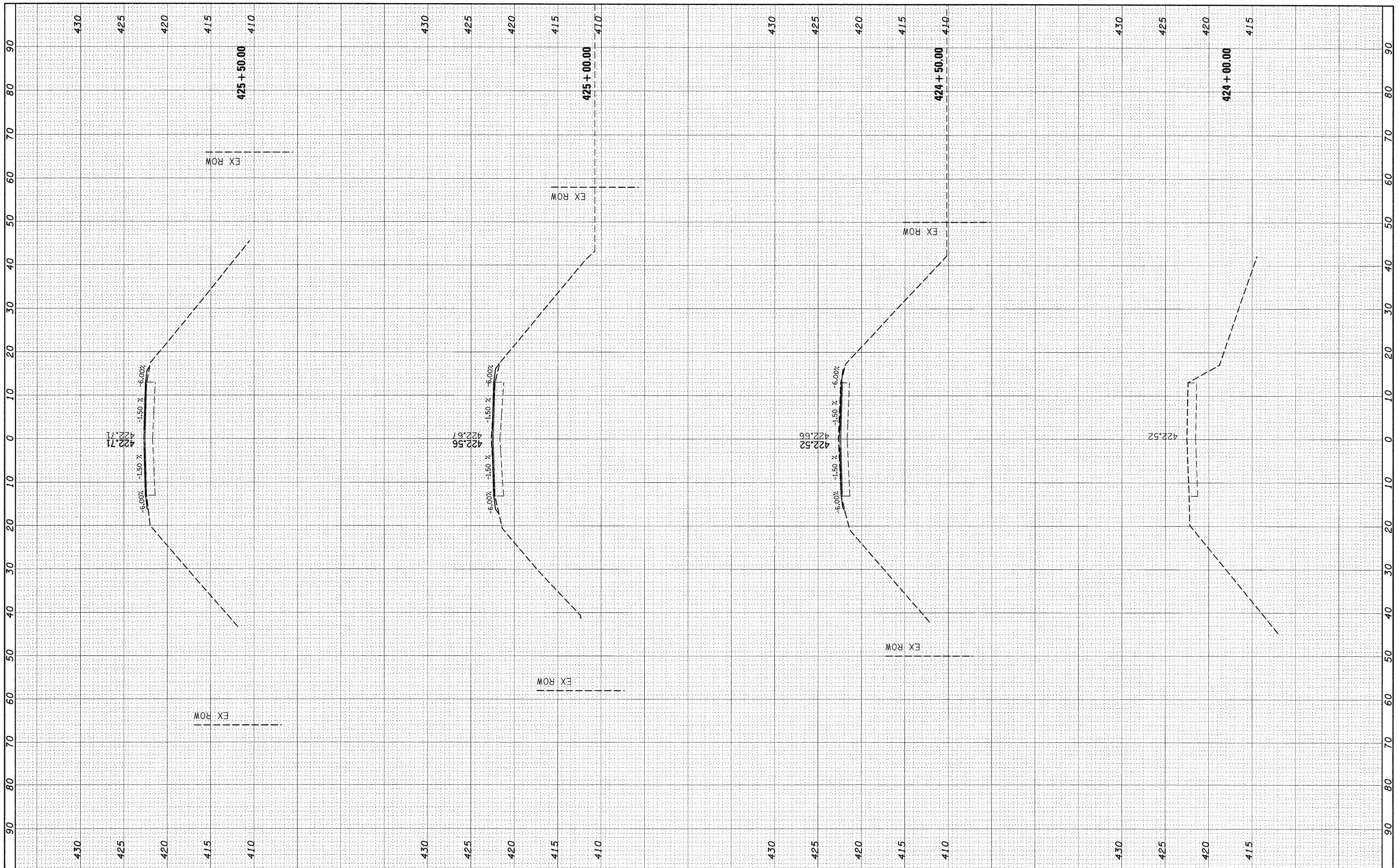

FILE NAME =	USER NAME = gelnh	DESIGNED -	REVISED -	STATE OF ILLINOIS DEPARTMENT OF TRANSPORTATION	CROSS SECTIONS		F.A.P. RTE.	SECTION	COUNTY	TOTAL SHEETS	SHEET NO.
c:\pw_work\PWIDOT\GELINH\d0146285\d876d18-shv-ssht.dgn		DRAWN -	REVISED -		SCALE: _____	SHEET NO. 1 OF 4 SHEETS	592	121-1RS-2	ST CLAIR	13	10
		CHECKED -	REVISED -		STA. 424+00.00 TO STA. 425+50.00						
		DATE -	REVISED -								
							ILLINOIS FED. AID PROJECT				

FINAL SURVEY	SURVEYED	BY	DATE
NOTE BOOK	PLOTTED		
NO.	AREAS CHECKED		

ORIGINAL SURVEY	SURVEYED	BY	DATE
NOTE BOOK	PLOTTED		
NO.	AREAS CHECKED		

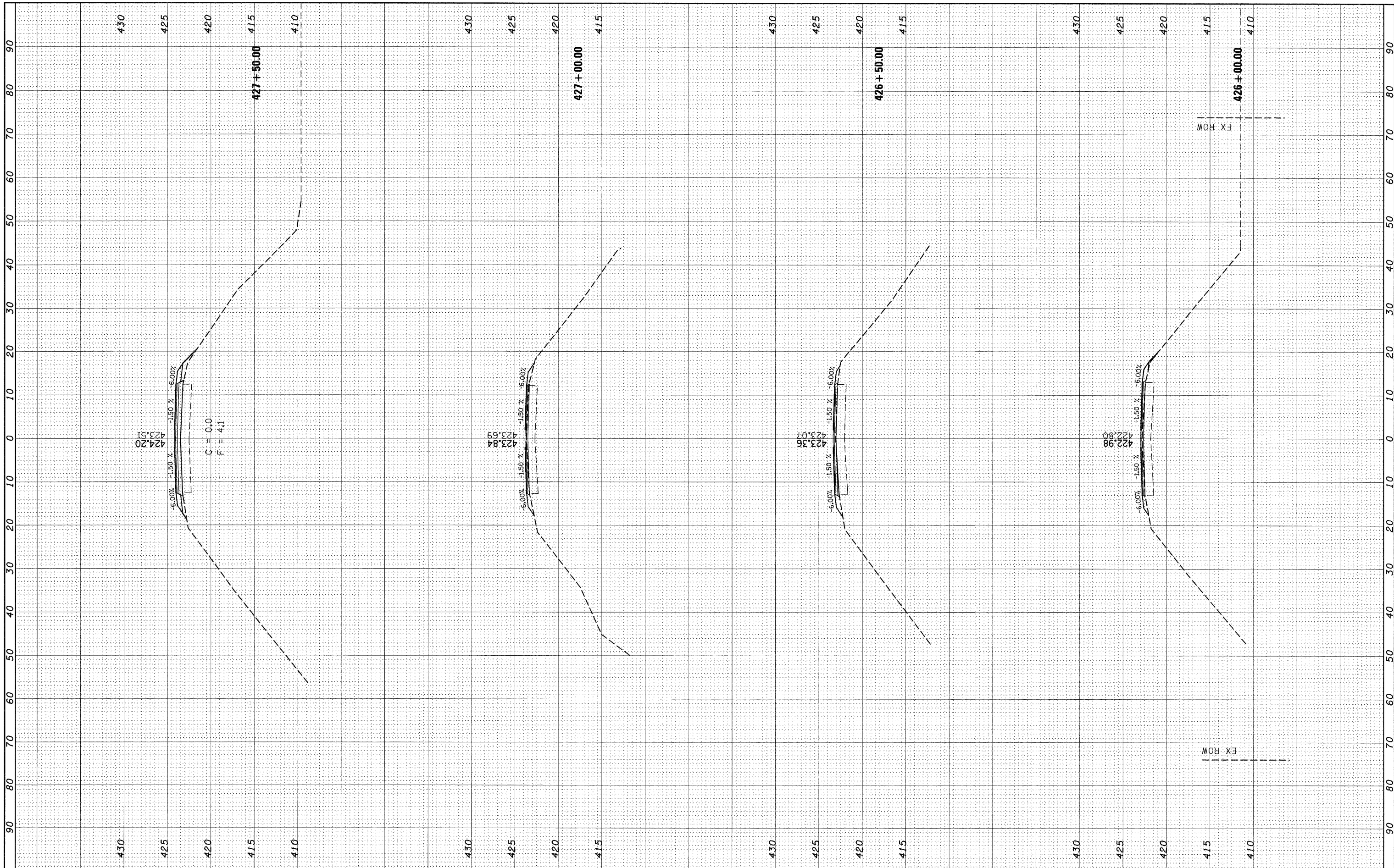

FILE NAME =	USER NAME = gellrh	DESIGNED -	REVISED -	STATE OF ILLINOIS DEPARTMENT OF TRANSPORTATION	CROSS SECTIONS		F.A.P. RTE.	SECTION	COUNTY	TOTAL SHEETS	SHEET NO.
c:\pw_work\PWIDOT\GELINH\d0146285\d876d18-shh-sst.dgn		DRAWN -	REVISED -		SCALE: _____	SHEET NO. 2 OF 4 SHEETS	592	121-1RS-2	ST CLAIR	13	11
		CHECKED -	REVISED -		STA. 426+00.00 TO STA. 427+50.00						
		DATE -	REVISED -								
							CONTRACT NO. 76D18				
							ILLINOIS FED. AID PROJECT				

FINAL SURVEY	SURVEYED	BY	DATE
NOTE BOOK	PLOTTED		
NO.	TEAR SHEET		
	AREAS		
	CHECKED		

ORIGINAL SURVEY	SURVEYED	BY	DATE
NOTE BOOK	PLOTTED		
NO.	TEAR SHEET		
	AREAS		
	CHECKED		

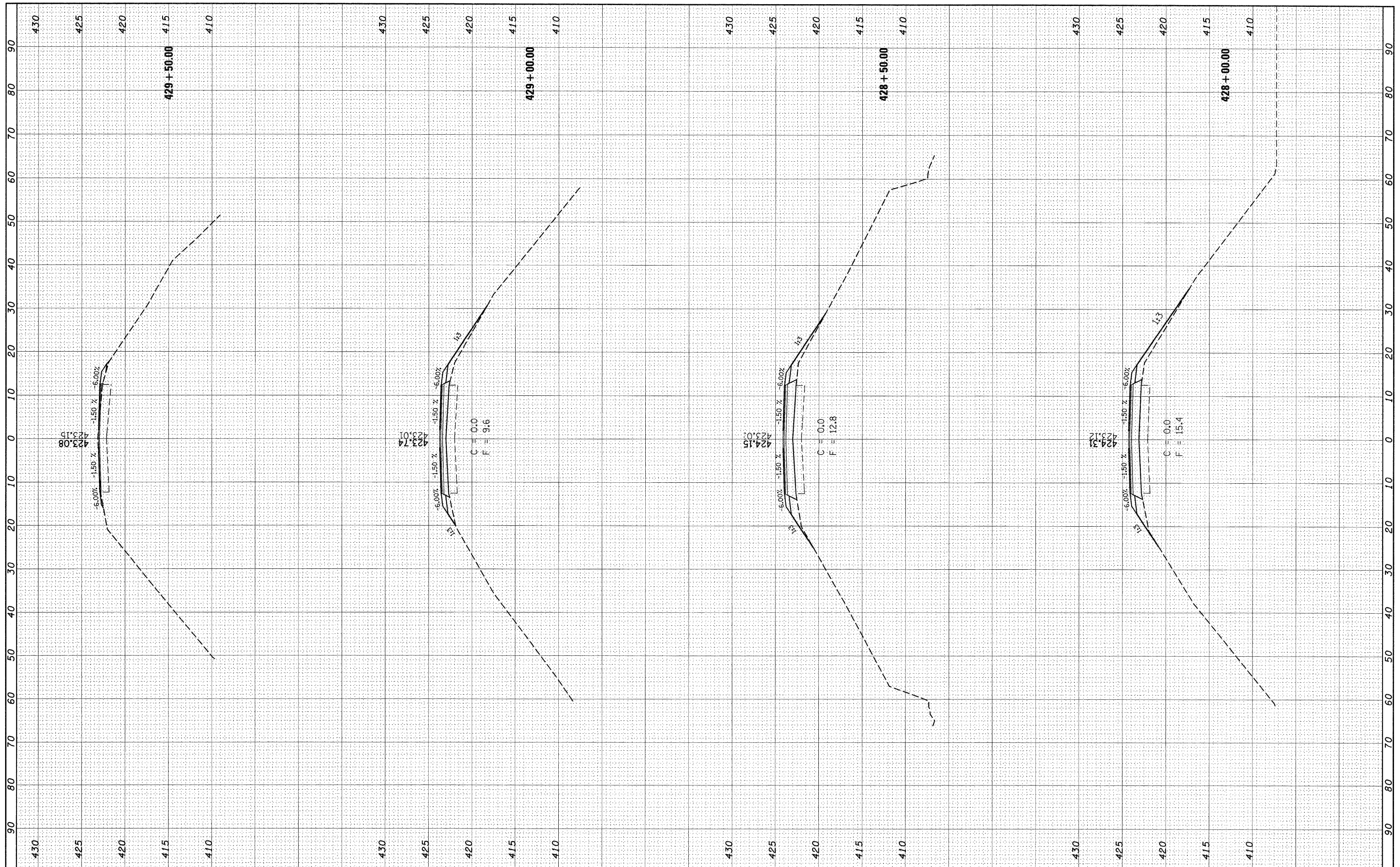

FILE NAME = c:\pw_work\PWIDOT\GELINH\d0146285\d876d18-sht3-esht.dgn

USER NAME = gelinh

DESIGNED	-	---	REVISED	-	---
DRAWN	-	---	REVISED	-	---
CHECKED	-	---	REVISED	-	---
DATE	-	---	REVISED	-	---

**STATE OF ILLINOIS
DEPARTMENT OF TRANSPORTATION**

CROSS SECTIONS

SCALE: _____ SHEET NO. 3 OF 4 SHEETS STA. 428+00.00 TO STA. 429+50.00

F.A.P. RTE.	SECTION	COUNTY	TOTAL SHEETS	SHEET NO.
592	121-IRS-2	ST CLAIR	13	12
CONTRACT NO. 76D18				
ILLINOIS FED. AID PROJECT				

FINAL SURVEY	SURVEYED	BY	DATE
NOTE BOOK	PLOTTED		
NO.	AREAS		
	CHECKED		

ORIGINAL SURVEY	SURVEYED	BY	DATE
NOTE BOOK	PLOTTED		
NO.	AREAS		
	CHECKED		

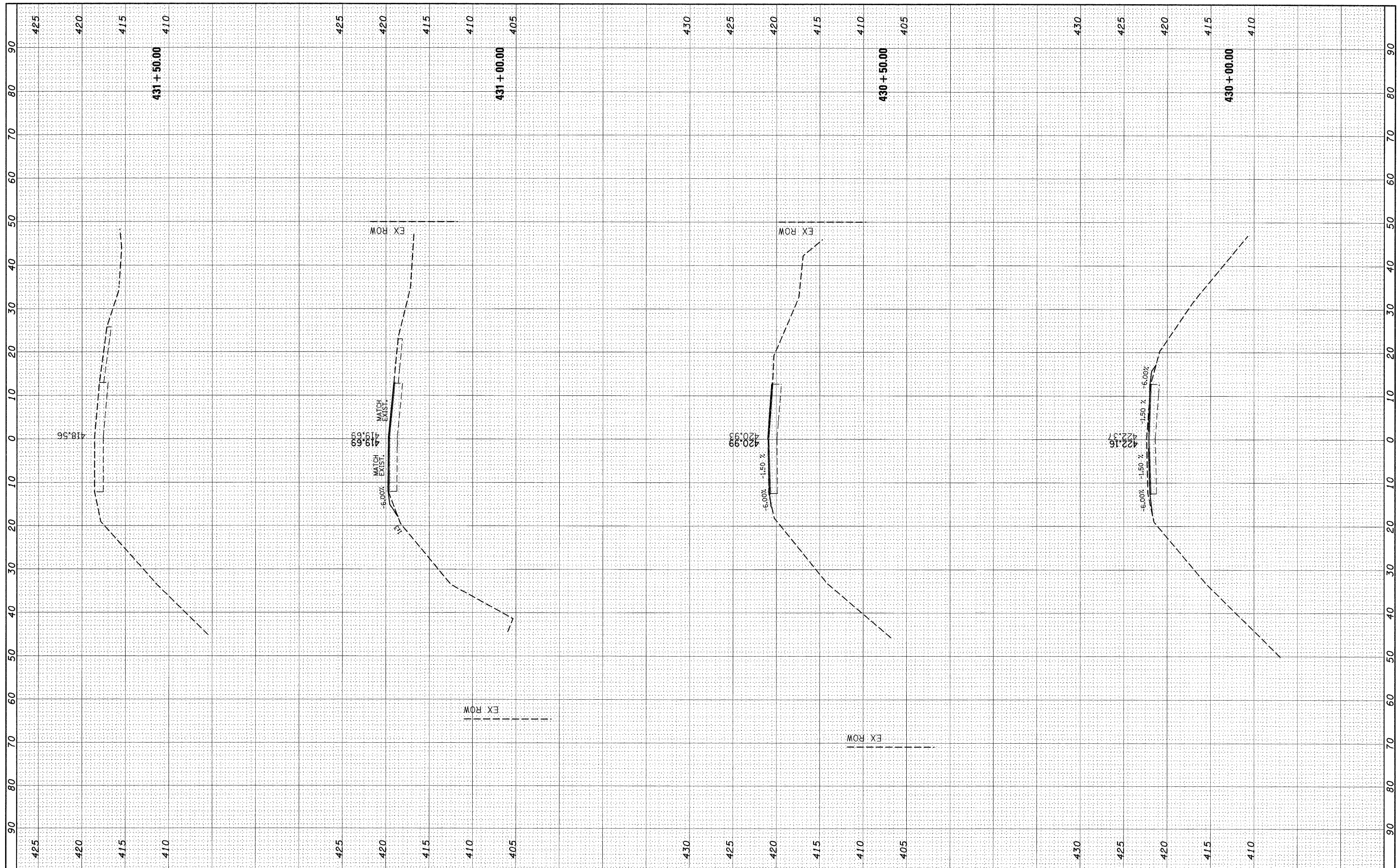

FILE NAME =	USER NAME = gellnh	DESIGNED -	REVISED -
c:\pw_work\PW1007\GELINH\d0146285\d076d18-shht.dgn		DRAWN -	REVISED -
		CHECKED -	REVISED -
		DATE -	REVISED -

**STATE OF ILLINOIS
DEPARTMENT OF TRANSPORTATION**

CROSS SECTIONS

SCALE: _____ SHEET NO. 4 OF 4 SHEETS STA. 430+00.00 TO STA. 431+50.00

F.A.P. RTE.	SECTION	COUNTY	TOTAL SHEETS	SHEET NO.
592	121-IRS-2	ST CLAIR	13	13
CONTRACT NO. 76D18				
ILLINOIS FED. AID PROJECT				