

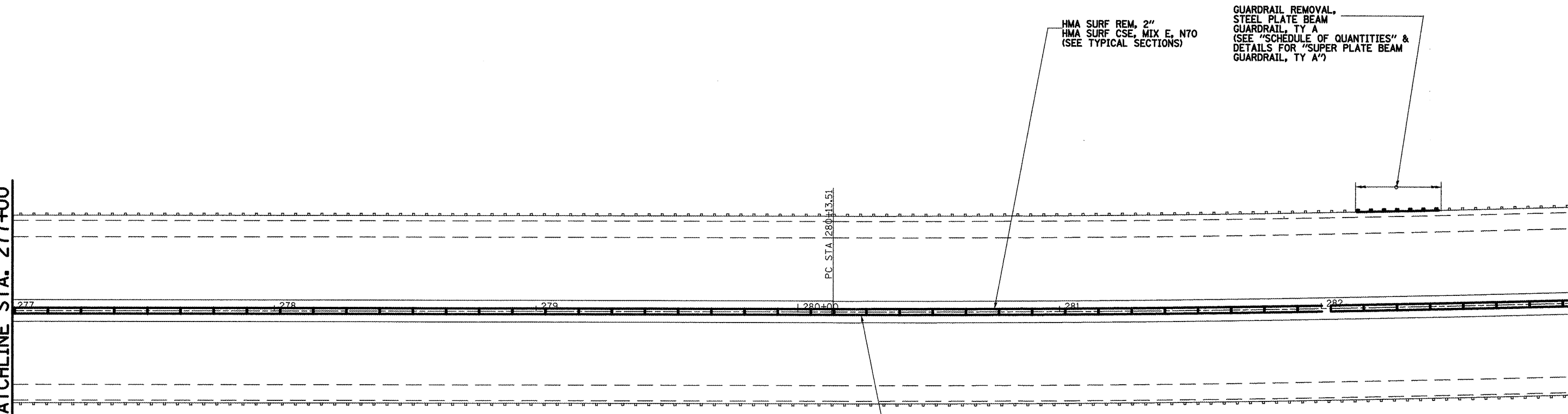

MATCHLINE STA. 277+00

MATCHLINE 283+00



HMA SURF REM, 2"
HMA SURF CSE, MIX E, N70
(SEE TYPICAL SECTIONS)

GUARDRAIL REMOVAL,
STEEL PLATE BEAM
GUARDRAIL, TY A
(SEE "SCHEDULE OF QUANTITIES" &
DETAILS FOR "SUPER PLATE BEAM
GUARDRAIL, TY A")

CONC BARRIER REMOVAL (SPECIAL)
CONC BARRIER, DOUBLE FACE, 32" HEIGHT
(SEE SCHEDULE OF QUANTITIES)

EXIST. CURVE IL15GG-1
PI STA. = 285+94.81
 $\Delta = 6^\circ 58' 00''$ (LT)
D = $0^\circ 36' 00''$
R = 9,549.80'
T = 581.30'
L = 1,161.17'
E = 17.68'
e = -----
T.R. = -----
S.E. RUN = -----
P.C. STA. = 280+13.51
P.T. STA. = 291+74.68

•NOTE - PAVEMENT MARKING SHALL NOT BE DISTURBED DURING HMA SURFACE REMOVAL



FILE NAME =	USER NAME = washingtonq	DESIGNED -	REVISED -	STATE OF ILLINOIS DEPARTMENT OF TRANSPORTATION	PLAN SHEET	F.A.P. RTE.	SECTION	COUNTY	TOTAL SHEETS	SHEET NO.	
ca\pwwork\pwwid\washingtonq\d8168383	8978d63-shr-plan.dgn	DRAWN -	REVISED -			103	28-11-1	ST. CLAIR	25	17	
	PLOT SCALE = 40,0000' / IN.	CHECKED -	REVISED -			CONTRACT NO. 76063					
	PLOT DATE = 3/19/2018	DATE -	REVISED -			FED. ROAD DIST. NO. ILLINOIS FED. AID PROJECT					
				SCALE: 1" = 20'		SHEET NO. OF SHEETS		STA. 277+00 TO STA. 283+00			