

| | | | | |
|-------------------------|----------------------------|---------------------|--------------------|----------------|
| FAU RTE 9228/9189 | SECTION Z-1RS-2, 29RS-6 | COUNTY ST. CLAIR | TOTAL SHEETS 33 | SHEET NO. 1 |
| ILLINOIS | | | CONTRACT NO. 76D75 | |

STATE OF ILLINOIS
DEPARTMENT OF TRANSPORTATION

DIVISION OF HIGHWAYS

**PROPOSED
HIGHWAY PLANS**

FAU 9228 / FAU 9189
(Z-1)RS-2, 29RS-6
25TH STREET / BOND AVE.
ST CLAIR COUNTY

INDEX OF SHEETS

1. COVER SHEET
2. GENERAL NOTES, STANDARDS, & COMMITMENTS
3. SUMMARY OF QUANTITIES
- 4.-12. TYPICAL SECTIONS
- 13.-14. SCHEDULES
- 15.-17. LOCATION MAPS
- 18.-29. PLAN VIEWS
30. PAVEMENT MARKING DETAIL
- 31.-32. ELECTRICAL DETAILS
33. MISCELLANEOUS DETAILS

D-98-043-10

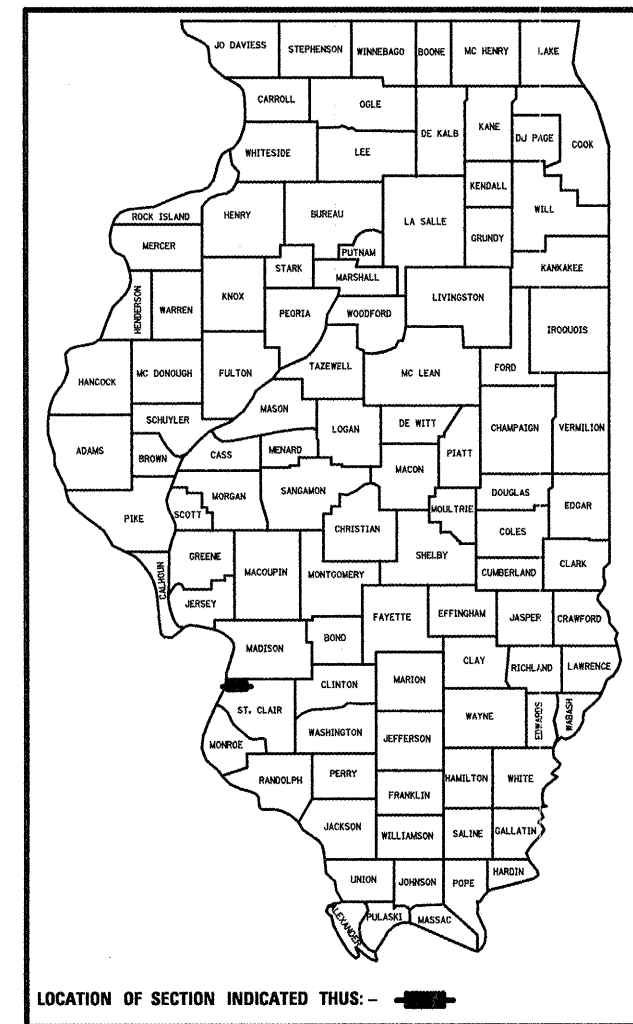

BEGIN PROJECT LOCATION #2
STA. 200+00
LAT. 38.609447
LONG. -90.131198

END PROJECT LOCATION #2
STA. 226+45
LAT. 38.616066
LONG. -90.127233

BEGIN PROJECT LOCATION #1
STA. 0+00
LAT. 38.617007
LONG. -90.161163

END PROJECT LOCATION #3
STA. 326+62
LAT. 38.62475
LONG. -90.122378

OMISSION AT ST. CLAIR AVE
STA. 312+59 TO STA. 313+24

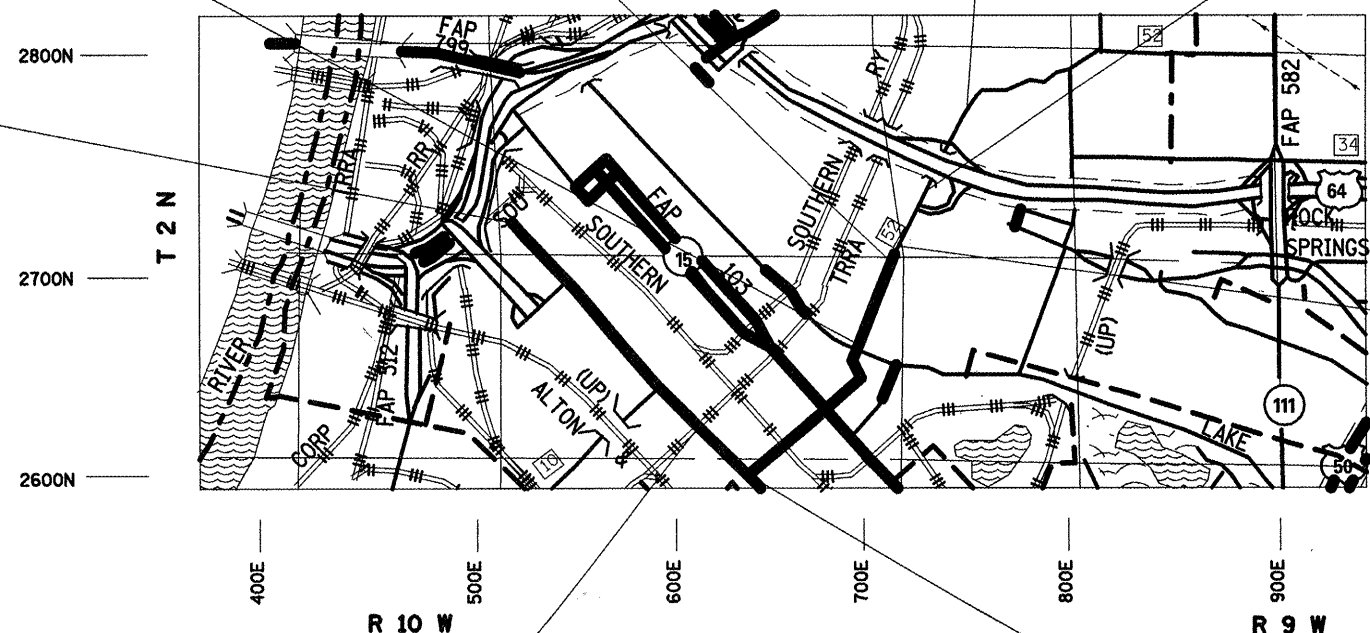

SCALES

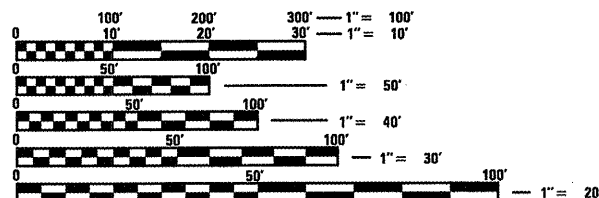

FULL SIZE PLANS HAVE BEEN PREPARED USING STANDARD ENGINEERING SCALES. REDUCED SIZED PLANS WILL NOT CONFORM TO STANDARD SCALES. IN MAKING MEASUREMENTS ON REDUCED PLANS, THE ABOVE SCALES MAY BE USED.

J.U.L.I.E.
JOINT UTILITY LOCATION INFORMATION FOR EXCAVATION
1-800-892-0123
OR 811

PROJECT ENGINEER: TIM PADGETT 618-346-3325
PROJECT MANAGER: JOHN ADCOCK 618-346-3354

CONTRACT NO. 76D75

C-98-056-10

RAILROAD OMISSION
AT LOCATION #1
STA. 60+59 TO STA. 60+69

END PROJECT LOCATION #1
STA. 79+47
LAT. 38.600417
LONG. -90.141535

MAP NOT TO SCALE

LOCATION #1 (BOND AVE. FROM 10TH ST. TO 26TH ST.)
GROSS LENGTH = 7947 FT. = 1.505 MILE
NET LENGTH = 7937 FT. = 1.503 MILE

LOCATION #2 (25TH ST. FROM LOUISIANA BLVD. TO STATE ST.)
GROSS LENGTH = 2645 FT. = 0.501 MILE
NET LENGTH = 2645 FT. = 0.501 MILE

LOCATION #3 (25TH ST. FROM OHIO AVE. TO ARGONNE DR.)
GROSS LENGTH = 2662 FT. = 0.504 MILE
NET LENGTH = 2597 FT. = 0.492 MILE

BEGIN PROJECT LOCATION #3
STA. 300+00
LAT. 38.617931
LONG. -90.126509

STATE OF ILLINOIS
DEPARTMENT OF TRANSPORTATION
DIVISION OF HIGHWAYS

SUBMITTED March 17, 2010
May C. Harris
DEPUTY DIRECTOR OF HIGHWAYS, REGION ENGINEER

May 7, 2010
Scott E. Stett, P.E.
acting ENGINEER OF DESIGN AND ENVIRONMENT

May 7, 2010
Christine M. Reeder
DIRECTOR OF HIGHWAYS, CHIEF ENGINEER

**PRINTED BY THE AUTHORITY
OF THE STATE OF ILLINOIS**