

Location # 3
40th St.

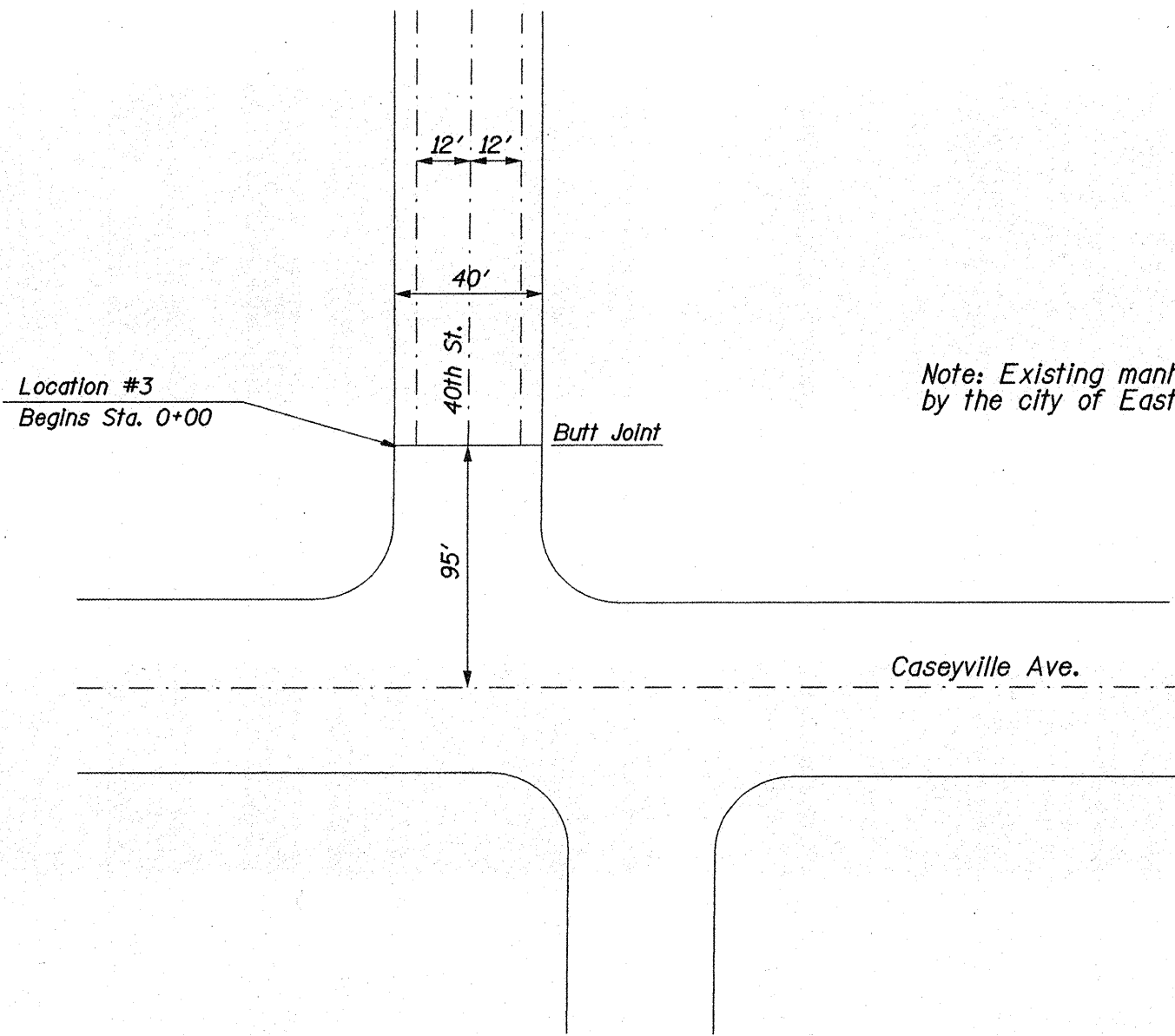

Note: Existing manholes and water valves shall be adjusted by the city of East St. Louis or paid for under article 109.04

FILE NAME =	USER NAME = veterale	DESIGNED -	REVISED -	STATE OF ILLINOIS DEPARTMENT OF TRANSPORTATION	LOCATION # 3 40TH ST.	F.A. RTE.	SECTION	COUNTY	TOTAL SHEETS	SHEET NO.	
c:\pwork\pndot\waterale\d0175127\d076385-shr-plan.dgn		DRAWN -	REVISED -			VAR.	DIST. 8 RES. 2010-6	ST. CLAIR	15	13	
PLOT SCALE = 1/8" = 1' / IN.		CHECKED -	REVISED -			CONTRACT NO. 76D06					
PLOT DATE = 3/4/2010		DATE -	REVISED -			SCALE: _____	SHEET NO. 1 OF 1 SHEETS	STA. _____	TO STA. _____	FED. ROAD DIST. NO. 8 ILLINOIS FED. AID PROJECT	