

STA 31273+91.70
PIPE CULVERTS, CLASS A, TYPE 2, 36"
PRC FLARED END SECTIONS, 36"

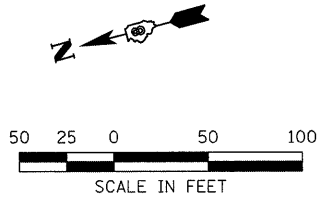

CONST LIMIT
SEE INTERSECTION DETAILS FOR INTERSECTION LAYOUT

EXIST. CURVE EX-IL3-1
PI STA. = 1353+94.79
 $\Delta = 40^\circ 35' 54''$ (LT)
 $D = 1^\circ 30' 00''$
 $R = 3,819.72'$
 $T = 1,412.89'$
 $L = 2,706.56'$
 $E = 252.94'$
 $\theta = 2\%$
T.R. = -----
S.E. RUN = 144
P.C. STA. = 1339+81.90
P.T. STA. = 1366+88.46

MATCH LINE STA 1352+00

MATCH LINE STA 1364+00

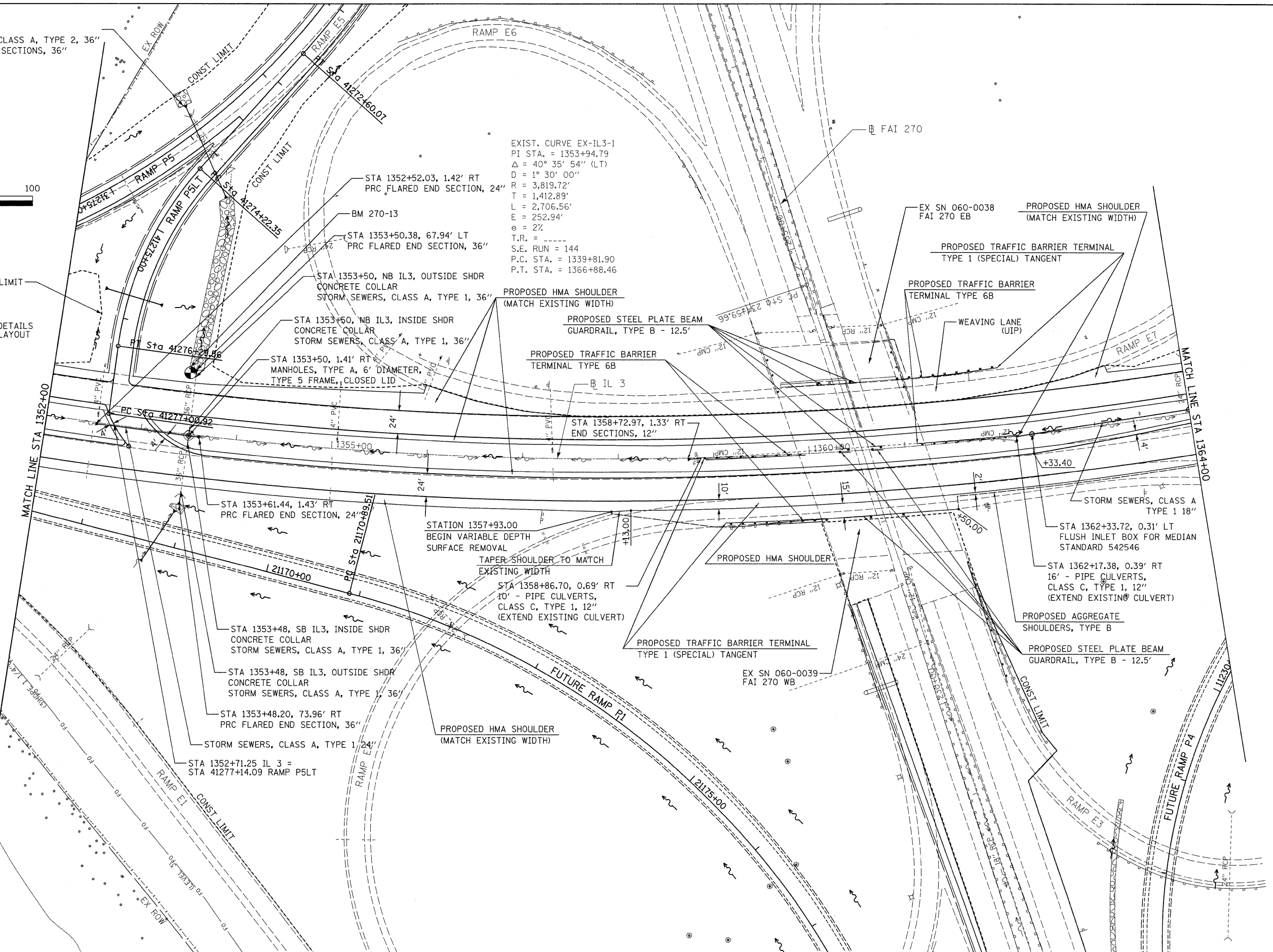

STA 1352+52.03, 1.42' RT
PRC FLARED END SECTION, 24"

BM 270-13

STA 1353+50.38, 67.94' LT
PRC FLARED END SECTION, 36"

STA 1353+50, NB IL3, OUTSIDE SHDR
CONCRETE COLLAR
STORM SEWERS, CLASS A, TYPE 1, 36"

STA 1353+50, NB IL3, INSIDE SHDR
CONCRETE COLLAR
STORM SEWERS, CLASS A, TYPE 1, 36"

STA 1353+50, 1.41' RT
MANHOLES, TYPE A, 6' DIAMETER,
TYPE 5 FRAME, CLOSED LID

PROPOSED HMA SHOULDER
(MATCH EXISTING WIDTH)

PROPOSED STEEL PLATE BEAM
GUARDRAIL, TYPE B - 12.5'

PROPOSED TRAFFIC BARRIER
TERMINAL TYPE 6B

STA 1358+72.97, 1.33' RT
END SECTIONS, 12"

STA 1353+61.44, 1.43' RT
PRC FLARED END SECTION, 24"

STATION 1357+93.00
BEGIN VARIABLE DEPTH
SURFACE REMOVAL

TAPER SHOULDER TO MATCH
EXISTING WIDTH

STA 1358+86.70, 0.69' RT
10' - PIPE CULVERTS,
CLASS C, TYPE 1, 12"
(EXTEND EXISTING CULVERT)

STA 1353+48, SB IL3, INSIDE SHDR
CONCRETE COLLAR
STORM SEWERS, CLASS A, TYPE 1, 36"

STA 1353+48, SB IL3, OUTSIDE SHDR
CONCRETE COLLAR
STORM SEWERS, CLASS A, TYPE 1, 36"

STA 1353+48.20, 73.96' RT
PRC FLARED END SECTION, 36"

STORM SEWERS, CLASS A, TYPE 1, 24"

STA 1352+71.25 IL 3 =
STA 41277+14.09 RAMP P5LT

PROPOSED HMA SHOULDER
(MATCH EXISTING WIDTH)

PROPOSED TRAFFIC BARRIER
TERMINAL TYPE 1 (SPECIAL) TANGENT

EX SN 060-0039
FAI 270 WB

PROPOSED AGGREGATE
SHOULDERS, TYPE B

PROPOSED STEEL PLATE BEAM
GUARDRAIL, TYPE B - 12.5'

STA 1362+33.72, 0.31' LT
FLUSH INLET BOX FOR MEDIAN
STANDARD 542546

STA 1362+17.38, 0.39' RT
16' - PIPE CULVERTS,
CLASS C, TYPE 1, 12"
(EXTEND EXISTING CULVERT)

EX SN 060-0038
FAI 270 EB

PROPOSED HMA SHOULDER
(MATCH EXISTING WIDTH)

PROPOSED TRAFFIC BARRIER
TERMINAL TYPE 1 (SPECIAL) TANGENT

PROPOSED TRAFFIC BARRIER
TERMINAL TYPE 6B

WEAVING LANE
(UIP)

LAST SAVED = 3/16/2010
PEN TABLE = VB.tbl
PLOT DRIVER = TR-Xerox6284-To-File.plt

FILE NAME =	USER NAME = sdonahue	DESIGNED -	REVISED -
\\0906600\0906601\cad\plans\012.D876087-Shr-Plan-IL3-02.dgn		DRAWN -	REVISED -
PLOT SCALE = 50.0023' / IN.		CHECKED -	REVISED -
PLOT DATE = 3/16/2010 4:38:23 PM		DATE -	REVISED -

STATE OF ILLINOIS
DEPARTMENT OF TRANSPORTATION



PLAN
ILLINOIS ROUTE 3

SCALE: 1" = 50' SHEET NO. 3 OF 16 SHEETS STA. 1352+00 TO STA. 1364+00

F.A.I. RTE.	SECTION	COUNTY	TOTAL SHEETS	SHEET NO.
270	60-2RS-3	MADISON	231	28
CONTRACT NO. 76DB7				
ILLINOIS FED. AID PROJECT				