

STATE OF ILLINOIS
DEPARTMENT OF TRANSPORTATION
DIVISION OF HIGHWAYS

**PROPOSED
HIGHWAY PLANS**

VARIOUS ROUTES (IL 15 & IL 3)
SECTION DIST. 8 STRIPING 2010-1
PROJECT: ACHSIP-0005(823)
MISCELLANEOUS STRIPING
MADISON & ST CLAIR COUNTIES

C-98-095-10

VAR RTE.	SECTION	COUNTY	TOTAL SHEETS	SHEET NO.
VAR	08 STRIPING 2010-1	MADISON/ST. CLAIR	8	1
ILLINOIS CONTRACT NO.				

76E08

D-98-074-10

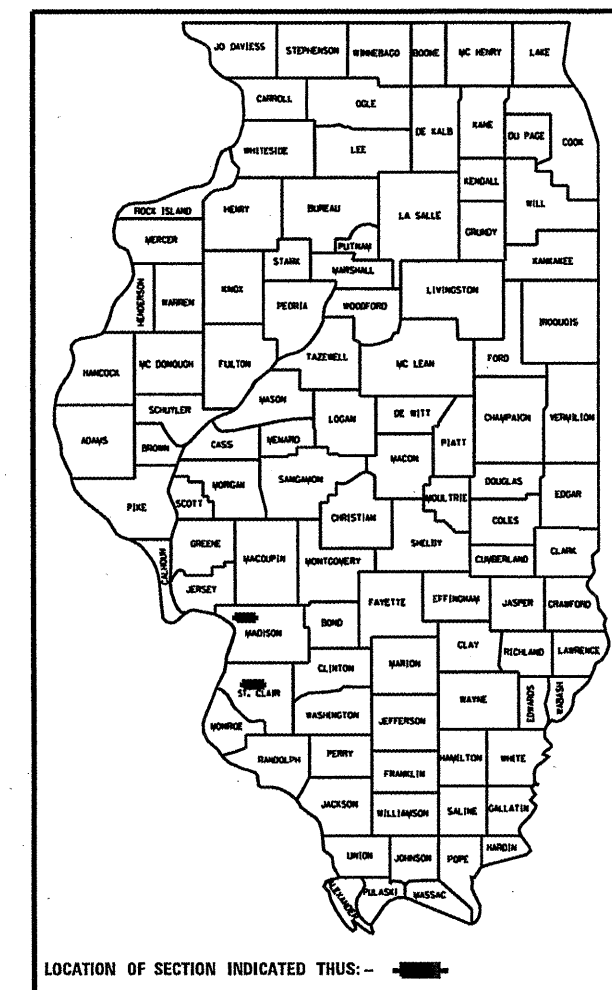

FOR INDEX OF SHEETS, SEE SHEET NO. 2

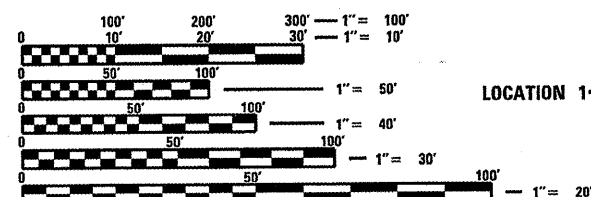

FULL SIZE PLANS HAVE BEEN PREPARED USING STANDARD ENGINEERING SCALES. REDUCED SIZED PLANS WILL NOT CONFORM TO STANDARD SCALES. IN MAKING MEASUREMENTS ON REDUCED PLANS, THE ABOVE SCALES MAY BE USED.

J.U.L.I.E.
JOINT UTILITY LOCATION INFORMATION FOR EXCAVATION
1-800-892-0123
OR 811

PROJECT ENGINEER: FRANK OPFER (618)346-3175
PROJECT MANAGER: TIM PADGETT (618)346-3325

CONTRACT NO. 76E08

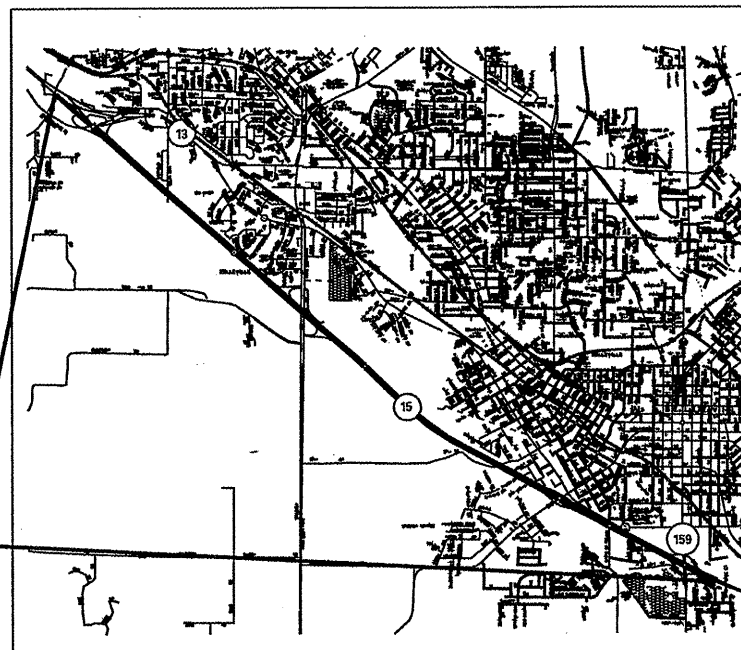

IL 15 (BELLEVILLE)
GROSS LENGTH = 33,528 FT. = 6.35 MILE
NET LENGTH = 33,528 FT. = 6.35 MILE



LOCATION 3
IL 3 (EAST ALTON)
GROSS LENGTH = 2,534.4 = 0.48 MILE
NET LENGTH = 2,534.4 FT. = 0.48 MILE

LOCATION 2
GROSS LENGTH = 11,880 = 2.25 MILE
NET LENGTH = 10,930 FT. = 2.07 MILE

STATE OF ILLINOIS
DEPARTMENT OF TRANSPORTATION
DIVISION OF HIGHWAYS

SUBMITTED 3/19 2010

Mass Lami
DEPUTY DIRECTOR OF HIGHWAYS, REGION ENGINEER

May 7 2010
Scott E. Stitt, P.E.
acting ENGINEER OF DESIGN AND ENVIRONMENT

May 7 2010
Christine M. Resola
DIRECTOR OF HIGHWAYS, CHIEF ENGINEER

PRINTED BY THE AUTHORITY
OF THE STATE OF ILLINOIS

GROSS LENGTH = 47,974.4 FT. = 9.08 MILE
NET LENGTH = 46,992.4 FT. = 8.90 MILE

90% FED.
10% STATE

IL 3 IL 15

SUMMARY OF QUANTITIES

SUMMARY OF QUANTITIES			URBAN	CONSTRUCTION TYPE CODE		
CODE NO	ITEM	UNIT	TOTAL QUANTITIES	LOCATION 1 ST CLAIR SFTY-ID	LOCATION 2 MADISON SFTY-ID	LOCATION 3 MADISON SFTY-ID
67100100	MOBILIZATION	L SUM	1	0.33	0.33	0.34
70102635	TRAFFIC CONTROL AND PROTECTION, STANDARD 701701	L SUM	1			1
78003100	PREFORMED PLASTIC PAVEMENT MARKING, TYPE B - LETTERS AND SYMBOLS	SO FT	539			539
78003110	PREFORMED PLASTIC PAVEMENT MARKING, TYPE B - LINE 4"	FOOT	209000	141106	59492	8402
78003140	PREFORMED PLASTIC PAVEMENT MARKING, TYPE B - LINE 8"	FOOT	18430	11774	5109	1547
78003150	PREFORMED PLASTIC PAVEMENT MARKING, TYPE B - LINE 12"	FOOT	581			581
78003180	PREFORMED PLASTIC PAVEMENT MARKING, TYPE B - LINE 24"	FOOT	262			262
X7030068	GROOVING FOR RECESSED PAVEMENT MARKING, LETTERS, NUMBERS AND SYMBOLS	SO FT	539			539
X7030070	GROOVING FOR RECESSED PAVEMENT MARKING 5"	FOOT	209000	141106	59492	8402
X7030076	GROOVING FOR RECESSED PAVEMENT MARKING 9"	FOOT	18430	11774	5109	1547
X7030078	GROOVING FOR RECESSED PAVEMENT MARKING 13"	FOOT	581			581
X7030090	GROOVING FOR RECESSED PAVEMENT MARKING 25"	FOOT	262			262

SUMMARY OF QUANTITIES			TOTAL QUANTITIES	CONSTRUCTION TYPE CODE		
CODE NO	ITEM	UNIT	TOTAL QUANTITIES			

FILE NAME *	USER NAME * eJforab	DESIGNED -	REVISED -
c:\p\work\p\dot\el\forab\08188899\0876488-sht\plan\dgn		DRAWN -	REVISED -
		CHECKED -	REVISED -
		DATE -	REVISED -

STATE OF ILLINOIS
DEPARTMENT OF TRANSPORTATION

SCALE:	SHEET NO. OF SHEETS	STA. TO STA.
--------	---------------------	--------------

VAR. RTE.	SECTION	COUNTY	TOTAL SHEETS	SHEET NO.
VAR.	D8 STRIPING 2010-1	MADISON/ST. CLAIR	8	3
FED. ROAD DIST. NO.		ILLINOIS FED. AID PROJECT		

CONTRACT NO. 76E08

PREFORMED PLASTIC PAVEMENT MARKING T-B LINE 4 INCH					
Milepoint	TO	Milepoint	GRV RCSD PVT MRKG 5" (FOOT)	WHITE (EDGE LINE & SKIP DASH) (FOOT)	YELLOW EDGE LINE (FOOT)
LOCATION #1 (IL 15)					
MP 0.0	TO	MP 6.35	141,106	74,729	66,377
Location #2 (IL 3 Homer Adams Pkwy)					
MP 0.0	TO	MP 2.25	59,492	32,964	26,528
Omission 2.00	TO	MP 2.18			
Location #3 (IL 3/111)					
MP 0.0	TO	MP 0.48	8,402	8,402	0
TOTAL:			209000	116095	92905

PREFORMED PLASTIC PAVEMENT MARKING T-B LET & SYM			
Milepoint	TO	Milepoint	GRV RCSD PVT LT & SYM (SQ. FT)
LOCATION #1 (IL 15)			
MP 0.0	TO	MP 6.35	0
Location #2 (IL 3 Homer Adams Pkwy)			
MP 0.0	TO	MP 2.25	0
Omission 2.0	TO	MP 2.18	
Location #3 (IL 3/111)			
MP 0.0	TO	MP 0.48	539
TOTAL:			539

PREFORMED PLASTIC PAVEMENT MARKING T-B LINE 8 INCH				
Milepoint	TO	Milepoint	GRV RCSD PVT MRKG 9" (FOOT)	WHITE GORE LINE (FOOT)
LOCATION #1 (IL 15)				
MP 0.0	TO	MP 6.35	11,774	11,774
Location #2 (IL 3 Homer Adams Pkwy)				
MP 0.0	TO	MP 2.25	5,109	5,109
Omission 2.0	TO	MP 2.18		
Location #3 (IL 3/111)				
MP 0.0	TO	MP 0.48	1,547	1,547
TOTAL:			18430	18430

PREFORMED PLASTIC PAVEMENT MARKING T-B LINE 12 INCH				
Milepoint	TO	Milepoint	GRV RCSD PVT MRKG 13" (FOOT)	WHITE CROSSWALK LINE (FOOT)
LOCATION #1 (IL 15)				
MP 0.0	TO	MP 6.35	0	0
Location #2 (IL 3 Homer Adams Pkwy)				
MP 0.0	TO	MP 2.25	0	0
Omission 2.0	TO	MP 2.18		
Location #3 (IL 3/111)				
MP 0.0	TO	MP 0.48	581	581
TOTAL:			581	581

PREFORMED PLASTIC PAVEMENT MARKING T-B LINE 24 INCH				
Milepoint	TO	Milepoint	GRV RCSD PVT MRKG 25" (FOOT)	WHITE STOP BAR (FOOT)
LOCATION #1 (IL 15)				
MP 0.0	TO	MP 6.35	0	0
Location #2 (IL 3 Homer Adams Pkwy)				
MP 0.0	TO	MP 2.25	0	0
Omission 2.0	TO	MP 2.18		
Location #3 (IL 3/111)				
MP 0.0	TO	MP 0.48	262	262
TOTAL:			262	262

FILE NAME *	USER NAME * a1fordb	DESIGNED -	REVISED -
ca:\pe_work\paidot\alfordb\08188899\0878	88-shr:plendgn	DRAWN -	REVISED -
	PLOT SCALE * 100.0000' / IN.	CHECKED -	REVISED -
	PLOT DATE * 3/18/2010	DATE -	REVISED -

STATE OF ILLINOIS
DEPARTMENT OF TRANSPORTATION

SCHEDULES

SCALE: SHEET NO. OF SHEETS STA. TO STA.

VAR. RTE.	SECTION	COUNTY	TOTAL SHEETS	SHEET NO.
VAR.	DB STRIPING 2010-1	WADSWORTH/ST. CLAIR	8	4
FED. ROAD DIST. NO.			ILLINOIS FED. AID PROJECT	
			CONTRACT NO. 76E08	

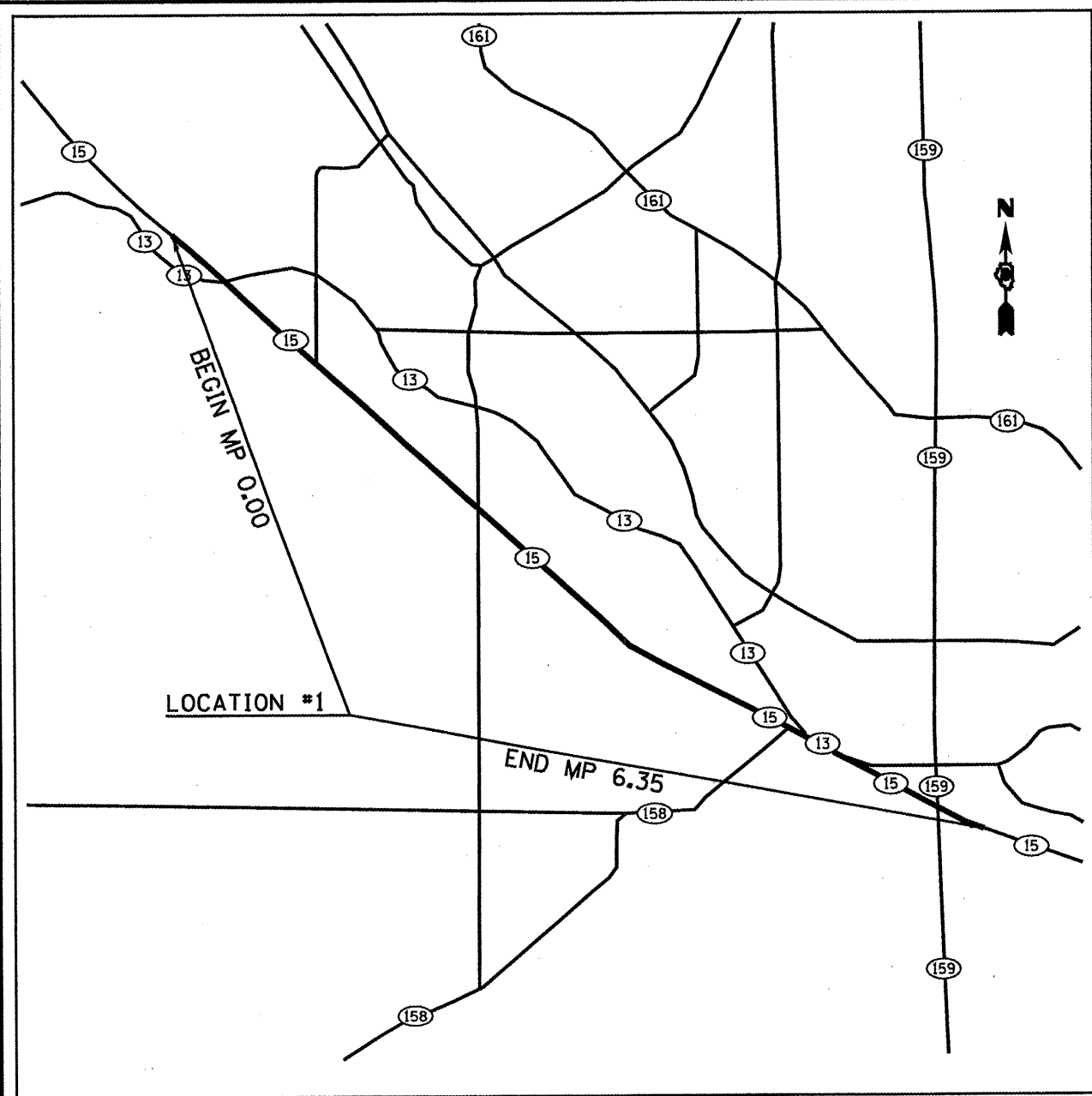

ST CLAIR COUNTY (NEAR BELLEVILLE)

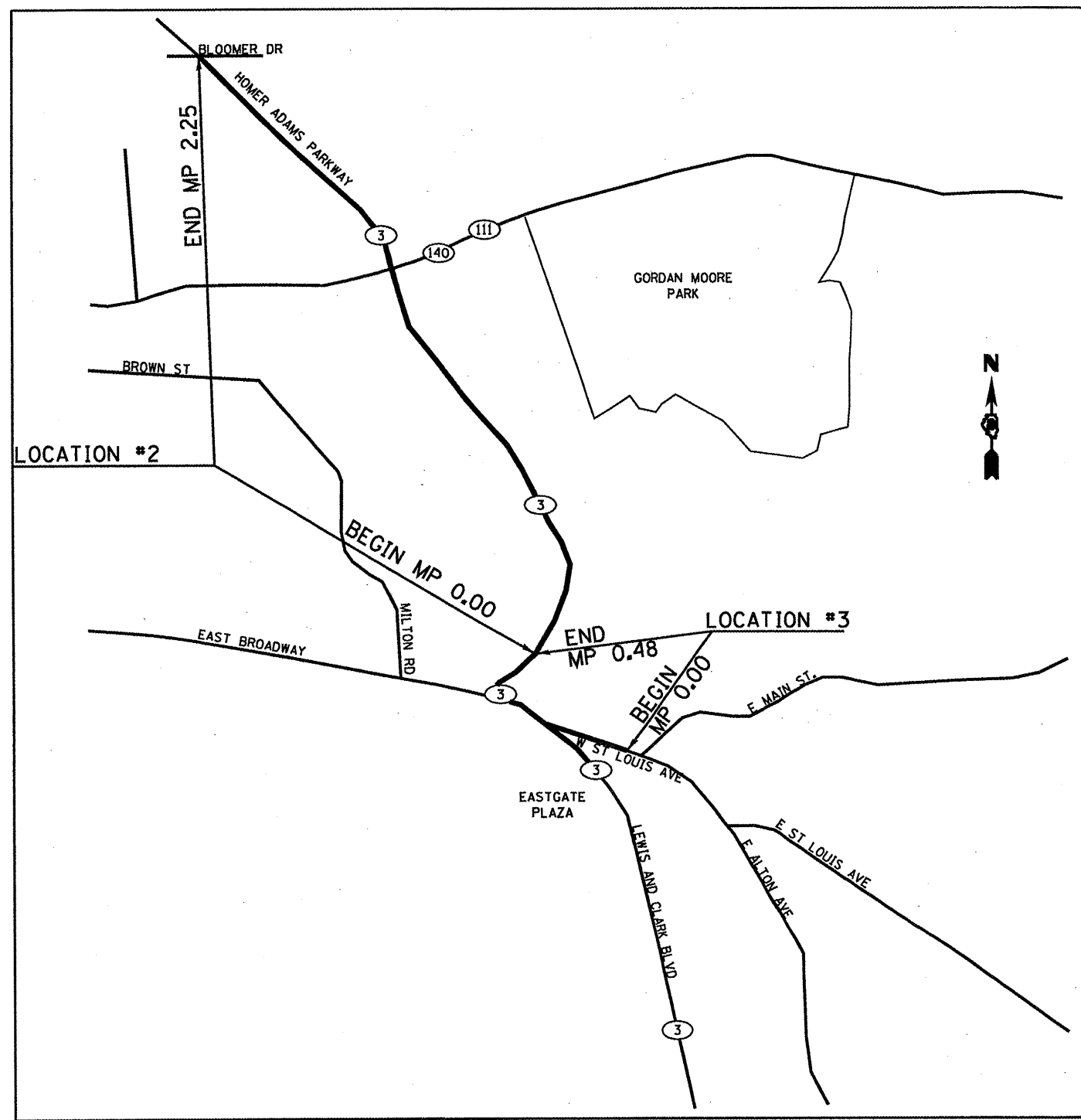

MADISON COUNTY (CITY OF ALTON)

FILE NAME *	USER NAME * alfordb	DESIGNED -	REVISED -
al:\pe_work\pedit\alfordb\08188899\0875	08-ahc-plan.dgn	DRAWN -	REVISED -
	PLOT SCALE = 100.0000' / IN.	CHECKED -	REVISED -
	PLOT DATE = 3/18/2019	DATE -	REVISED -

STATE OF ILLINOIS
DEPARTMENT OF TRANSPORTATION

GENERAL LOCATION MAPS

SCALE: SHEET NO. OF SHEETS STA. TO STA.

VAR. RTE.	SECTION	COUNTY	TOTAL SHEETS	SHEET NO.
VAR. DB STRIPING 2010-1	MADISON/STELAIN	8	5	
FED. ROAD DIST. NO. ILLINOIS FED. AID PROJECT		CONTRACT NO. 76E08		

BEGIN MP 0.00
LATINETTE LANE

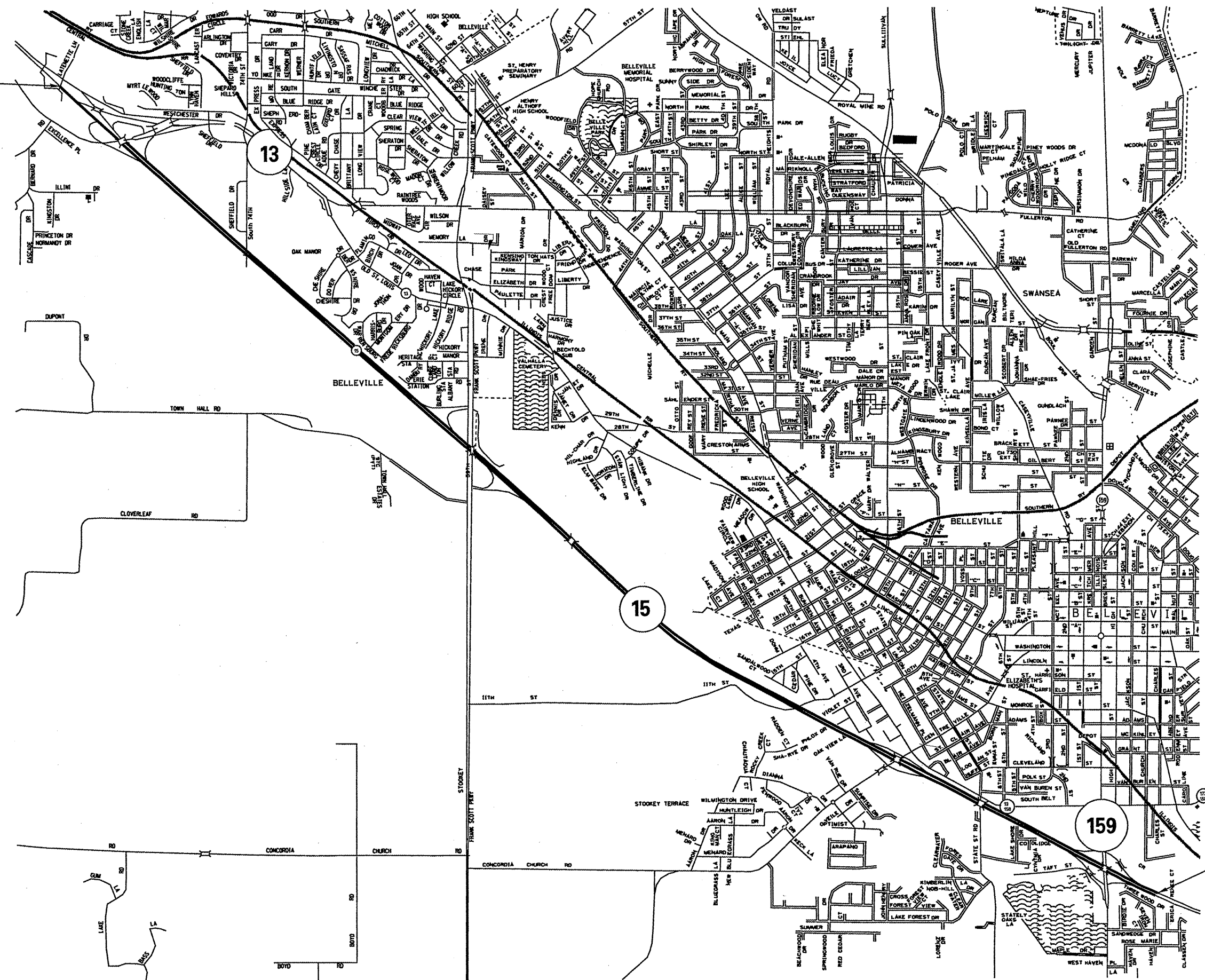

END MP 6.35
700FT EAST OF
IL 159

FILE NAME * c:\p\work\pedit\valford\08188899\0876-08-sht-plan.dgn	USER NAME * alfordb	DESIGNED -	REVISED -	STATE OF ILLINOIS DEPARTMENT OF TRANSPORTATION	SPECIFIC LOCATION MAP (ST CLAIR COUNTY) LOCATION 1	VAR. RTE.	SECTION	COUNTY	TOTAL SHEETS	SHEET NO.
	PLOT SCALE * 100.0000 / IN.	CHECKED -	REVISED -			VAR.	08 STRIPING 2010-1	MADISON/STCLAIR	8	6
	PLOT DATE * 3/18/2010	DATE -	REVISED -			CONTRACT NO. 76E08				
	SCALE:		SHEET NO. OF SHEETS			STA. TO STA.		FED. ROAD DIST. NO. ILLINOIS FED. AID PROJECT		

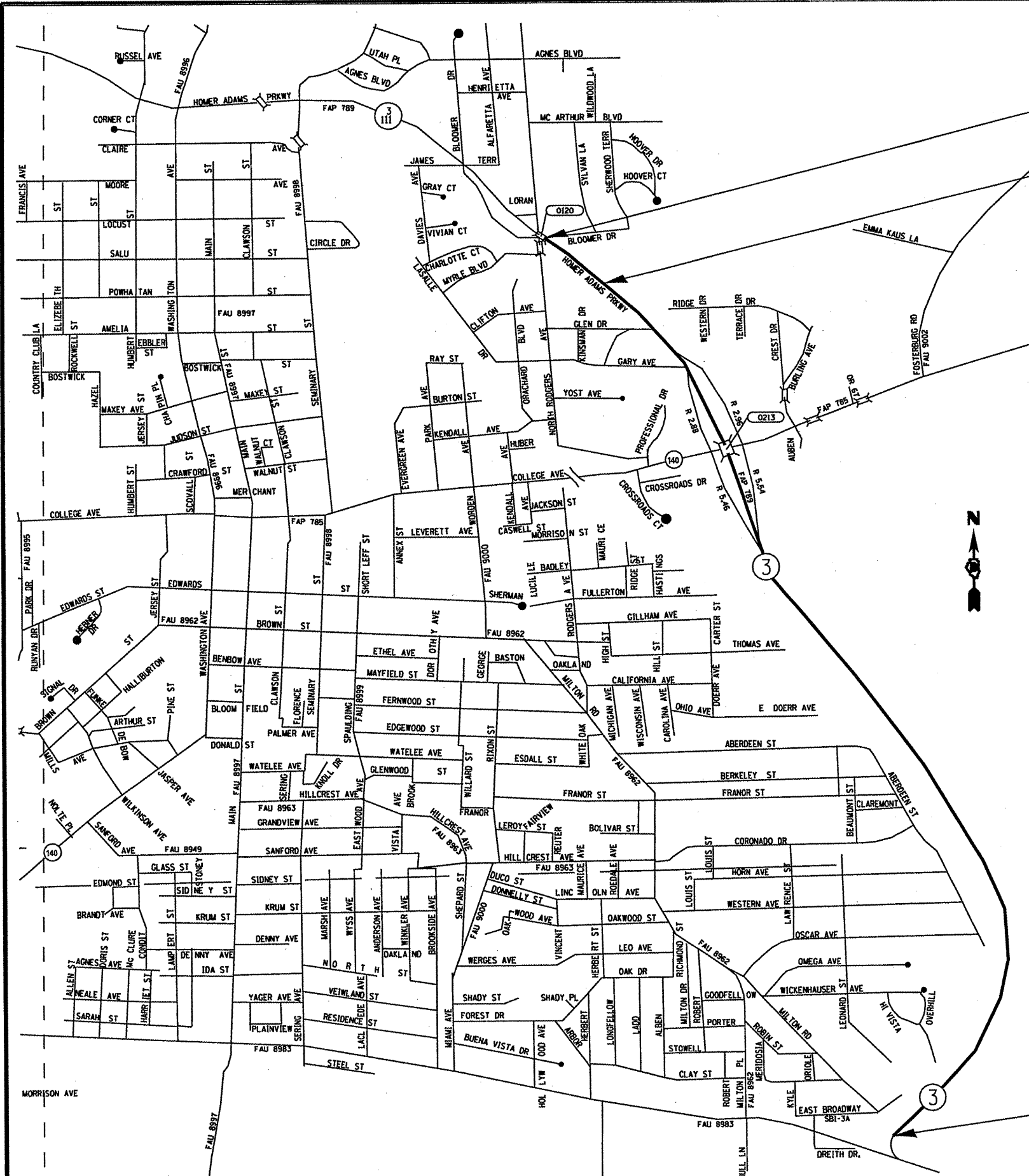

END MP 2.25
BLOOMER DR

OMISSION
MP 2.00 TO 2.18

BEGIN MP 0.00

STATE OF ILLINOIS
DEPARTMENT OF TRANSPORTATION

SPECIFIC LOCATION MAP (MADISON COUNTY)
LOCATION 2

FILE NAME :
USER NAME : oifordb
DRAWN :
CHECKED :
DATE :
PLOT SCALE = 100.0000' / IN.
PLOT DATE = 3/18/2010

DESIGNED -
DRAWN -
CHECKED -
DATE -

REVISED -
REVISED -
REVISED -
REVISED -

SCALE: SHEET NO. OF SHEETS STA. TO STA.

VAR. RTE.	SECTION	COUNTY	TOTAL SHEETS	SHEET NO.
	DB STRIPING 2010-1	MADISON/SICLAIN	8	7
CONTRACT NO. 76E08				
FED. ROAD DIST. NO. ILLINOIS/FED. AID PROJECT				

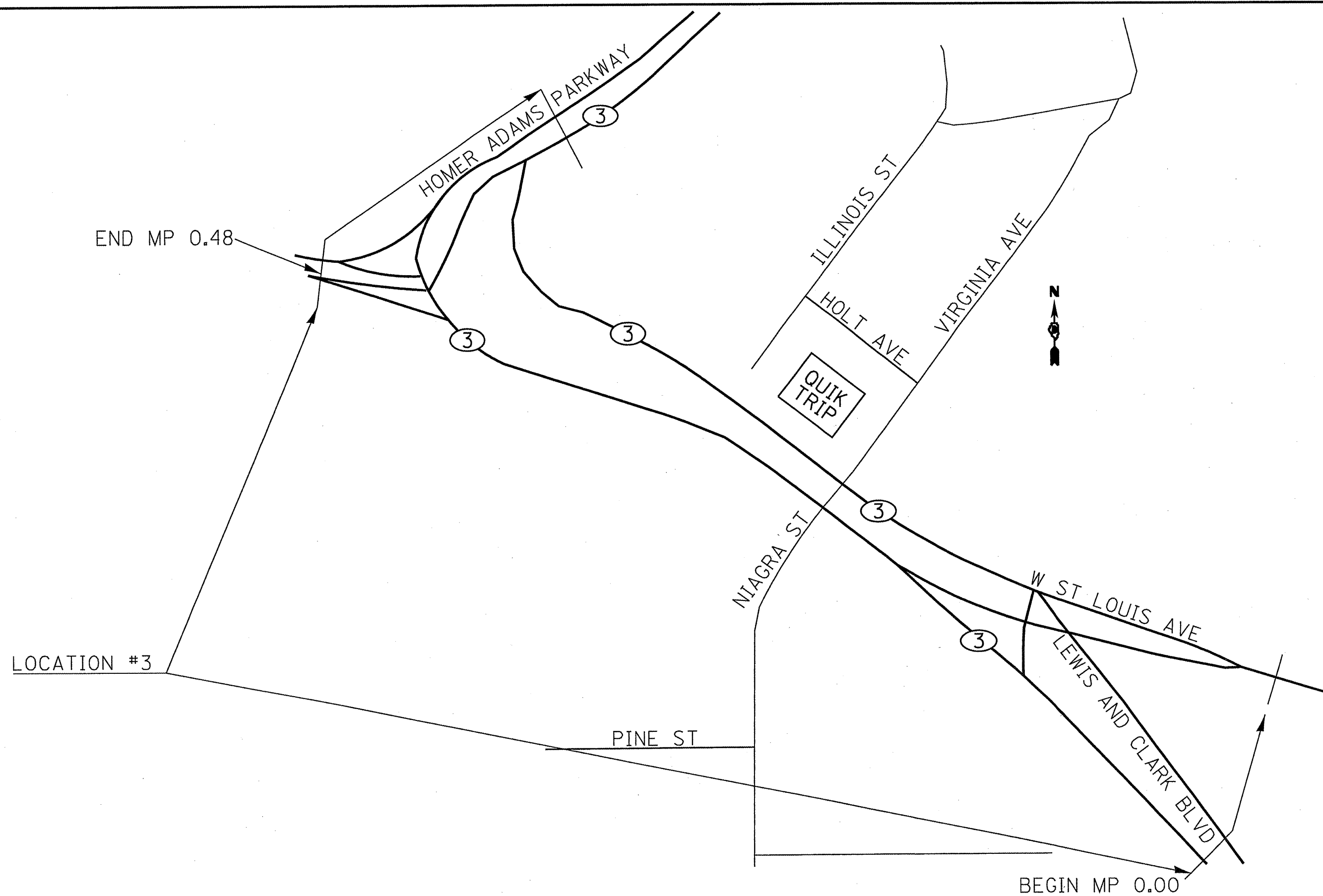

FILE NAME *	USER NAME = alfordb	DESIGNED -	REVISED -
c:\ps_work\psidot\fordb\0188899\0876	88-sht-plan.dgn	DRAWN -	REVISED -
PLOT SCALE = 100.0000' / IN.	CHECKED -	REVISED -	REVISED -
PLOT DATE = 3/18/2010	DATE -	REVISED -	REVISED -

**STATE OF ILLINOIS
DEPARTMENT OF TRANSPORTATION**

**SPECIFIC LOCATION MAP (MADISON COUNTY)
LOCATION 3**

SCALE: SHEET NO. OF SHEETS STA. TO STA.

VAR. RTE.	SECTION	COUNTY	TOTAL SHEETS	SHEET NO.
VAR. DB STRIPING 2010-1	MADISON/ST. LOUIS	8	8	8
FED. ROAD DIST. NO. ILLINOIS FED. AID PROJECT			CONTRACT NO. 76E08	