

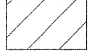





LEGEND

-  — HMA SURFACE COURSE 1 1/2"
-  — HOT-MIX ASPHALT BASE COURSE, 11"
HMA SURFACE COURSE 1 1/2"
SUB-BASE GRANULAR MATERIAL, TYPE A, 6"
-  — HOT-MIX ASPHALT BASE COURSE, 8 1/2"
HMA SURFACE COURSE 1 1/2"
SUB-BASE GRANULAR MATERIAL, TYPE A, 6"
-  — HOT-MIX ASPHALT SHOULDERS, 8"
-  — HOT-MIX ASPHALT SHOULDERS, 1 1/2"
-  — INCIDENTAL HOT-MIX ASPHALT
-  — AGGREGATE SHOULDERS, TYPE A, 8"

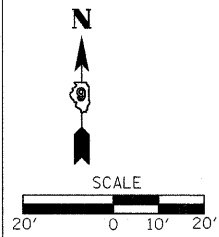

EXISTING ROW

IL 154

PROPOSED CULVERT
(SEE PROFILE SHEET)

MATCHLINE STA 78+00

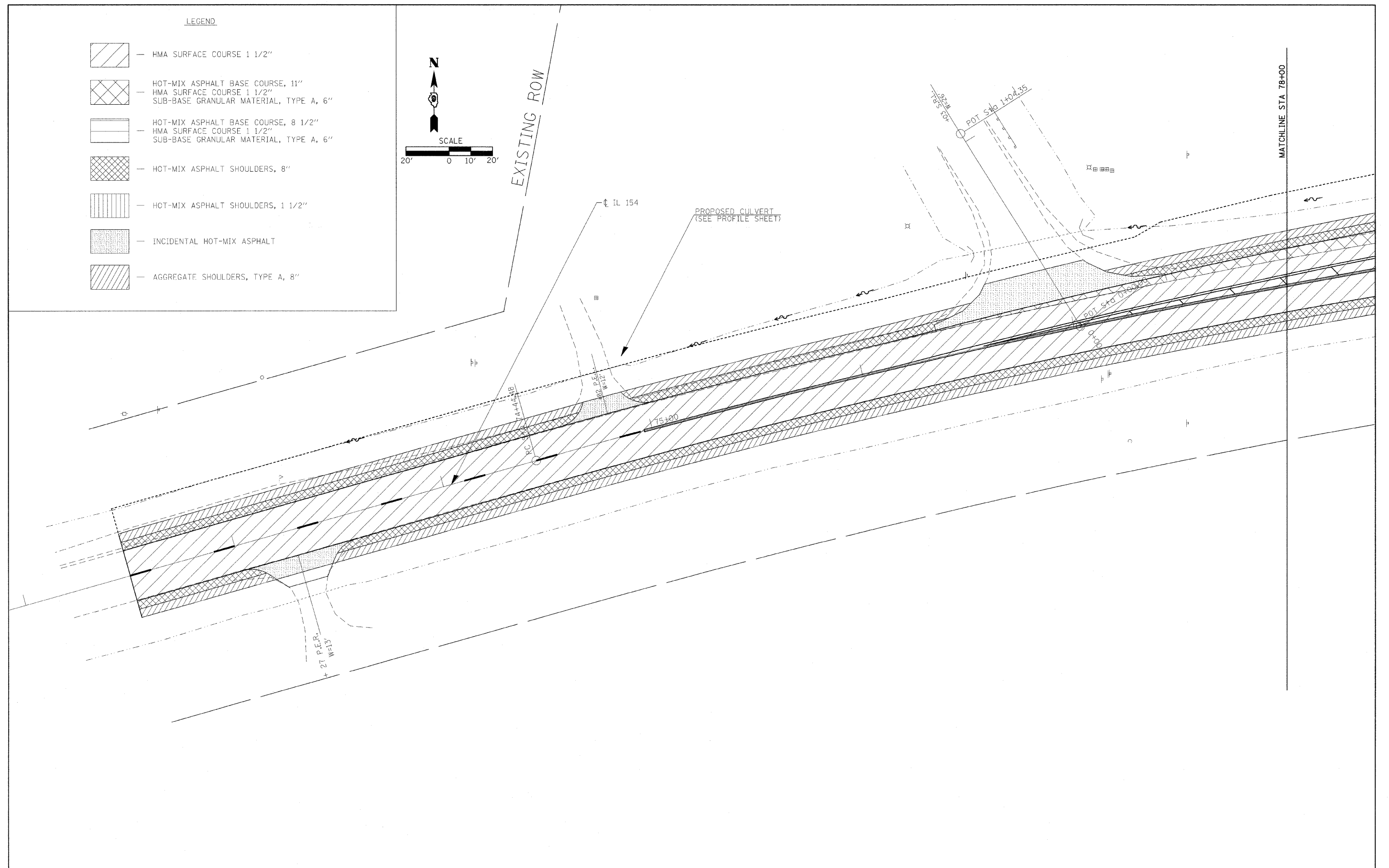

FILE NAME =	USER NAME = greenleam	DESIGNED -	REVISED -	STATE OF ILLINOIS DEPARTMENT OF TRANSPORTATION	CONSTRUCTION SHEET			F.A.P. RTE.	SECTION	COUNTY	TOTAL SHEETS	SHEET NO.			
ct:\pwork\pudot\greenleam\dms\1989\78098_sht.pln.dgn		DRAWN -	REVISED -		SCALE: 1"=20'	SHEET NO.	OF	SHEETS	STA.	TO STA.	841	108N-1	PERRY	76	20
		CHECKED -	REVISED -								CONTRACT NO. 78098				
		DATE -	REVISED -								ILLINOIS FED. AID PROJECT				