

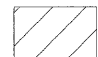





LEGEND

-  — HMA SURFACE COURSE 1 1/2"
-  — HOT-MIX ASPHALT BASE COURSE, 11"  
HMA SURFACE COURSE 1 1/2"  
SUB-BASE GRANULAR MATERIAL, TYPE A, 6"
-  — HOT-MIX ASPHALT BASE COURSE, 8 1/2"  
HMA SURFACE COURSE 1 1/2"  
SUB-BASE GRANULAR MATERIAL, TYPE A, 6"
-  — HOT-MIX ASPHALT SHOULDERS, 8"
-  — HOT-MIX ASPHALT SHOULDERS, 1 1/2"
-  — INCIDENTAL HOT-MIX ASPHALT
-  — AGGREGATE SHOULDERS, TYPE A, 8"

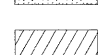
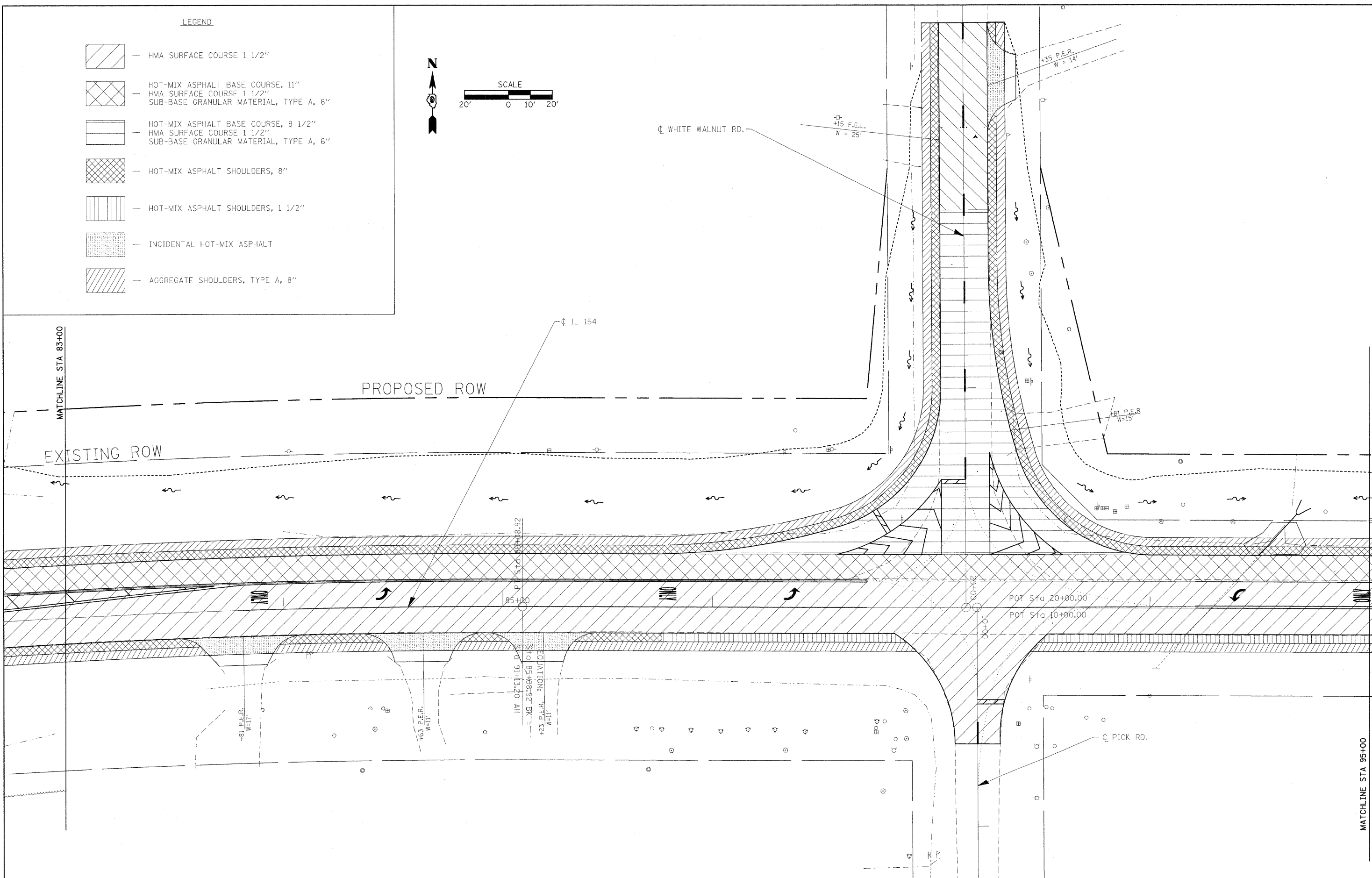
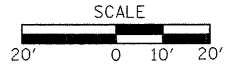

FILE NAME =  
 c:\p\work\p\dot\greenlees\cma51989\078298\_sht.pln.dgn

USER NAME = greenlees  
 DRAWN -  
 CHECKED -  
 DATE -

DESIGNED -  
 DRAWN -  
 CHECKED -  
 DATE -

REVISED -  
 REVISED -  
 REVISED -  
 REVISED -

**STATE OF ILLINOIS  
 DEPARTMENT OF TRANSPORTATION**

**CONSTRUCTION SHEET**

SCALE: 1"=20'    SHEET NO.    OF    SHEETS    STA.    TO STA.

F.A.P. RTE.	SECTION	COUNTY	TOTAL SHEETS	SHEET NO.
841	108N-1	PERRY	76	22
CONTRACT NO. 78098				
ILLINOIS FED. AID PROJECT				