

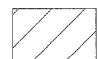





LEGEND

-  — HMA SURFACE COURSE 1 1/2"
-  — HOT-MIX ASPHALT BASE COURSE, 11"
HMA SURFACE COURSE 1 1/2"
SUB-BASE GRANULAR MATERIAL, TYPE A, 6"
-  — HOT-MIX ASPHALT BASE COURSE, 8 1/2"
HMA SURFACE COURSE 1 1/2"
SUB-BASE GRANULAR MATERIAL, TYPE A, 6"
-  — HOT-MIX ASPHALT SHOULDERS, 8"
-  — HOT-MIX ASPHALT SHOULDERS, 1 1/2"
-  — INCIDENTAL HOT-MIX ASPHALT
-  — AGGREGATE SHOULDERS, TYPE A, 8"

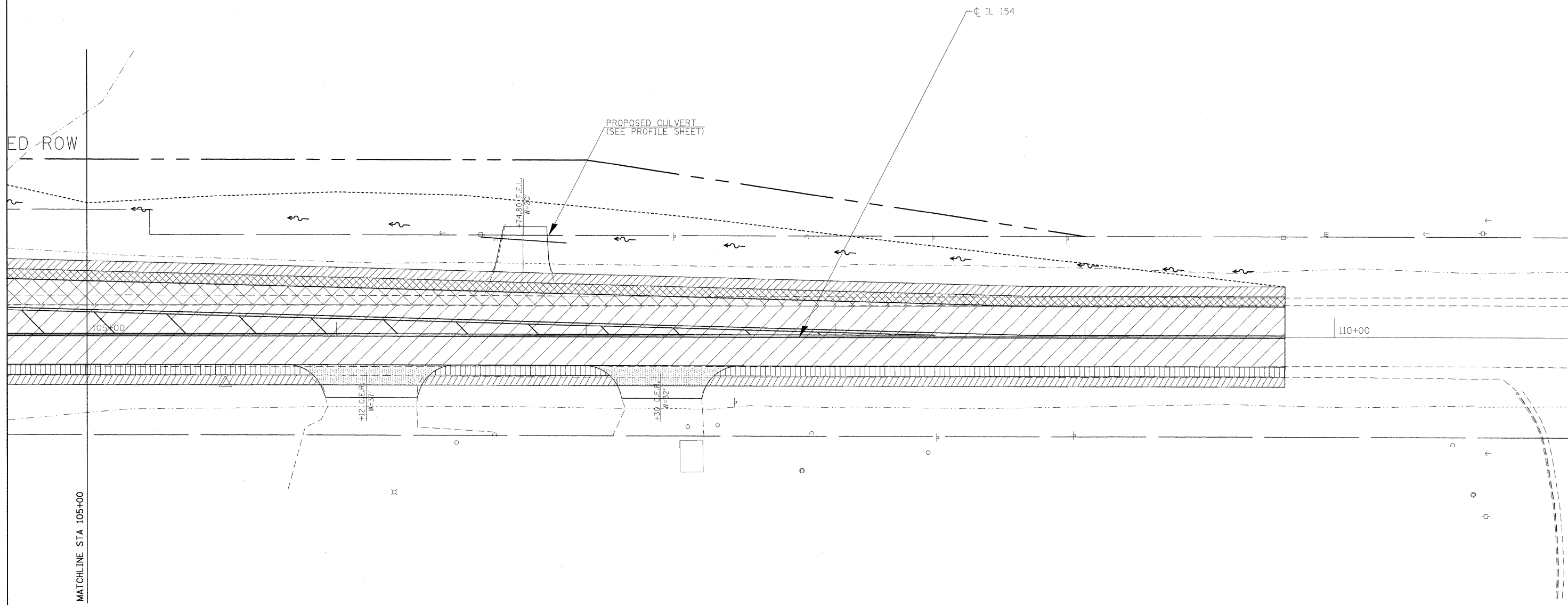
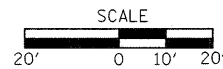

FILE NAME =	USER NAME = greenleesm	DESIGNED -	REVISED -	STATE OF ILLINOIS DEPARTMENT OF TRANSPORTATION	CONSTRUCTION SHEET				F.A.P. RTE.	SECTION	COUNTY	TOTAL SHEETS	SHEET NO.
cd:\pw\work\p\dot\greenleesm\dms51989\78098_sht.pln.dgn		DRAWN -	REVISED -		841	108N-1	PERRY	76	25				
PLOT SCALE = 20.1835' / IN.		CHECKED -	REVISED -		CONTRACT NO. 78098								
PLOT DATE = 1/27/2018		DATE -	REVISED -		ILLINOIS FED. AID PROJECT								
					SCALE: 1"=20'	SHEET NO.	OF	SHEETS	STA.	TO STA.			