

INDEX OF SHEETS

1	COVER SHEET AND INDEX OF SHEETS
2	SUMMARY OF QUANTITIES
3-6	TYPICAL SECTIONS AND CONTROL POINTS
7-12	SCHEDULES OF QUANTITIES AND GENERAL NOTES
13-18	C.H. 8 - PLAN AND PROFILE
19-28	C.H. 8 / TOW PATH RD - CROSS SECTIONS
29	1400 N. AVENUE - CROSS SECTIONS
30-31	TOW PATH ROAD - PLAN AND PROFILE
32	TOW PATH ROAD - CROSS SECTIONS
33	SHARED USE PATH - PLAN AND PROFILE
34-36	SHARED USE PATH - CROSS SECTIONS
37	BIKE PATH - PLAN AND PROFILE
38-39	BIKE PATH - CROSS SECTIONS
40	CANAL STREET - PLAN AND PROFILE
41	CANAL STREET - CROSS SECTIONS
42	INTERSECTION DETAILS
43	C.H. 8 - STAGE 1 PLAN
44-46	C.H. 8 - STAGE 1A CROSS SECTIONS
47-48	C.H. 8 - STAGE 1B CROSS SECTIONS
49	C.H. 8 - STAGE 2 PLAN
50-52	C.H. 8 - STAGE 2 CROSS SECTIONS
53-56	STORM WATER POLLUTION PREVENTION PLAN - C.H. 8
57	STORM WATER POLLUTION PREVENTION PLAN - SHARED USE PATH
58	STORM WATER POLLUTION PREVENTION PLAN - BIKE PATH
59	STORM WATER POLLUTION PREVENTION PLAN - CANAL STREET
60	STORM WATER POLLUTION PREVENTION PLAN - NOTES
61-66	STRUCTURAL DETAILS - C.H. 8 OVER POND CREEK
67-99	STRUCTURAL DETAILS - C.H. 8 OVER IAIS RR & HENNEPIN CANAL
100	TR 271A - TYPICAL SECTIONS
101-103	TR 271A - PLAN AND PROFILE
104-110	TR 271A - CROSS SECTIONS
111-113	TR 271A - STORM WATER POLLUTION PREVENTION PLAN
114-126	STRUCTURAL DETAILS - TR 271A OVER BUREAU CREEK
127	WHA STD. 804 TYPICAL APPLICATION FOR ROAD CLOSURE

STANDARDS

280001-05	TEMPORARY EROSION CONTROL SYSTEMS
406201-01	MAILBOX TURNOUT
420401-08	BRIDGE APPROACH PAVEMENT CONNECTOR
482001-02	HMA SHOULDER ADJACENT TO FLEXIBLE PAVEMENT
515001-03	NAME PLATE FOR BRIDGES
542301-02	PRECAST REINFORCED CONCRETE FLARED END SECTION
542401-01	METAL END SECTION FOR PIPE CULVERT
601001-03	SUB-SURFACE DRAINS
601101-01	CONCRETE HEADWALL FOR PIPE DRAIN
606101-04	TYPE A GUTTER (INLET, OUTLET & ENTRANCE)
606106-04	OUTLET TYPE 1 FOR TYPE A GUTTER
609006-05	BRIDGE APPROACH PAVEMENT (DRAIN DETAIL)
630001-08	STEEL PLATE BEAM GUARDRAIL
630301-05	SHOULDER WIDENING FOR TYPE 1 (SPECIAL) GUARDRAIL TERMINALS
631031-08	TRAFFIC BARRIER TERMINAL, TYPE 6
635006-03	REFLECTOR AND TERMINAL MARKER PLACEMENT
635011-02	REFLECTOR MARKER AND MOUNTING DETAILS
665001-02	WOVEN WIRE FENCE
701006-03	OFF-ROAD OPERATIONS, 2L, 2W, 15' TO 24" FROM PAVEMENT EDGE
701201-03	LANE CLOSURE, 2L, 2W, DAY ONLY, FOR SPEEDS ≥ 45 MPH
701301-03	LANE CLOSURE, 2L, 2W, SHORT TIME OPERATIONS
701901-01	TRAFFIC CONTROL DEVICES
720011-01	METAL POSTS FOR SIGNS, MARKERS, & DELINEATORS
728001-01	TELESCOPING STEEL SIGN SUPPORT
729001-01	APPLICATIONS OF TYPES A & B METAL (FOR SIGNS & MARKERS)
780001-02	TYPICAL PAVEMENT MARKINGS
B.L.R. 21-8	TYPICAL APPLICATION OF TRAFFIC CONTROL DEVICES FOR CONSTRUCTION OF RURAL LOCAL HIGHWAYS
B.L.R. 27-1	TRAFFIC BARRIER TERMINAL TYPE 5A

STATE OF ILLINOIS
BUREAU COUNTY
PLANS FOR PROPOSED
LOCAL AGENCY IMPROVEMENTS
MAJOR BRIDGE PROGRAM
SECTION 05-00195-00-BR
FAS 188 (C.H. 8) & TR 271A
PROJECT BRS-0188(118)
JOB NO. C-93-031-09
CONTRACT NO. 87380

NAME AND ADDRESS OF UTILITIES	TYPE
COMCAST ATTN: DONNA ZIES 4450 KISHWAUKEE ST. ROCKFORD, IL 61109 (815) 509-7876	CABLE TV
VERIZON NORTH ATTN: TERRY SPURGEON 111 S. MAIN ST. KEWANEE, IL 61443 309-853-6293	TELEPHONE
MCI - VERIZON BUSINESS ATTN: INVESTIGATIONS 2400 N. GLENVILLE DRIVE RICHARDSON, TX 75082 972-729-6322	TELEPHONE
AMEREN IP CONTACT KATHY CROMWELL 1450 RED ADAMS ROAD KEWANEE, IL 61443 309-852-2963	ELECTRIC
VILLAGE OF WYANET McCLURE ENGINEERING ATTN: JOHN KUSEK 1138 COLUMBUS ST. OTTAWA, IL 61350 815-433-2080	SEWER/WATER

COUNTY HIGHWAY 8
PROJECT ENDS
STA 41+00

PROPOSED STRUCTURE
S.N. 006-3247 INCL.
BRIDGE APPROACH PVT.
STA. 33+87.78 TO
38+12.22 (424.44')

COUNTY HIGHWAY 8
PROJECT BEGINS
STA 25+00

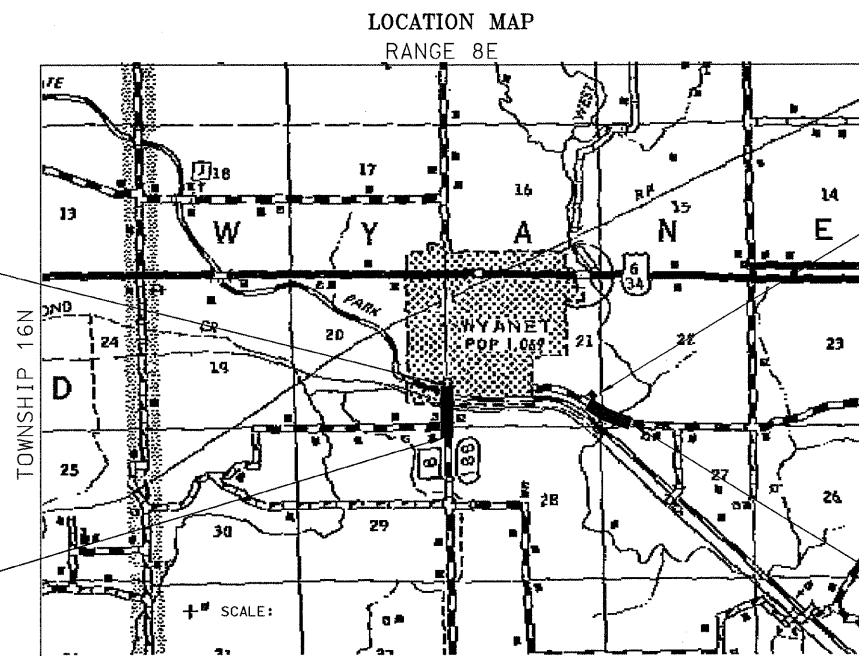

TR 271A
PROJECT BEGINS
STA. 54+90

PROPOSED STRUCTURE
S.N. 006-4376 INCL.
BRIDGE APPROACH PVT.
STA. 59+11.25 TO
60+88.75 (177.5')

TR 271A
PROJECT ENDS
STA 65+30

LOCATION MAP SCALE

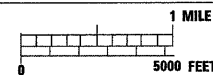

SCALES:

PLAN AND PROFILE



* CROSS SECTIONS



* FOR SHEETS 23-26 1"=20'

PROJECT LENGTH

CH 8 =	1,600' = 0.30 MILES
TR 271A =	1,040' = 0.20 MILES
1400 N =	80' = 0.02 MILES
TOW PATH ROAD =	574' = 0.11 MILES
SHARED USE PATH =	420' = 0.08 MILES
BIKE PATH =	142' = 0.03 MILES
CANAL ST. =	114' = 0.02 MILES

TOTAL PROJECT NET LENGTH=
3,970' = 0.752 MILES

BUREAU COUNTY

APPROVED 03/26/10 DATE
John E. Fran COUNTY ENGINEER

PASSED 04/02/10 DATE
Gregory J. ... DISTRICT 3 IMPLEMENTATION ENGINEER

RELEASING FOR BID
BASED ON LIMITED
REVIEW 04/02/10 DATE
Gregory J. ... DEPUTY DIRECTOR OF HIGHWAYS, REGION 2 ENGINEER



DESIGN CRITERIA				
FUNCTIONAL CLASSIFICATION	HIGHWAY	ADT (2030)	% TRUCKS	DESIGN SPEED
MAJOR COLLECTOR	COUNTY HIGHWAY 8	1420	7%	55 MPH
MINOR COLLECTOR	T.R. 271A	650	3%	50 MPH
LOCAL ROAD	CANAL STREET	650	3%	30 MPH



809 East Second Street Dixon, Illinois 61021
Phone 815.284.3381 Fax 815.284.3385
Design Firm #184-000918
www.willetthofmann.com