

DATE _____
 BY _____
 SURVEYED _____
 PLOTTED _____
 NOTE BOOK _____
 AREAS CHECKED _____
 NO. _____

DATE _____
 BY _____
 ORIGINAL SURVEY _____
 PLOTTED _____
 NOTE BOOK _____
 AREAS CHECKED _____
 NO. _____

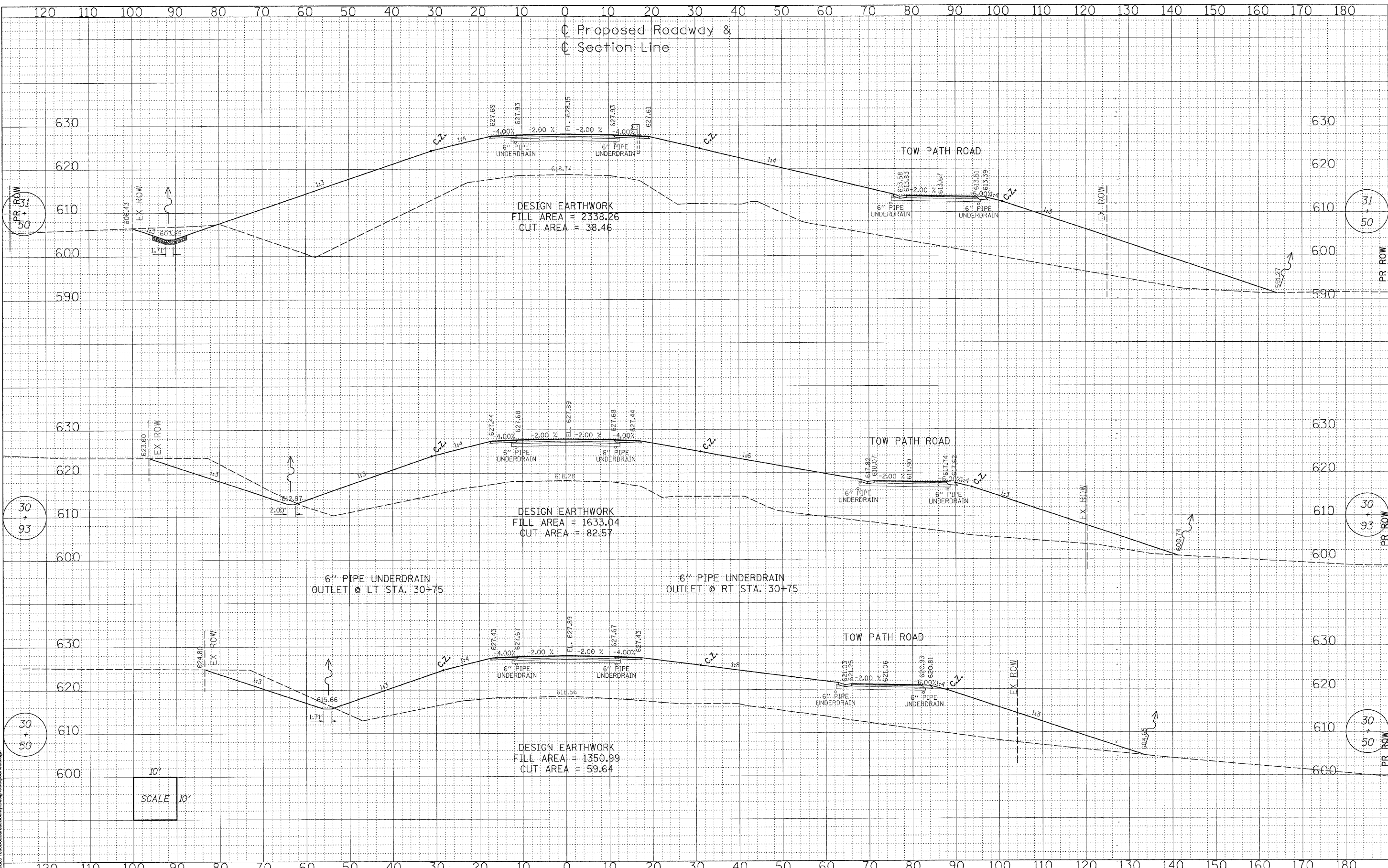

SCALE 10'

WILLETT, HOFMANN & ASSOCIATES, INC. CONSULTING ENGINEERS 808 East Second Street Dixon, IL 61021 Phone 815.284.3381 Fax 815.294.3385 Design Firm # 184-00818 www.willett-hofmann.com	USER NAME = _____ DESIGNED - _____ DRAWN - _____ PLOT SCALE = _____ CHECKED - _____ PLOT DATE = _____ DATE - _____ REVISED - _____ REVISED - _____ REVISED - _____	BUREAU COUNTY BRIDGE REPLACEMENT FAS 188 (C.H. 8) OVER IAIS RAILROAD & THE HENNEPIN CANAL	C.H. 8 / TOW PATH RD - CROSS SECTIONS	F.A.S. RTE. 188 SECTION 05-00195-00-BR COUNTY BUREAU TOTAL SHEETS 127 SHEET NO. 23 STA. 30+50.00 TO STA. 31+50.00 CONTRACT NO. 87380 FED. ROAD DIST. NO. 7 ILLINOIS FED. AID PROJECT BRS-0188(118)
---	---	--	--	---