

| | |
|---------------|--|
| DATE | |
| BY | |
| FINAL SURVEY | |
| SURVEYED | |
| PLOTTED | |
| NOTE BOOK | |
| AREAS | |
| AREAS CHECKED | |
| NO. | |

| | |
|-----------------|--|
| DATE | |
| BY | |
| ORIGINAL SURVEY | |
| SURVEYED | |
| PLOTTED | |
| NOTE BOOK | |
| AREAS | |
| AREAS CHECKED | |
| NO. | |

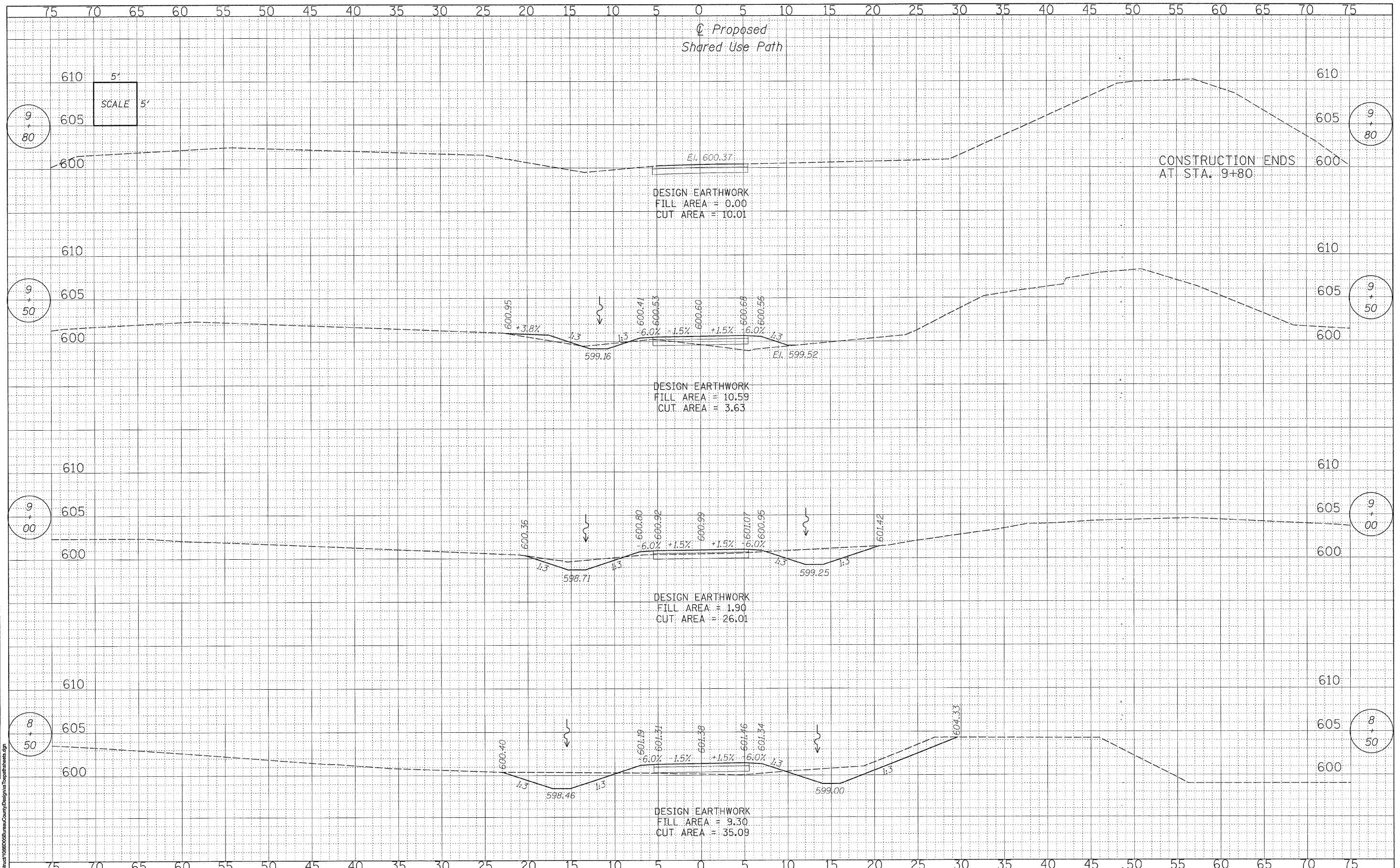

WILLET, HOFMANN & ASSOCIATES, INC.
CONSULTING ENGINEERS
609 East Second Street Dixon, IL 61021
Phone 815.284.3381 Fax 815.294.3385
Design Firm # 184-03918
www.willett-hofmann.com

| | | |
|--------------|------------|-----------|
| USER NAME = | DESIGNED - | REVISED - |
| PLOT SCALE = | DRAWN - | REVISED - |
| PLOT DATE = | CHECKED - | REVISED - |
| | DATE - | REVISED - |

BUREAU COUNTY
BRIDGE REPLACEMENT
FAS 188 (C.H. 8) OVER IAIS RAILROAD & THE HENNEPIN CANAL

SHARED USE PATH - CROSS SECTIONS

| | | | | |
|---------------------------------------------------------------|----------------|--------------------|--------------|-----------|
| F.A.S. RTE. | SECTION | COUNTY | TOTAL SHEETS | SHEET NO. |
| 188 | 05-00195-00-BR | BUREAU | 127 | 36 |
| STA. 8+50.00 TO STA. 9+80.00 | | CONTRACT NO. 87380 | | |
| FED. ROAD DIST. NO. 1 ILLINOIS FED. AID PROJECT BRS-0188(118) | | | | |