

DATE	
BY	
FINAL SURVEY	SURVEYED
NOTE BOOK	PLOTTED
NO.	TEMPLATE
	AREAS CHECKED

DATE	
BY	
ORIGINAL SURVEY	SURVEYED
NOTE BOOK	PLOTTED
NO.	TEMPLATE
	AREAS CHECKED

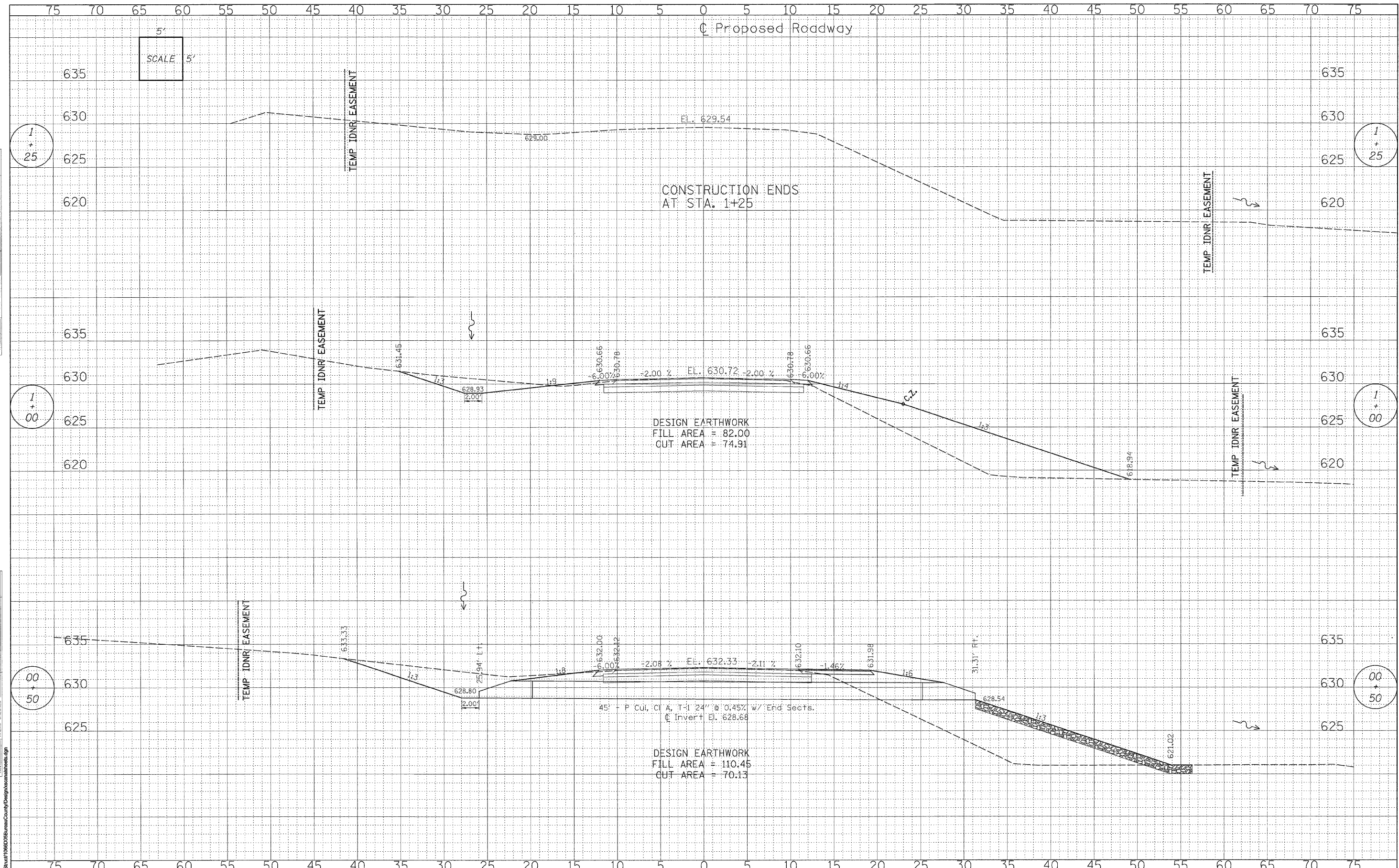

FILE NAME: S:\Struct\096205BureauCounty\Design\Bureau\Bureau.dwg

WILLETT, HOFMANN & ASSOCIATES, INC.
CONSULTING ENGINEERS
 809 East Second Street Dixon, IL 61021
 Phone: 815.284.3381 Fax: 815.284.3385
 Design Firm # 134-0018
 www.willett-hofmann.com

USER NAME =	DESIGNED -	REVISED -
PLOT SCALE =	DRAWN -	REVISED -
PLOT DATE =	CHECKED -	REVISED -
	DATE -	REVISED -

BUREAU COUNTY
BRIDGE REPLACEMENT
FAS 188 (C.H. 8) OVER IAIS RAILROAD & THE HENNEPIN CANAL

CANAL STREET - CROSS SECTIONS

F.A.S. RTE. 188	SECTION 05-00195-00-BR	COUNTY BUREAU	TOTAL SHEETS 127	SHEET NO. 41
STA. 00+50.00 TO STA. 1+00.00		CONTRACT NO. 87380		
FED. ROAD DIST. NO. 7 ILLINOIS FED. AID PROJECT BRS-0186(18)				