

EXISTING STRUCTURES: S.N. 006-3244 & 006-3245

Originally built in 1931 as S.A. Rt. 8 under Sections W, W-B, W-B-2, W-C & W-V, 15D and rehabilitated in 1981 under Section 79-00122-00-BR. Existing structure number 006-3244 consists of a single span (1 @ 115'-0") steel Pratt Thru Truss and two single span (1 @ 59'-10 1/2" & 56'-7 3/8") precast, prestressed deck beam approach spans, while structure number 006-3245 consists of a single span (1 @ 67'-8") steel thru girder with two single span (1 @ 43'-4 3/8" & 49'-5 1/2") precast, prestressed concrete deck beam approach spans. 400'-8 7/8" back to back of abutments and 22'-9" clear roadway width. Structure to be removed and replaced. Road shall be closed to traffic.

Bench Mark: Chis. "□" on the Northwest Hubguard on Bridge over Railroad, El. 632.26

Bench Mark: Chis. "□" on the Northwest Wingwall of Approach Structure, North of Bridge over Hennepin Canal, El. 632.05

The existing steel Pratt Thru Truss shall be salvaged and relocated to TR 271A over West Bureau Creek.

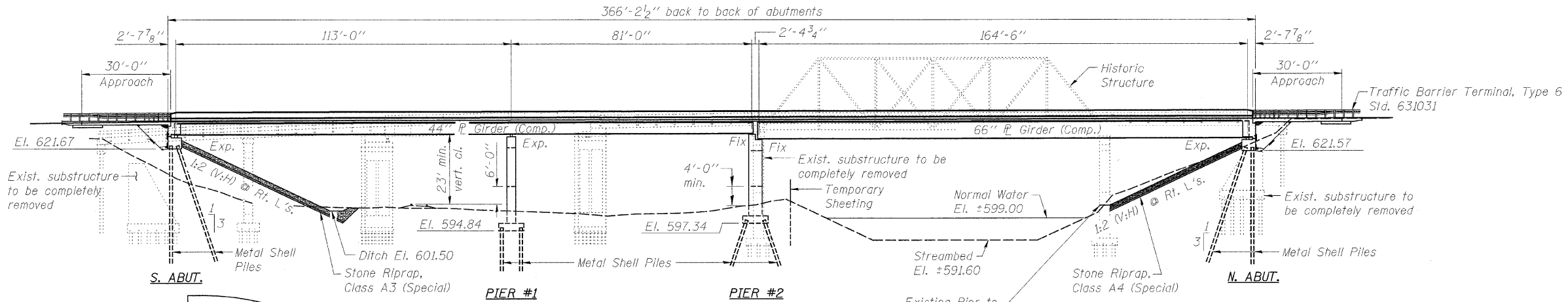

IAIS RR & HENNEPIN CANAL
BUILT 2010 BY
BUREAU COUNTY
SECTION 05-00195-00-BR
F.A.S. RT. 188 STATION 36+00
STR. NO. 006-3247 LOADING HL93

NAME PLATE LETTERING
Refer To Std. 515001-03

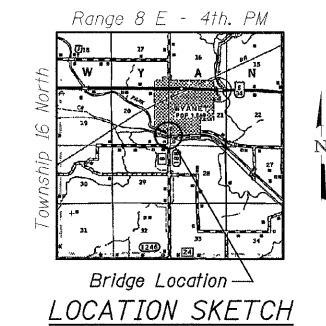

Brian K. Converse
DATE: MARCH 25, 2010
EXPIRES 11/30/10

"I Certify That To The Best Of My Knowledge, Information And Belief, This Bridge Design Is Structurally Adequate For The Design Loading Shown On The Plans, The Design Is An Economical One Complies With Requirements Of The Current 'AASHTO Standard Specifications For Highway Bridges'."

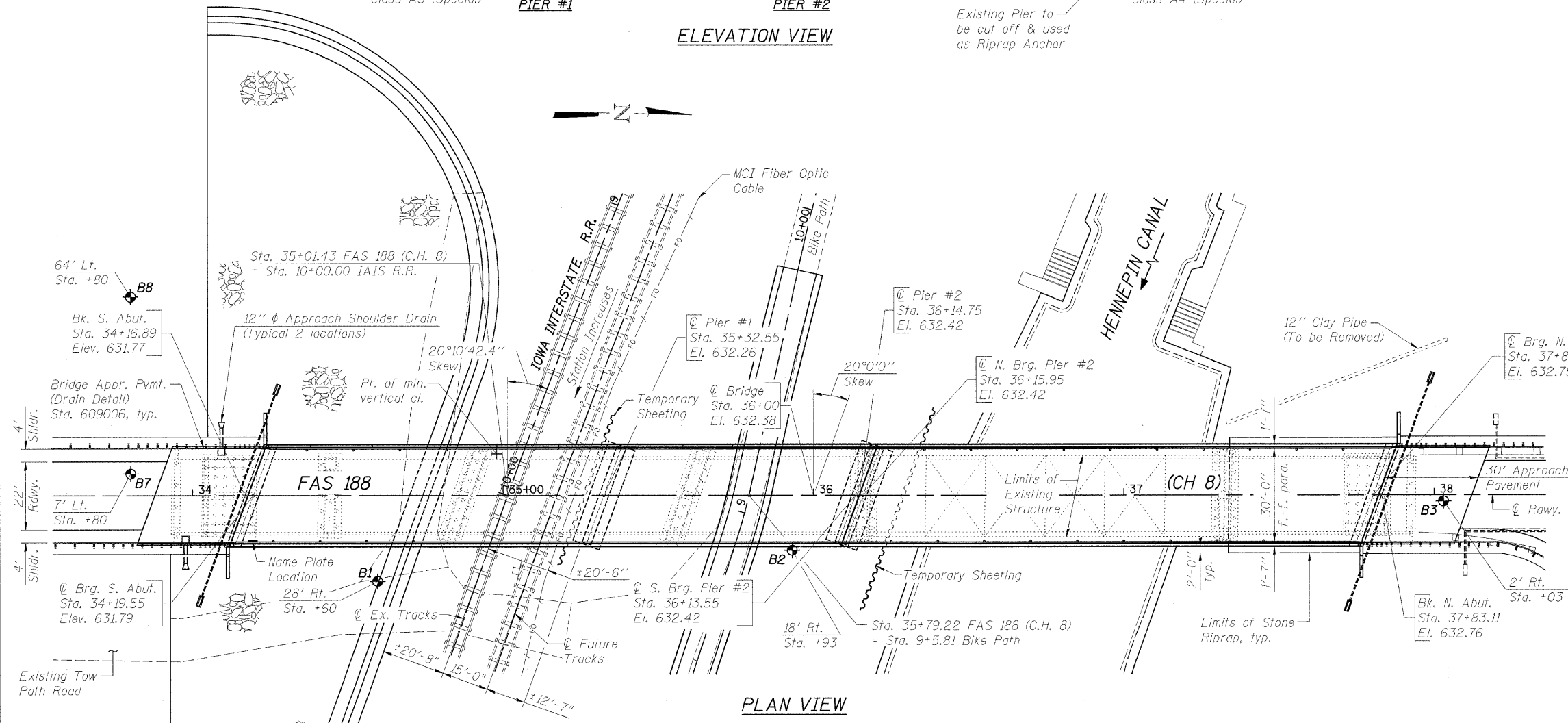

**GENERAL PLAN & ELEVATION
C.H. 8 OVER IOWA INTERSTATE RAILROAD
& THE HENNEPIN CANAL
STATION 36+00
S.N. 006-3247**

WHA JOB NUMBER 1066D05		Designed By: B. K. Converse Date: 1/10										
		Checked By: M. A. Cackley Date: 1/10										
		Drawn By: F. D. Lachat Date: 1/10										
STRUCTURAL SHEET NO. 1B OF 33B SHEETS	<table border="1"> <tr> <th>F.A.S. RTE.</th> <th>SECTION</th> <th>COUNTY</th> <th>TOTAL SHEETS</th> <th>SHEET NO.</th> </tr> <tr> <td>188</td> <td>05-00195-00-BR</td> <td>BUREAU</td> <td>127</td> <td>67</td> </tr> </table>	F.A.S. RTE.	SECTION	COUNTY	TOTAL SHEETS	SHEET NO.	188	05-00195-00-BR	BUREAU	127	67	CONTRACT NO. 87380
F.A.S. RTE.	SECTION	COUNTY	TOTAL SHEETS	SHEET NO.								
188	05-00195-00-BR	BUREAU	127	67								
FED. ROAD DIST. NO. 7 ILLINOIS FED. AID PROJECT BR5-0188(118)												

FILE NAME = s:\Structure\1066D05\Bureau\County\Drawings\1066D05PlanElev.dgn