

LEFT EDGE OF APPROACH PAVEMENT

Location	Station	Offset	Theoretical Grade Elevations
A	33+93.39	-15.4167	631.23
B	34+03.39	-15.4167	631.33
C	34+13.39	-15.4167	631.43
D	34+23.27	-15.0833	631.52

LEFT EDGE OF TRAFFIC LANE

Location	Station	Offset	Theoretical Grade Elevations
A	33+91.78	-11	631.30
B	34+01.78	-11	631.40
C	34+11.78	-11	631.50
D	34+21.78	-11	631.59

CENTERLINE

Location	Station	Offset	Theoretical Grade Elevations
A	33+87.78	0	631.47
B	33+97.78	0	631.58
C	34+07.78	0	631.68
D	34+17.78	0	631.77

RIGHT EDGE OF TRAFFIC LANE

Location	Station	Offset	Theoretical Grade Elevations
A	33+83.78	11	631.21
B	33+93.78	11	631.32
C	34+03.78	11	631.42
D	34+13.78	11	631.52

RIGHT EDGE OF APPROACH PAVEMENT

Location	Station	Offset	Theoretical Grade Elevations
A	33+82.17	15.4167	631.10
B	33+92.17	15.4167	631.22
C	34+02.17	15.4167	631.32
D	34+12.29	15.0833	631.42

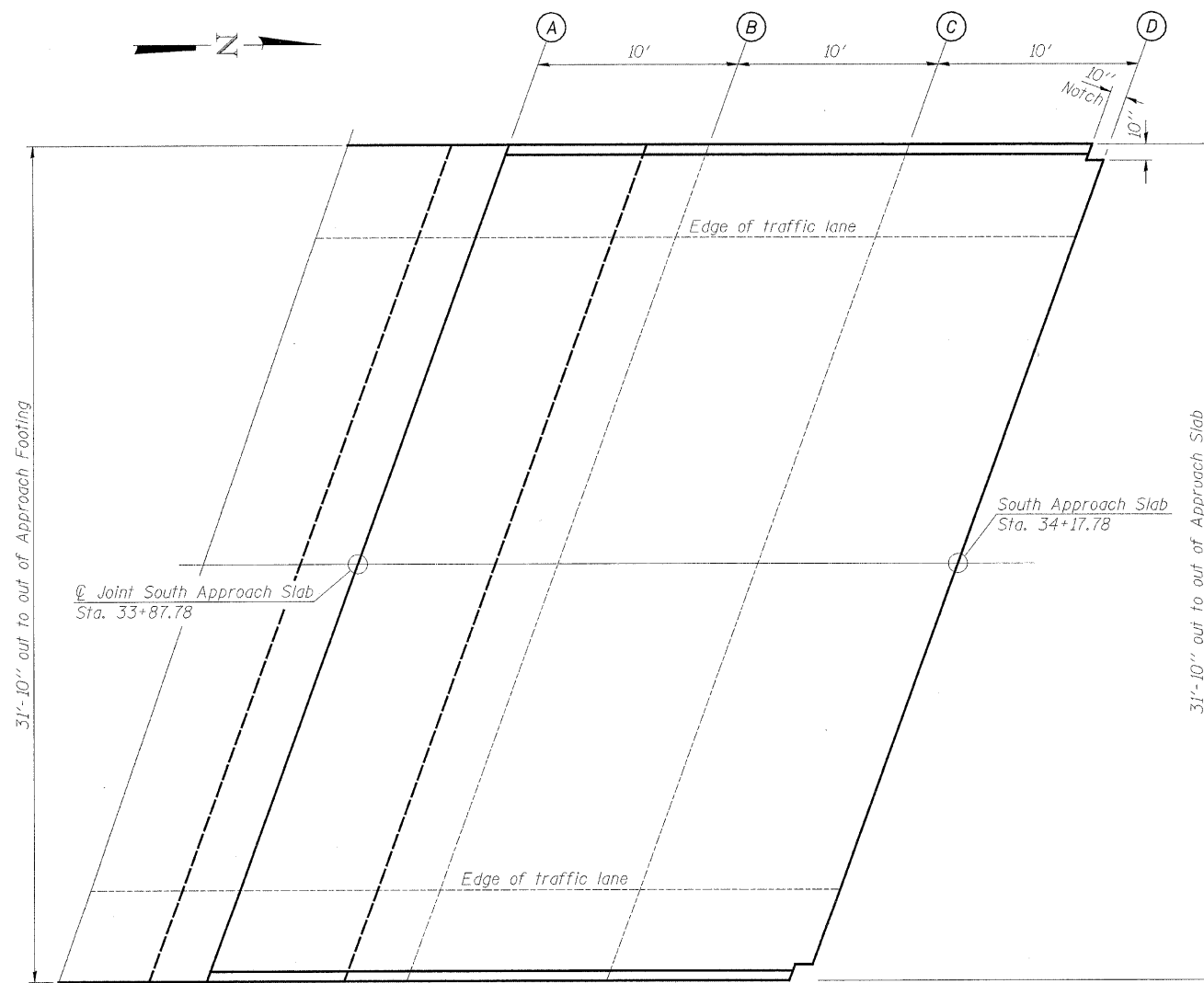

PLAN

TOP OF APPROACH SLAB ELEVATIONS - SOUTH
 C.H. 8 OVER IOWA INTERSTATE RAILROAD
 & THE HENNEPIN CANAL
 STATION 36+00
 S.N. 006-3247
 WHA #1066D05

STRUCTURAL SHEET NO. 7B OF 33B SHEETS	F.A.S. RTE.	SECTION	COUNTY	TOTAL SHEETS	SHEET NO.
	188	05-00195-00-BR	BUREAU	127	73
	CONTRACT NO. 87380				
FED. ROAD DIST. NO. 7 ILLINOIS FED. AID PROJECT BRS-0188(118)					