

DATE _____ BY _____
 PLAN SURVEYED _____
 NOTE BOOK _____
 ALIGNMENT CHECKED _____
 ELEVATION CHECKED _____
 CAD FILE NAME _____

DATE _____ BY _____
 PROFILE SURVEYED _____
 NOTE BOOK _____
 GRADES CHECKED _____
 ELEVATION CHECKED _____
 STRUCTURE NOTATIONS CHECKED _____

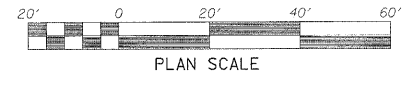
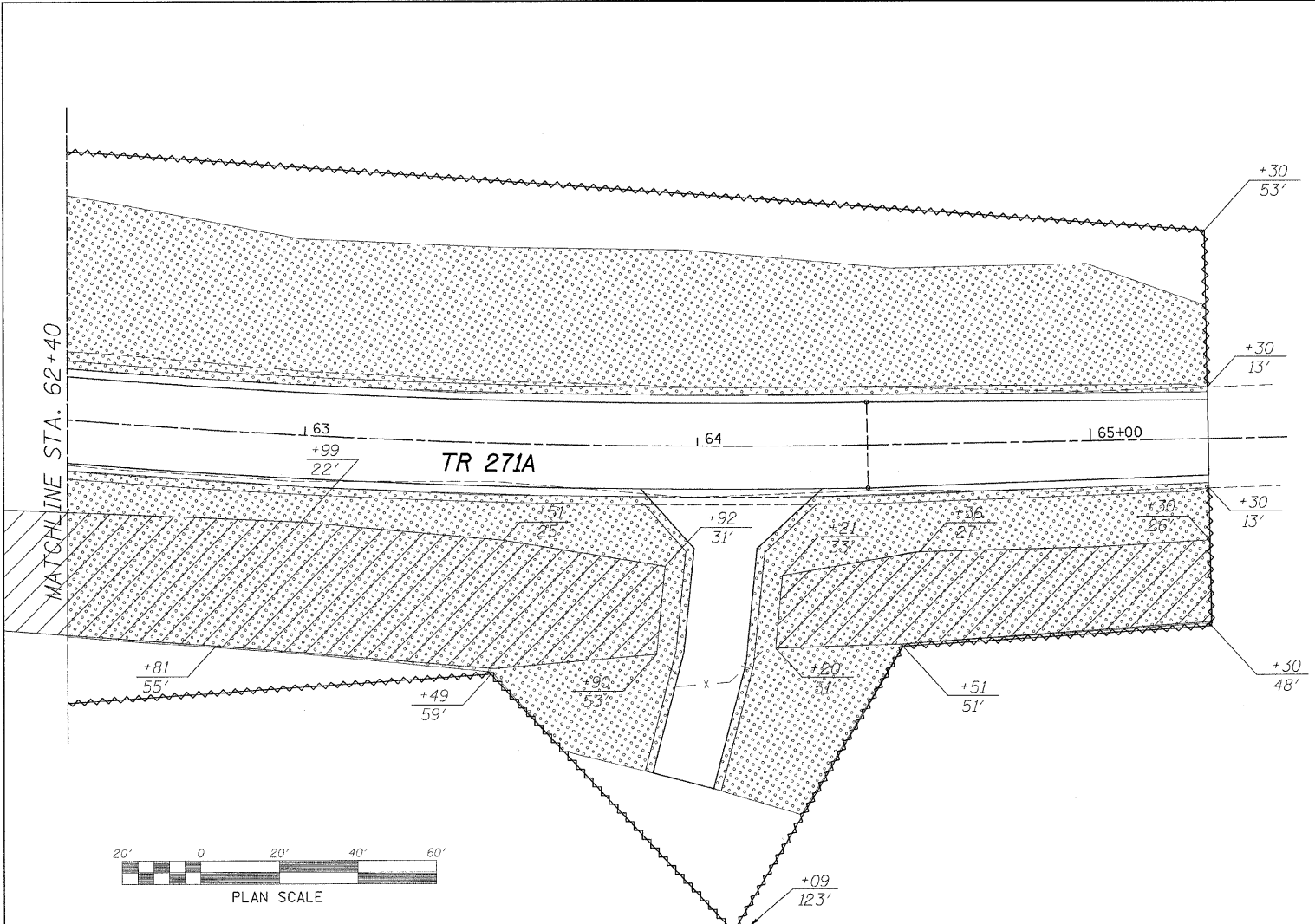

LEGEND	
	INLET PROTECTION
	PERIMETER EROSION BARRIER
	DRAINAGE FLOW
	TEMPORARY DITCH CHECK
	STONE DUMPED RIPRAP, CLASS B3
	TREE REMOVAL, ACRES
	EROSION CONTROL BLANKET OVER SEEDING, CLASS 3 (SPECIAL)

FILE NAME: e:\studs\1061905Bureau\County\Design\swppp17271.dgn

WILLET, HOFMANN & ASSOCIATES, INC.
CONSULTING ENGINEERS
 809 East Second Street Dixon, IL 61021
 Phone 815.284.3381 Fax 815.284.3385
 Design Firm # 184-00218
 www.willettthofmann.com

USER NAME =	DESIGNED -	REVISED -
PLOT SCALE =	DRAWN -	REVISED -
PLOT DATE =	CHECKED -	REVISED -
	DATE -	REVISED -

BUREAU COUNTY
BRIDGE REPLACEMENT
FAS 188 (C.H. 8) OVER IAIS RAILROAD & THE HENNEPIN CANAL

SWPPP - TR 271A

F.A.S.	SECTION	COUNTY	TOTAL SHEETS	SHEET NO.
188	05-00195-00-BR	BUREAU	127	112
STA. 62+40 TO STA. 65+50			CONTRACT NO. 87380	
FED. ROAD DIST. NO. 7 ILLINOIS FED. AID PROJECT BR5-0188(118)				