

SIZE	MIN. LAP
#4	2'-7"
#5	3'-3"
#6	3'-10"
#7	5'-2"
#8	6'-9"
#9	8'-7"

BILL OF MATERIAL

Bar	No.	Size	Length	Shape
a(E)	246	#5	23'-8"	—
b(E)	156	#5	41'-3"	—
b ₁ (E)	140	#5	31'-9"	—
b ₂ (E)	120	#6	6'-0"	—
c(E)	236	#4	6'-1"	U
x(E)	50	#5	3'-3"	⌋
x ₁ (E)	50	#5	4'-0"	⌋
Concrete Superstructure			Cu. Yd.	51.5
Bridge Deck Grooving			Sq. Yd.	271
Protective Coat			Sq. Yd.	332
Reinforcement Bars, Epoxy Coated			Pound	19,840

NOTES:
 Bars indicated thus 32 x 3-#5 etc. indicates 32 lines of bars with 3 lengths per line.
 *See Structural Sheet 7C of 13C for details.

SUPERSTRUCTURE DETAILS
 T.R. 271A OVER WEST BUREAU CREEK
 STATION 60+00
 S.N. 006-4376
 WHA #1066D05

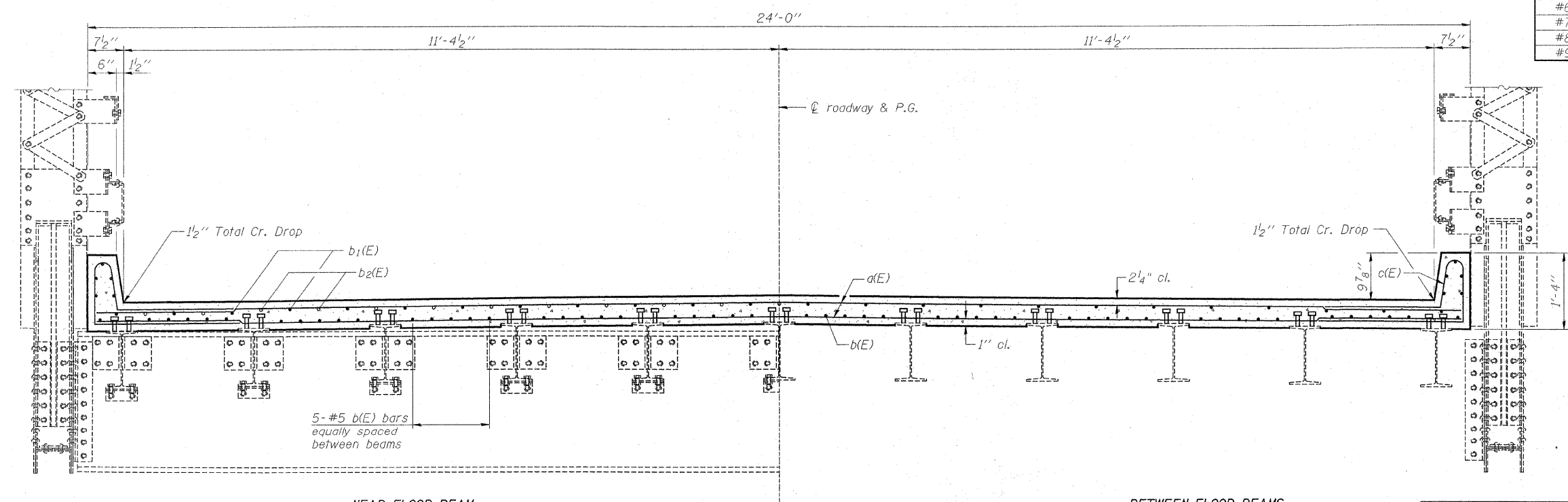

CROSS SECTION
 (Looking East)

STRUCTURAL SHEET NO. 2C OF 13C SHEETS	F.A.S. RTE.	SECTION	COUNTY	TOTAL SHEETS	SHEET NO.
	188	05-00195-00-BR	BUREAU	127	115
	CONTRACT NO. 87380				
FED. ROAD DIST. NO. 7 ILLINOIS FED. AID PROJECT BRS-0188(118)					

FILE NAME = s:\Struct\188009BureauCreek\Drawings\Historical\Structure\Superstructure.dgn