

**SECTION C-C**

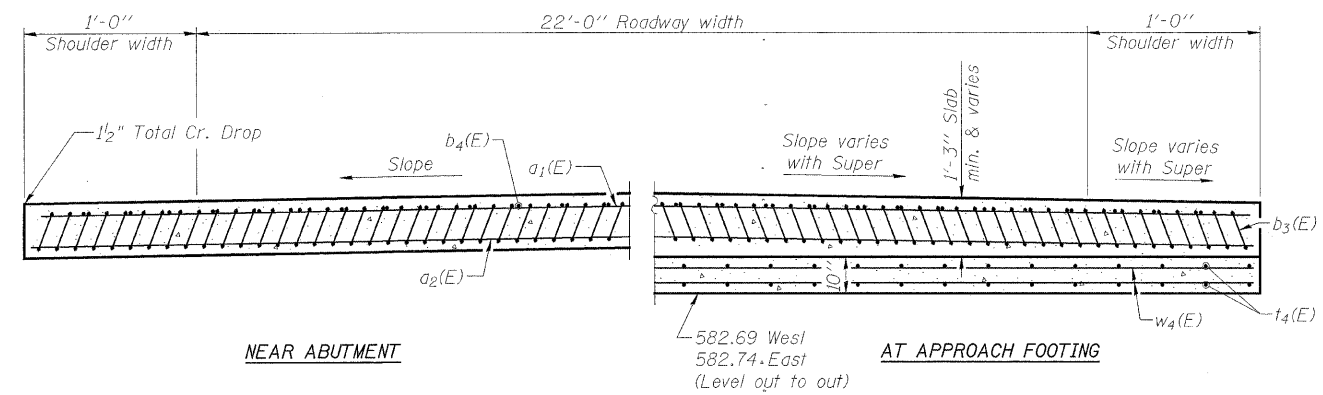

**SECTION D-D**  
(See Plan for dimensions not shown)

\* Tilt #9 b<sub>3</sub>(E) bars as required to maintain clearance.  
\*\* Cost included with Concrete Superstructure.

**TWO APPROACHES  
BILL OF MATERIAL**

| Bar                              | No. | Size | Length  | Shape  |
|----------------------------------|-----|------|---------|--------|
| a <sub>1</sub> (E)               | 50  | #4   | 23'-8"  | —      |
| a <sub>2</sub> (E)               | 92  | #5   | 23'-8"  | —      |
| b <sub>3</sub> (E)               | 116 | #9   | 29'-9"  | ⌋      |
| b <sub>4</sub> (E)               | 40  | #4   | 29'-8"  | —      |
| t <sub>4</sub> (E)               | 100 | #4   | 9'-8"   | —      |
| w <sub>4</sub> (E)               | 80  | #5   | 23'-8"  | —      |
| x <sub>2</sub> (E)               | 12  | #4   | 2'-9"   | └      |
| Concrete Structures              |     |      | Cu. Yd. | 14.8   |
| Concrete Superstructure          |     |      | Cu. Yd. | 69.7   |
| Bridge Deck Grooving             |     |      | Sq. Yd. | 147    |
| Protective Coat                  |     |      | Sq. Yd. | 161    |
| Reinforcement Bars, Epoxy Coated |     |      | Pound   | 18,230 |

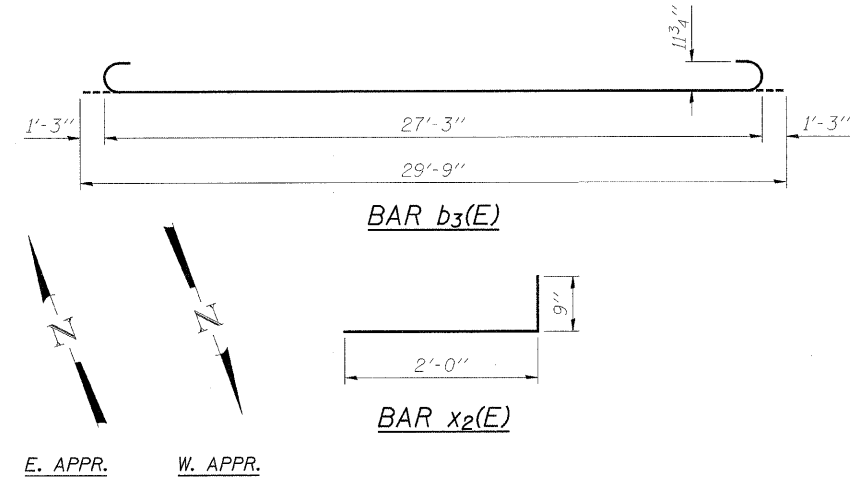

E. APPR.      W. APPR.

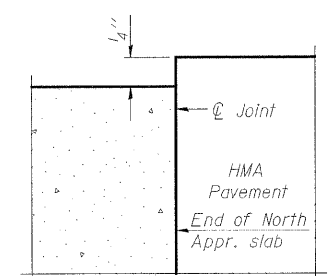

**FLEXIBLE PAVEMENT  
DETAIL A**

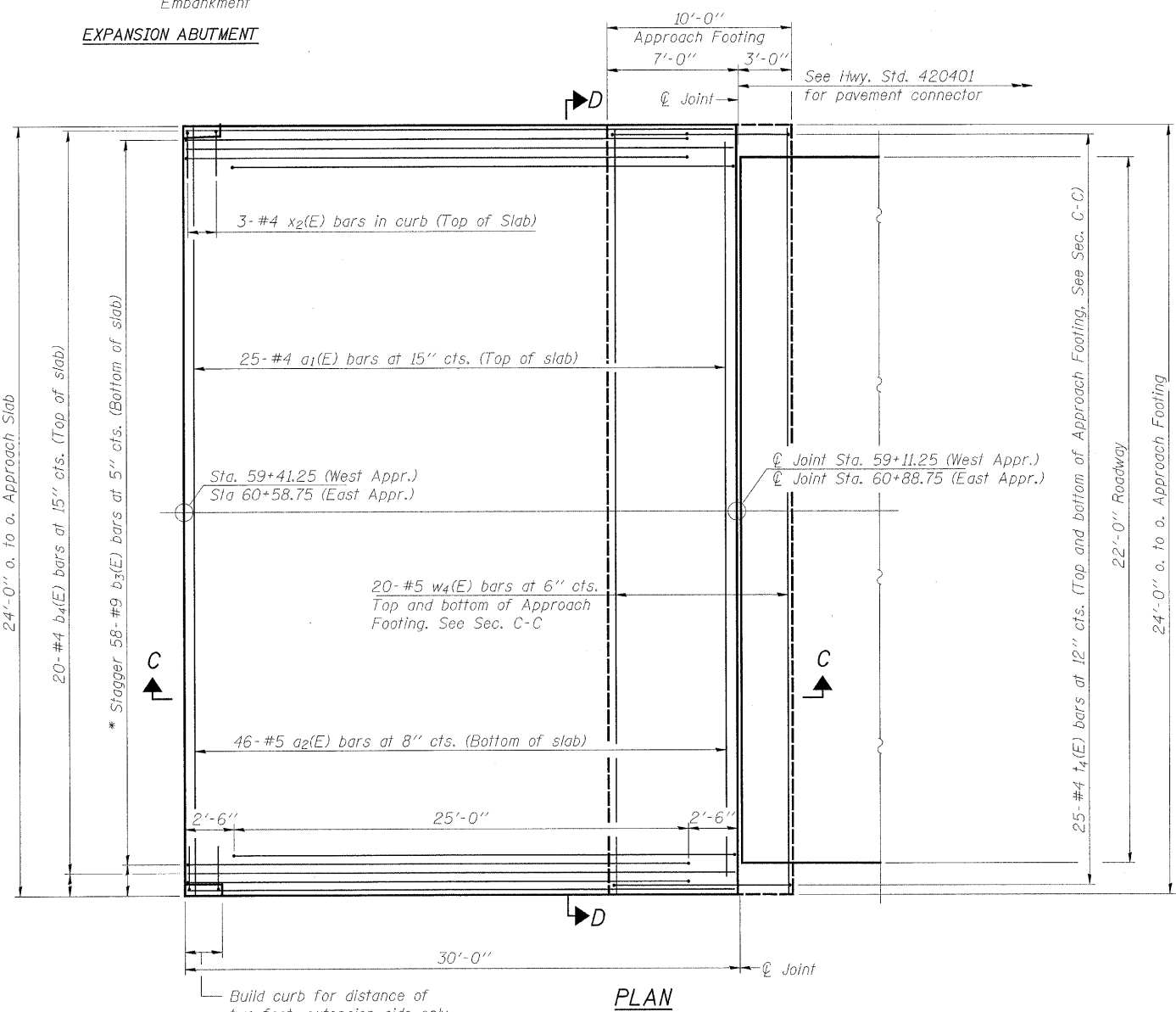

**PLAN**

Build curb for distance of two feet, extension side only. match bridge curb dimensions. See Structural Sheet 2C of 13C.

**NOTES:**

- a<sub>1</sub>(E), a<sub>2</sub>(E), and w<sub>4</sub>(E) bar spacings measured along  $\phi$  Rdwy.
- Approach slab shall be paid for as Concrete Superstructure.
- Approach footing concrete shall be paid for as Concrete Structures.
- Reinforcement shall be paid for as Reinforcement Bars, Epoxy Coated.
- For v (E) bar details, see sheet 10C of 13C.
- The approach footing maximum applied service bearing pressure (Q<sub>max</sub>) = 2.0 ksf.
- Cost of excavation for approach footing included with Concrete Structures.
- For Porous Granular Embankment and drainage treatment details, see sheet 9C of 13C.

**BRIDGE APPROACH SLAB DETAILS  
T.R. 271A OVER WEST BUREAU CREEK  
STATION 60+00  
S.N. 006-4376  
WHA #1066D05**

|   |                    |                |        |              |           |
|---|--------------------|----------------|--------|--------------|-----------|
| STRUCTURAL SHEET NO. 8C OF 13C SHEETS                         | F.A.S. RTE.        | SECTION        | COUNTY | TOTAL SHEETS | SHEET NO. |
|   | 188                | 05-00195-00-BR | BUREAU | 127          | 121       |
|   | CONTRACT NO. 87380 |                |        |              |           |
| FED. ROAD DIST. NO. 7 ILLINOIS FED. AID PROJECT BRS-0188(118) |                    |                |        |              |           |

FILE NAME = p:\Sernect\1066D05\Bureau\Drawings\Historical\Structure\Approach\Slab\dgn